

DASH NO.	M CODE	MADE FROM
----------	--------	-----------

GSD

M39012/93-3002

REVISIONS	
ISSUE	CHANGES
0	ER 32927 JCA 03/04/91
1	CN 34192 E KH 10/19/92
2	CN 35187 D KH 11/29/93
3	CN 36001 E ME 01/16/95
4	CN 38219 C BDH 02/07/01

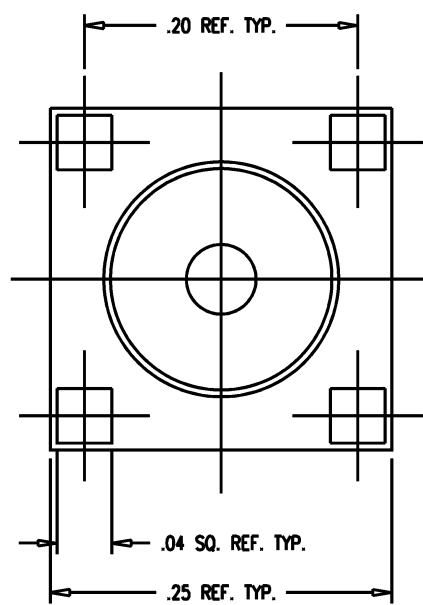
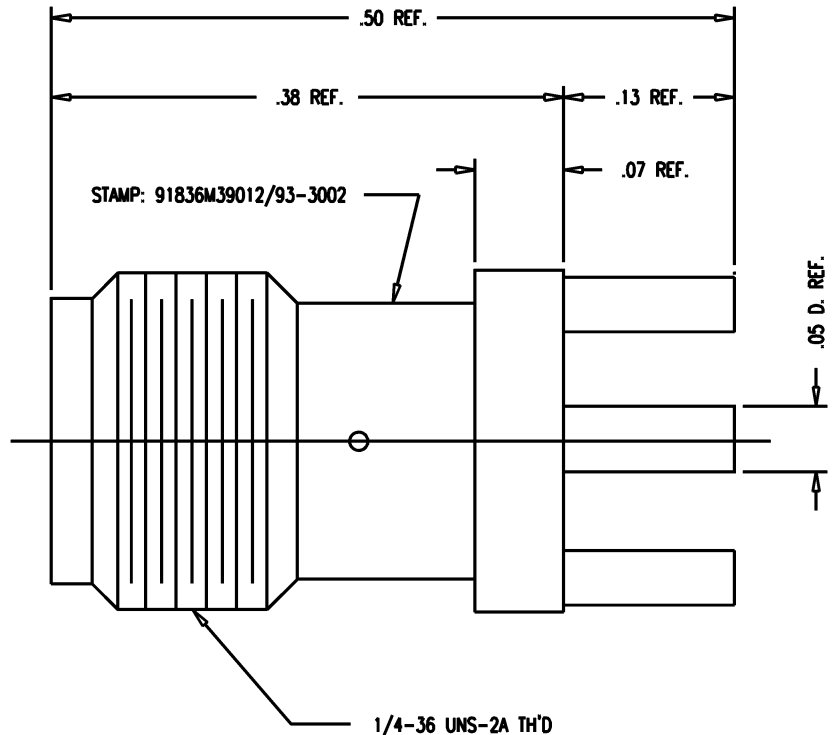

NOTES:

- MARK PACKAGE: 91836 M39012/93-3002
877-92-1 YRWK (DATE CODE)
- INTERFACE PER MIL-STD-348 FIG., 310-2.
- MATERIALS:
INSULATOR-TEFLON, ASTM-D-1457
CENTER CONTACT F-BER. COP., ASTM-B-196
BODY-STAINLESS STEEL, 303
- FINISHES:
ALL METAL PARTS-HARD GOLD PLATE PER MIL-G-45204
- ELECTRICAL CHARACTERISTICS:
NOMINAL IMPEDANCE-50 OHMS

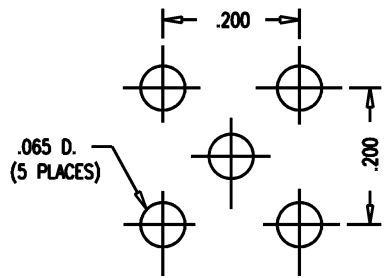

MOUNTING HOLES

GSD

SCALE 10:1	
APPROX SURFACE AREA	
877-92-1	
USED ON	
REF:	
RECEPTACLE, P.C.B., SMA	
DRAWN JCA	DATE 03/04/91
DESIGN GA	DATE 03/05/91
APPR.	DATE

KINGS
ELECTRONICS CO., INC.
ROCK HILL, SOUTH CAROLINA 29730

M39012/93-3002

UNLESS OTHERWISE SPECIFIED	2. REMOVE ALL BURRS, BREAK SHARP EDGES .005 MAX.	7. ALL LEAD THREADS TO BE CHAMFERED 45° TO ROOT DIAMETER.
1. TOLERANCES: FRACTIONS & 2 PLACE DECIMALS ± .010	3. NO FILLETS PERMITTED.	* CRITICAL DIMENSIONS
3 PLACE DECIMALS ± .004 ANGLES ± 1°	4. SURFACE ROUGHNESS 63 MICRONS RMS MAX.	
CONCENTRICITY OF ANY 2 DIAMETERS MAY NOT EXCEED HALF THE SUM OF THEIR TOLERANCES.	5. ALL DIMENSIONS PRIOR TO PLATING.	
	6. ALL PLATING IN ACCORDANCE WITH KER 10004.	