

DASH NO.	M CODE	MADE FROM
----------	--------	-----------

GSD

875-57-1

REVISIONS	
ISSUE	CHANGES
0	ER 32216 JCA 11/08/91
1	CN 36496 C ME 08/04/95

JCA2202

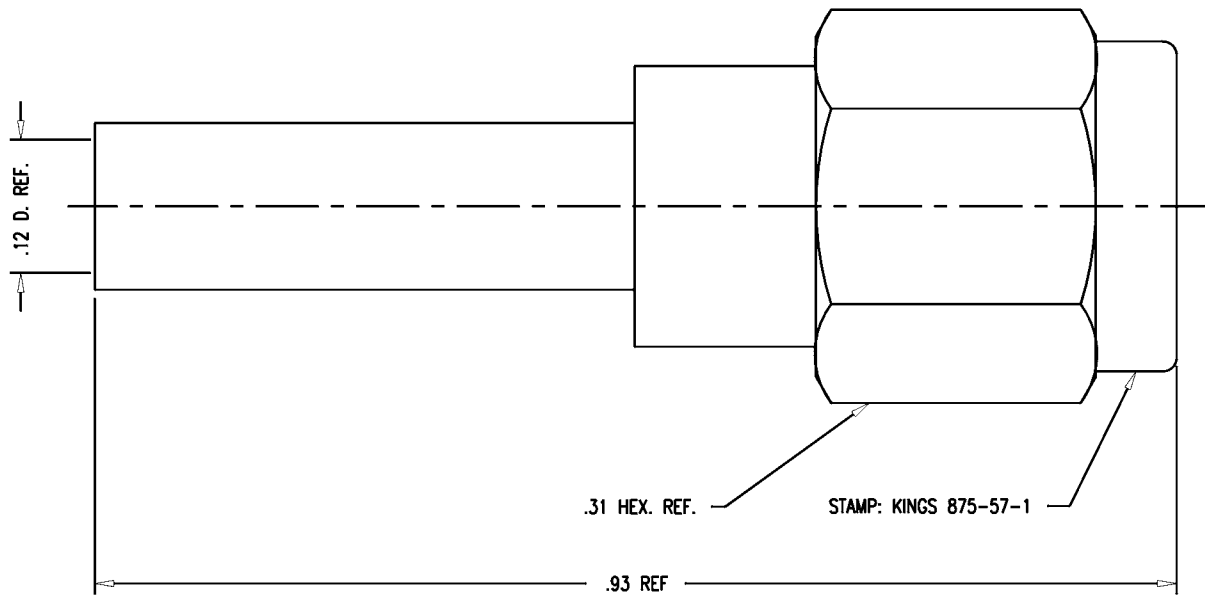

- NOTES:**
- FOR USE WITH M17/119-RG174 & M17/113-RG316 CABLE.
 - FOR CABLING INSTRUCTIONS SEE CP-439.
 - FOR CABLE TRIMMING USE KTJ-82 & KTD-121.
 - FOR CRIMPING USE DIE KTH-2021.
 - INTERFACE PER MIL-STD-348, FIG. 310.1.
 - MATERIALS:
 - INSULATOR: TEFLON, ASTM-D-4894
 - GASKET: SILICONE RUBBER, ZZ-R-765
 - CENTER CONTACT: BRASS, ASTM-B16
 - C-RING: BER. COPPER, ASTM-B-196
 - K-GRIP SLEEVE: COM'L BRONZE, ASTM-B135
 - ALL OTHER METAL PARTS: STAINLESS STEEL 303
 - FINISHES:
 - ALL METAL PARTS: HARD GOLD PLATE, PER MIL-G-45204
 - ELECTRICAL CHARACTERISTICS:
 - NOMINAL IMPEDANCE: 50 Ω
 - WORKING VOLTAGE: 500 VOLTS RMS
 - FREQUENCY RANGE: DC TO 12.4 GHz

SCALE 8:1	
APPROX SURFACE AREA	
USED ON	
REF:	
PLUG, SMA	
DRAWN JCA	DATE 11/08/91
DESIGN LJ	DATE 11/11/91
APPR.	DATE
KINGS ELECTRONICS CO., INC. TUCKAHOE, NEW YORK 10707	
875-57-1	

GSD