

EAO – Your Expert Partner for Human Machine Interfaces

82-5154.12A4 - Illuminated pushbutton 19 mm stainless-steel, momentary

82-5154.12A4 - Illuminated pushbutton 19 mm stainless-steel, momentary



Attention: The preview is based on a sample product. This can differ from your current configuration.

Mounting

Mounting cut-out	Ø 19 mm
Design	flush

Front

Front dimension	Ø 22 mm
Front shape	round
Front ring shape	flush
Front bezel material	Stainless steel

Other Attributes

Operating voltage	24 V VDC
Weight	0,018 kg
Operation current	7 mA

Operating-/Indication part

Lens optics	opaque
Lens material	Stainless steel
Lens profile	flat
Lens illumination	illuminative
Lens colour	Stainless steel

IP-Rating

Front protection	IP 65, IP 67
------------------	--------------

Connection Method

Terminal	Screw terminal
----------	----------------

Actuator

Switching action	Momentary
------------------	-----------

Switching element

Switching current	3 A
Contact material	gold-plated silver
Contacts	1 C
Switching system	Snap-action switching element
Switching voltage	240 V VAC/DC

Illumination

Illumination	Dot with LED bi-colour red/green
--------------	----------------------------------

Function

Illuminated pushbutton

EAO – Your Expert Partner for Human Machine Interfaces

82-5154.12A4 - Illuminated pushbutton 19 mm stainless-steel, momentary

Dimensions

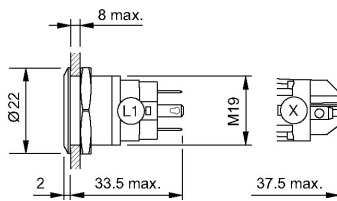

Mounting cut-outs

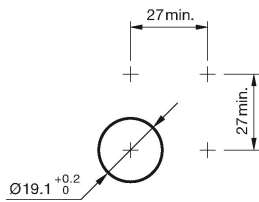

Wiring diagram

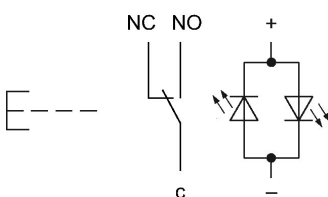

Component layout

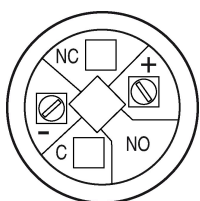

Legend

Switching action: B = Momentary

Contacts: C = Changeover