



MW Industries, Inc.

- [Home](#)
- [Products](#)
- [Online Catalog](#)
- [Request Quote](#)
- [Order Online](#)
- [Check Stock](#)
- [Request Print Catalog](#)
- [Request Samples](#)
- [Engineering Data](#)
- [Distributors](#)
- [Capabilities Brochure](#)

Home > [1 in. Leg Height 1/4 Round Internal Thread Handles](#)

1 IN. LEG HEIGHT 1/4 ROUND INTERNAL THREAD HANDLES

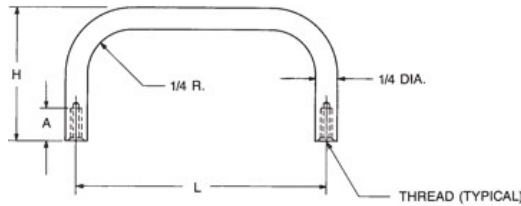

[Home](#) [Previous](#)

Ordering Code			
xxxx	xxx	x	x
Length & Height	Thread	Material	Finish

PART: 8112 832 SS 26

Red ?'s show missing selections. [Help](#)

- [Material Specifications](#)
- [Ordering non-standard items](#)
- [Download a Drawing](#)

CALL NOW:
203 888-2133

Add to Cart

Qty1 *

Qty2

Qty3

	No.	1/32	1/32
<input type="radio"/>	8102	1-1/8	1
<input type="radio"/>	8103	1-1/4	1
<input type="radio"/>	8104	1-1/2	1
<input type="radio"/>	8105	1-3/4	1
<input type="radio"/>	8106	2	1
<input type="radio"/>	8107	2-1/4	1
<input type="radio"/>	8108	2-1/2	1
<input type="radio"/>	8109	2-3/4	1
<input type="radio"/>	8110	3	1
<input type="radio"/>	8111	4	1
<input checked="" type="radio"/>	8112	5	1

Thread *

Select	Code	Thread	A
<input type="radio"/>	632	6-32	5/16-3/8
<input checked="" type="radio"/>	832	8-32	7/16-9/16

Material *

Select	Code	Material	RoHS
<input type="radio"/>	A	Aluminum	YES
<input type="radio"/>	B	Brass	YES
<input checked="" type="radio"/>	SS	Stainless Steel	YES
<input type="radio"/>	S	Steel	YES



1 in. Leg Height 1/4 Round Internal Thread Handles

<input type="radio"/>	24-Black anodize
<input type="radio"/>	25-Black oxide brass
<input checked="" type="radio"/>	26-Black oxide SS
<input type="radio"/>	28-Zinc yellow chromate
<input type="radio"/>	29-Brushed
<input type="radio"/>	34-Satin clear anodize
<input type="radio"/>	35-Satin black anodize
<input type="radio"/>	40-Semi-frost clear anodize
<input type="radio"/>	41-Semi-frost black anodize
<input type="radio"/>	43-Blue zinc
<input type="radio"/>	45-Passivate QQ-P-35C Type VI
<input type="radio"/>	46-Passivate ASTM A 967 Nitric 1