



# SCREWDRIVERS/BITS



[www.eclipsetools.com](http://www.eclipsetools.com)

## Screwdriver-Rubber Grip

- These Cushion-Grip screwdrivers offer excellent comfort and durability. Our grips are designed to allow repetitive use with little or no fatigue.
- The Cushion-Grip is fitted onto a hard plastic core for strength.
- The rubberized outer grip feels good in the hand, yet still transfers torque effectively.
- The screwdriver blade portion that is inside the hard plastic core has protruding tabs formed on it to maintain a secure fit to the handle and superior torque performance.

### Flat Blade



| Description                               | Part No. |
|---|----------|
| Screwdriver - Rubber Grip (13/64" x 3")   | 800-097  |
| Screwdriver - Rubber Grip (13/64" x 4")   | 800-099  |
| Screwdriver - Rubber Grip (13/64" x 6")   | 800-095  |
| Screwdriver - Rubber Grip (1/4" x 1-1/2") | 800-101  |
| Screwdriver - Rubber Grip (1/4" x 4")     | 800-093  |

### Phillips

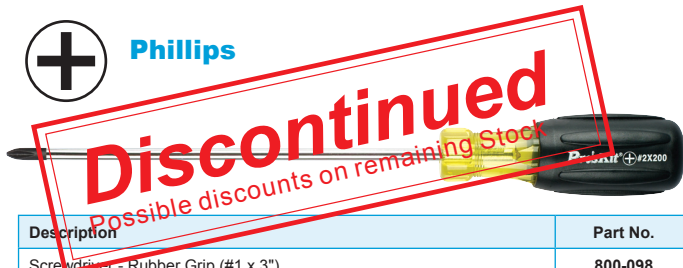

| Description                             | Part No. |
|---|----------|
| Screwdriver - Rubber Grip (#1 x 3")     | 800-098  |
| Screwdriver - Rubber Grip (#1 x 4")     | 800-100  |
| Screwdriver - Rubber Grip (#2 x 1-1/2") | 800-102  |
| Screwdriver - Rubber Grip (#2 x 4")     | 800-094  |
| Screwdriver - Rubber Grip (#2 x 6")     | 800-103  |
| Screwdriver - Rubber Grip (#2 x 8")     | 800-096  |
| Screwdriver - Rubber Grip (#2 x 10")    | 800-104  |

## Screwdriver-Rubber Grip-Offset Speed Driver



| Description   | Part No. |
|---|----------|
| Offset Screwdriver (Phillips: #1) W/Cushion Grip    | 800-089  |
| Offset Screwdriver (Slotted: 13/64") W/Cushion Grip | 800-090  |



### Robertson (Square) Tip



| Description                         | Part No. |
|-------------------------------------|----------|
| Screwdriver - Rubber Grip (S0 x 4") | 800-105  |
| Screwdriver - Rubber Grip (S1 x 4") | 800-106  |
| Screwdriver - Rubber Grip (S2 x 4") | 800-107  |
| Screwdriver - Rubber Grip (S3 x 4") | 800-108  |

## Screwdriver-Rubber Grip



### Star Tip

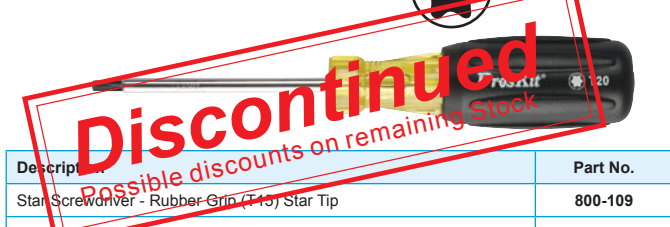

| Description                                   | Part No. |
|---|----------|
| Star Screwdriver - Rubber Grip (T15) Star Tip | 800-109  |
| Star Screwdriver - Rubber Grip (T20) Star Tip | 800-110  |
| Star Screwdriver - Rubber Grip (T25) Star Tip | 800-111  |
| Star Screwdriver - Rubber Grip (T27) Star Tip | 800-112  |
| Star Screwdriver - Rubber Grip (T30) Star Tip | 800-113  |



### Hollow Shaft Nutdrivers



### Precision-machined socket

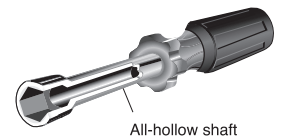

All-hollow shaft

### Now available separately

| Description                     | Part No. |
|---------------------------------|----------|
| 7 Pc Set with Roll-up Pouch     | 800-088  |
| Hollow-Shaft Nutdriver (3/16")  | 902-231  |
| Hollow-Shaft Nutdriver (1/4")   | 902-232  |
| Hollow-Shaft Nutdriver (5/16")  | 902-233  |
| Hollow-Shaft Nutdriver (11/32") | 902-234  |
| Hollow-Shaft Nutdriver (3/8")   | 902-235  |
| Hollow-Shaft Nutdriver (7/16")  | 902-236  |
| Hollow-Shaft Nutdriver (1/2")   | 902-237  |

## Screwdriver

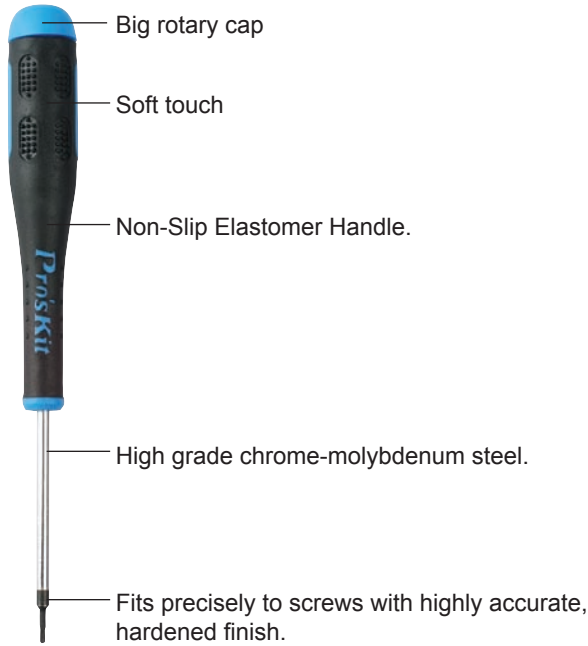

### Screwdriver



| Description | Tip   | Working length | Part No. |
|-------------|-------|----------------|----------|
| Screwdriver | # 000 | ⊕ 2"           | 800-131  |
| Screwdriver | # 00  | ⊕ 2"           | 800-132  |
| Screwdriver | # 0   | ⊕ 3"           | 800-133  |
| Screwdriver | # 1   | ⊕ 6"           | 800-134  |



### Screwdriver



| Description | Tip | Working length | Part No. |
|-------------|-----|----------------|----------|
| Screwdriver | 1.0 | ⊖ 2"           | 800-135  |
| Screwdriver | 1.6 | ⊖ 2"           | 800-136  |
| Screwdriver | 2.0 | ⊖ 2"           | 800-137  |
| Screwdriver | 2.4 | ⊖ 3"           | 800-138  |
| Screwdriver | 3.0 | ⊖ 4"           | 800-139  |

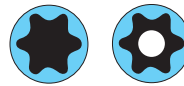

## Screwdriver



| Description | Tip  | Working length | Part No. |
|-------------|------|----------------|----------|
| Screwdriver | T10H | ⊕ 2"           | 800-140  |
| Screwdriver | T3   | ⊕ 2"           | 800-141  |
| Screwdriver | T4   | ⊕ 2"           | 800-142  |
| Screwdriver | T5H  | ⊕ 2"           | 800-143  |
| Screwdriver | T6H  | ⊕ 2"           | 800-144  |
| Screwdriver | T7H  | ⊕ 2"           | 800-145  |
| Screwdriver | T8H  | ⊕ 2"           | 800-146  |
| Screwdriver | T9H  | ⊕ 2"           | 800-147  |

## Screwdriver set



- ⊕ 2.0 x .8"
- ⊕ 2.4 x .8"
- ⊕ 3.0 x .8"
- ⊕ #00 x .8"
- ⊕ #0 x .8"
- ⊕ #1 x .8"

| Description     | Part No. |
|-----------------|----------|
| Screwdriver set | 800-149  |

## Screwdriver set



- ⊕ T5H x .8"
- ⊕ T6H x .8"
- ⊕ T7H x .8"
- ⊕ T10H x .8"
- ⊕ T15H x .8"
- ⊕ T20H x .8"

| Description     | Part No. |
|-----------------|----------|
| Screwdriver set | 800-150  |

## Ceramic Driver

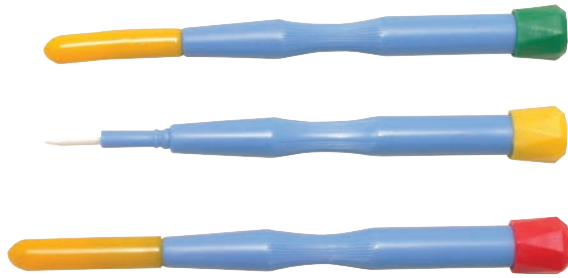

| Description                   | Part No. |
|-------------------------------|----------|
| ⊖ 0.015" x 0.035" (0.4x0.9mm) | 800-114  |
| ⊖ 0.015" x 0.047" (0.4x1.2mm) | 800-115  |
| ⊖ 0.015" x 0.055" (0.4x1.4mm) | 800-116  |
| ⊖ 0.015" x 0.070" (0.4x1.8mm) | 800-117  |
| ⊖ 0.015" x 0.078" (0.4x2.0mm) | 800-118  |
| ⊖ 0.015" x 0.094" (0.4x2.4mm) | 800-119  |
| ⊖ 0.027" x 0.094" (0.7x2.4mm) | 800-120  |
| ⊕ PH0                         | 800-121  |
| ⊕ PH1.7                       | 800-122  |

## ESD Precision Screwdriver

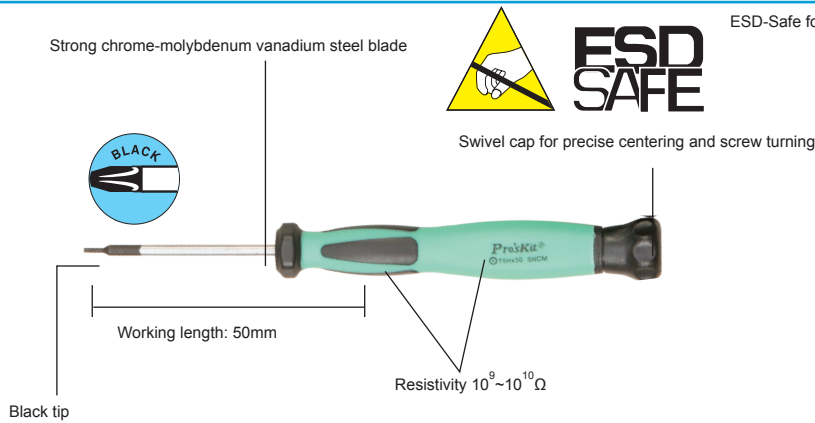

ESD-Safe for maximum protection of static electricity sensitive components.



| Model No.  | Spec. |
|------------|-------|
| SD-083-P2  | ⊕ #00 |
| SD-083-P3  | ⊕ #0  |
| SD-083-P4  | ⊕ #1  |
| SD-083-S3  | ⊖ 2.0 |
| SD-083-S4  | ⊖ 2.4 |
| SD-083-S5  | ⊖ 3.0 |
| SD-083-T4  | ⊕ T4  |
| SD-083-T5H | ⊕ T5H |
| SD-083-T6H | ⊕ T6H |

## ESD Precision Screwdriver Set



| Contents   |       |
|------------|-------|
| SD-083-P2  | ⊕ #00 |
| SD-083-P3  | ⊕ #0  |
| SD-083-P4  | ⊕ #1  |
| SD-083-S3  | ⊖ 2.0 |
| SD-083-S4  | ⊖ 2.4 |
| SD-083-S5  | ⊖ 3.0 |
| SD-083-T4  | ⊕ T4  |
| SD-083-T5H | ⊕ T5H |
| SD-083-T6H | ⊕ T6H |

| Description                   | Part No. |
|-------------------------------|----------|
| ESD Precision Screwdriver Set | SD-0839  |



## Soft-Handled Screwdrivers

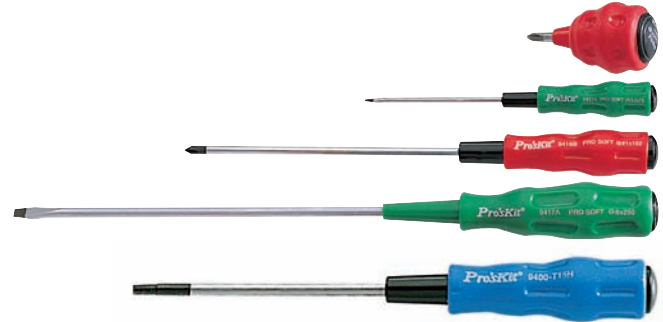
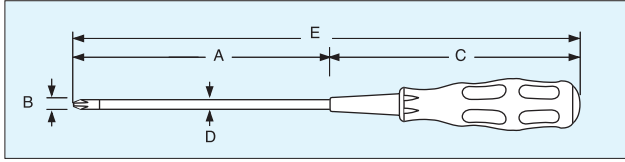

- Rubber grip
- Ergonomic design
- Chrome vanadium blades
- Hardened, tempered, Black-oxide tip

## Display Stand (Distributors only)



- For distributors
- Each size holds 50 screwdrivers
- Great for displaying our product

| Description | Part No. |
|-------------|----------|
| Small Stand | 900-031  |
| Large Stand | 900-014  |

## 11 Pc Star Screwdriver Set



- T6 thru T40
- Same handle as our popular screwdriver line
- Convenient plastic carrying case

| Description                | Part No. |
|----------------------------|----------|
| 11 PC Star Screwdriver Set | 800-030  |

| Description (Inch) |     |      |     |      |      | Part No. |
|--------------------|-----|------|-----|------|------|----------|
| A                  | Tip | B    | C   | D    | E    |          |
| 3                  | ⊖   | 1/8  | 3.3 | 1/8  | 6.3  | 800-001  |
| 3                  | ⊕   | #0   | 3.3 | 1/8  | 6.3  | 800-002  |
| 4                  | ⊖   | 1/8  | 3.3 | 1/8  | 7.3  | 800-010  |
| 4                  | ⊕   | #0   | 3.3 | 1/8  | 7.3  | 800-011  |
| 6                  | ⊖   | 1/8  | 3.3 | 1/8  | 9.3  | 800-012  |
| 6                  | ⊕   | #0   | 3.3 | 1/8  | 9.3  | 800-013  |
| 3                  | ⊖   | 3/16 | 4.3 | 3/16 | 7.3  | 800-003  |
| 3                  | ⊕   | #1   | 4.3 | 3/16 | 7.3  | 800-004  |
| 4                  | ⊖   | 3/16 | 4.3 | 3/16 | 8.3  | 800-014  |
| 4                  | ⊕   | #1   | 4.3 | 3/16 | 8.3  | 800-015  |
| 6                  | ⊖   | 3/16 | 4.3 | 3/16 | 10.3 | 800-016  |
| 6                  | ⊕   | #1   | 4.3 | 3/16 | 10.3 | 800-017  |
| 8                  | ⊖   | 3/16 | 4.3 | 3/16 | 12.3 | 800-018  |
| 8                  | ⊕   | #1   | 4.3 | 3/16 | 12.3 | 800-019  |
| 10                 | ⊖   | 3/16 | 4.3 | 3/16 | 14.3 | 800-020  |
| 10                 | ⊕   | #1   | 4.3 | 3/16 | 14.3 | 800-021  |
| 4                  | ⊖   | 1/4  | 4.3 | 1/4  | 8.3  | 800-005  |
| 4                  | ⊕   | #2   | 4.3 | 1/4  | 8.3  | 800-006  |
| 6                  | ⊖   | 1/4  | 4.3 | 1/4  | 10.3 | 800-022  |
| 6                  | ⊕   | #2   | 4.3 | 1/4  | 10.3 | 800-023  |
| 8                  | ⊖   | 1/4  | 4.3 | 1/4  | 12.3 | 800-024  |
| 8                  | ⊕   | #2   | 4.3 | 1/4  | 12.3 | 800-025  |
| 10                 | ⊖   | 1/4  | 4.3 | 1/4  | 14.3 | 800-026  |
| 10                 | ⊕   | #2   | 4.3 | 1/4  | 14.3 | 800-027  |
| Stubby             | ⊖   | 1/4  | 0.7 | 1/4  | 3    | 800-028  |
| Stubby             | ⊕   | #2   | 0.7 | 1/4  | 3    | 800-029  |
| 2                  | ⊕   | T05  | 3.3 | 5/32 | 5.3  | 800-032  |
| 2                  | ⊕   | T06  | 3.3 | 5/32 | 5.3  | 800-033  |
| 2                  | ⊕   | T07  | 3.3 | 5/32 | 5.3  | 800-034  |
| 3                  | ⊕   | T08  | 3.3 | 5/32 | 6.3  | 800-035  |
| 3                  | ⊕   | T09  | 3.3 | 5/32 | 6.3  | 800-036  |
| 3                  | ⊕   | T10  | 3.3 | 5/32 | 6.3  | 800-037  |
| 3                  | ⊕   | T15  | 3.3 | 5/32 | 6.3  | 800-038  |
| 2                  | ⊕   | T07  | 3.3 | 5/32 | 5.3  | 800-043  |
| 3                  | ⊕   | T08  | 3.3 | 5/32 | 6.3  | 800-044  |
| 3                  | ⊕   | T09  | 3.3 | 5/32 | 6.3  | 800-045  |
| 3                  | ⊕   | T10  | 3.3 | 5/32 | 6.3  | 800-046  |
| 3                  | ⊕   | T15  | 3.3 | 5/32 | 6.3  | 800-047  |
| 2                  | ⊕   | TR1  | 3.3 | 1/8  | 5.3  | 800-123  |

## 2-in-1 Ceramic Drivers



**Discontinued**  
Possible discounts on remaining stock

| Material                                      | Description    |           | Part No. |
|---|----------------|-----------|----------|
|   | Type(Inch)     | OAL(Inch) |          |
| Bit: Zirconia<br>Body: ABS<br>ABS (fireproof) | A  0.4 X 0.035 | 5.39      | 902-191  |
|   | B  0.4 X 0.07  |           |          |
|   | A  0.4 X 0.047 |           | 902-192  |
|   | B  0.4 X 0.078 |           |          |
|   | A  0.4 X 0.047 |           | 902-194  |
|   | B  0.4 X 0.094 |           |          |
|   | A  0.4 X 0.047 |           | 902-195  |
|   | B  PH1.7       |           |          |
|   | A  0.4 X 0.035 |           | 902-196  |
|   | B  PH0         |           |          |

## 5 Pc Reversible Ceramic Driver Set

- Contains: 5 pen style drivers with 2 reversible tips in each
- Straight and phillips tips of various sizes

| Description                        | Part No. |
|------------------------------------|----------|
| 5 Pc Reversible Ceramic Driver Set | 800-062  |

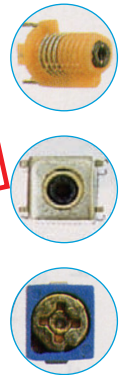

## Pro-soft Screwdriver Set



- 3.2x2-15/16" #0x2-15/16"
- 5x2-15/16" #1x2-15/16"
- 6x3-15/16" #2x3-15/16"

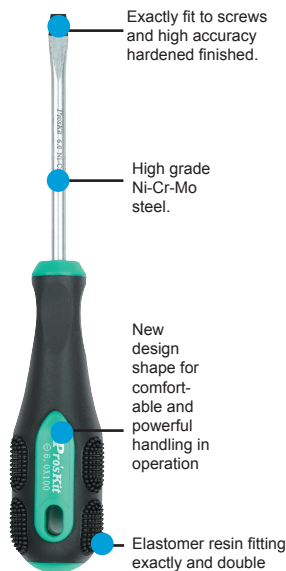

| Description              | Part No. |
|--------------------------|----------|
| Pro-soft Screwdriver Set | 902-096  |

## Pro-soft Screwdriver Set



- T5Hx1-15/16" T9Hx1-15/16"
- T6Hx1-15/16" T10Hx1-15/16"
- T7Hx1-15/16" T15Hx2-15/16"
- T8Hx1-15/16"

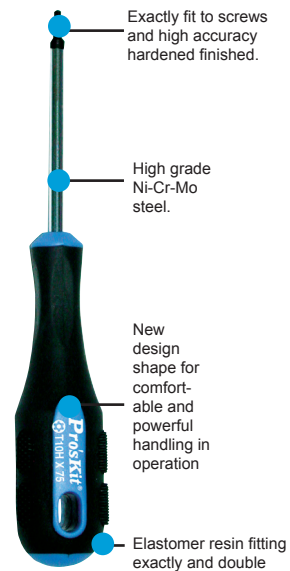

| Description              | Part No. |
|--------------------------|----------|
| Pro-soft Screwdriver Set | 902-097  |

### 6 Pc Precision Screwdriver Set



- #0 X 3", #1 X 4", #1 X 6" Phillips
- .10x3", .12 x 4", .15x6" Flat Blade

| Description                    | Part No. |
|--------------------------------|----------|
| 6 Pc Precision Screwdriver Set | 800-007  |

### 6 Pc Electronic Screwdriver Set

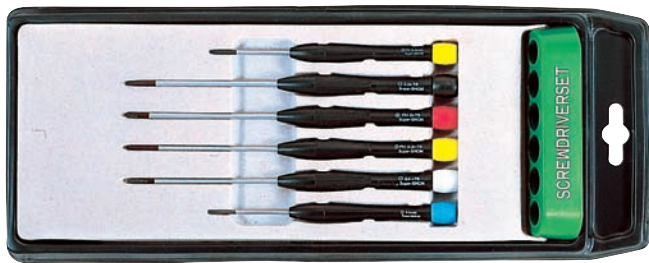

- Includes standup rack
- #0-3 x 1.6", #0-2 x 3", #0 x 3" phillips
- .08 x 1.6", .10 x 3", .12 x 3" straight blade

| Description                     | Part No. |
|---------------------------------|----------|
| 6 Pc Electronic Screwdriver Set | 800-009  |

### 6 Pc Precision Screwdriver Set with Cutter

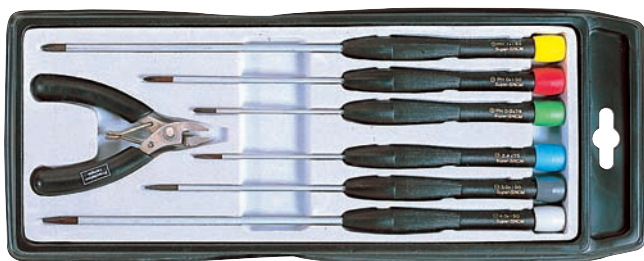

- Micro cutter, spring loaded
- 6 pc Swivel cap Screwdrivers
- .10x3", .12x4", .16x6" Flat
- #00x3", #0x4", #1x6" Phillips

| Description                                | Part No. |
|--|----------|
| 6 Pc Precision Screwdriver Set with Cutter | 800-077  |

### 7 Pc Precision Screwdriver

- 2" blade length
- Cupped Swivel cap
- 4 Flat blade- 1.6, 2.0, 2.4, 3.0mm
- 3 Phillips-#00, #0, #1



| Description                | Part No. |
|----------------------------|----------|
| 7 Pc Precision Screwdriver | 800-075  |

### 15 Pc Precision Screwdriver Set

- Color coded handles for different types
- 4 pc Yellow Hex - 1.5, 2.0, 2.5 & 3.0 mm
- 4 pc Green Slotted - 1.0, 2.0, 3.0 & 3.5 mm
- 4 pc Blue Star Tip - T6, T8, T10 & T15
- 3 Pc Red Phillips - #000, #00 and #0
- Molded Case with fitted pockets for storage



| Description                     | Part No. |
|---------------------------------|----------|
| 15 Pc Precision Screwdriver Set | 800-073  |

### 20 Pc Precision Electronic Screwdriver Set

- One handle with interchangeable bits
- #00 and #0 Phillips, 2.0, 2.5, 3.0, 4.0 mm straight blades
- T-6, 7, 8, 9 & 10 star bit, 1.5, 2.0, 2.5 mm hex
- Pozidrive #0 and #00



| Description                                | Part No. |
|--|----------|
| 20 Pc Precision Electronic Screwdriver Set | 800-060  |

## Folding Security Star Tip



- T9 - T40 security Star Tip
- Chrome plated keys
- Green lacquered case

| Description               | Part No. |
|---------------------------|----------|
| Folding Security Star Tip | 800-052  |

## 7 Pc Folding Hex Set



| Description   | Part No. |
|---|----------|
| 7 Pc Folding Hex Set (1/16", 5/64", 3/32", 1/8", 5/32", 3/16" & 1/4") | 800-066  |
| 7 Pc Folding Hex-Metric (1.5, 2, 2.5, 3, 4, 5, 6mm)                   | 800-124  |

## 9 Pc Ball Point Hex Wrench Set



- 1/16", 5/64", 3/32", 1/8", 5/32", 3/16", 1/4", 5/16" & 3/8"
- Mirror polished
- Long arm type
- Ball point allows for slightly indirect operation

| Description                    | Part No. |
|--------------------------------|----------|
| 9 Pc Ball Point Hex Wrench Set | 800-065  |
| 9 Pc Long Arm Hex - Metric     | 800-125  |

## 30 Pc Hex Key Set



- Inch side .028 to 3/8"
- Metric side 0.9 to 10mm
- 15-Pc inch size
- 15-Pc metric size
- Handy plastic

| Description       | Part No. |
|-------------------|----------|
| 30 Pc Hex Key Set | 900-038  |

## Folding Key Set



- Material: SAE6150 Chrome vanadium steel
- Case: T.P.R. Anti-slip
- Key: Satin finish

| Description   | Part No. |
|---|----------|
| 8 PC Folding Security Star Key Set(T9H, T10H, T15H, T20H, T25H,T27H, T30H, T40H)      | 902-100  |
| 9 PC Folding Hex Key Set(3/16", 7/32", 1/4", 5/32", 9/64", 1/8", 7/64", 3/32", 5/64") | 902-226  |

## 16 Pc Hex Key Wrench Set

Pocket size designed for various uses.

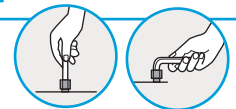

| Part No.      | Tip size | S  | L  |
|---------------|----------|----|----|
| 902-101(inch) | 1/16"    | 14 | 46 |
|               | 5/64"    | 17 | 48 |
|               | 3/32"    | 17 | 52 |
|               | 1/8"     | 20 | 58 |
|               | 5/32"    | 22 | 65 |
|               | 3/16"    | 25 | 72 |
|               | 7/32"    | 28 | 77 |
|               | 1/4"     | 29 | 86 |

### Allen key reference table

| Hex wrench (mm)           | 0.71      | 0.89 | 1.27 | 1.5     | 1.6 | 2    | 2.4 | 2.5 | 3  | 3.2 | 4   | 5   | 6   | 8   | 10  | 12  |
|---------------------------|-----------|------|------|---------|-----|------|-----|-----|----|-----|-----|-----|-----|-----|-----|-----|
| Hexagonal head bolts      |           |      | M1.4 | M1.6/M2 | M2  | M2.5 | M3  | M3  | M4 | M4  | M5  | M6  | M8  | M10 | M12 | M14 |
| Hexagonal head set screws | M1.6/M1.7 | M2   | M2.5 | M3      |     | M4   | M5  | M6  | M8 | M10 | M12 | M16 | M20 | M22 |     |     |

| Description              | Part No. |
|--------------------------|----------|
| 16 PC Hex Key Wrench Set | 902-101  |



### Double-ended Screwdriver



- Pocket clip
- Straight blade on long end
- Phillips on short end

| Description              | Part No. |
|--------------------------|----------|
| Double-ended Screwdriver | 800-040  |

### Pocket Clip Screwdriver

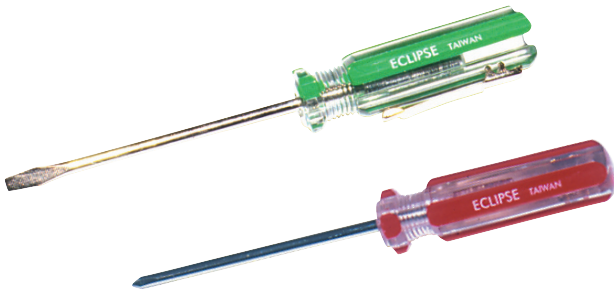

| Description         | Part No. |
|---------------------|----------|
| 1/8" Straight blade | 800-041  |
| #0 Phillips blade   | 800-042  |

### 4-in-1 Screwdriver

- Two Double-Ended, Reversible Tips



| Description                                      | Part No.   |
|--|------------|
| 4-in-1 Screwdriver-Pen Style                     | 800-092    |
| 4-in-1 Screwdriver-Pen Style (50 pc Display Box) | 800-092-50 |

### 6-In-1 Magnetic Quick Change Screwdriver

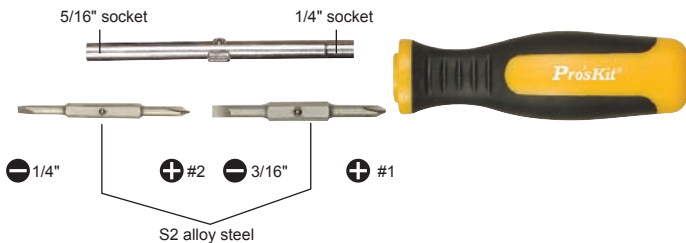

- Industrial quality with maximum versatility. Shock proof acetate handle and S2 alloy steel bit.
- OAL: 7"

| Description                              | Part No. |
|--|----------|
| 6-In-1 Magnetic Quick Change Screwdriver | 800-080  |

### Magnetizer/Demagnetizer



- High-impact casing
- Magnetize/demagnetize screwdrivers/tweezers and other small tools

| Description             | Part No. |
|-------------------------|----------|
| Magnetizer/Demagnetizer | 800-070  |

### Can Wrench



- Popular Telecom tool
- 3/8" and 7/16" hex ends
- Insulated body

| Description | Part No. |
|-------------|----------|
| Can Wrench  | 900-055  |

### CATV Install/Extract Tool



- Installs and removes F-Type connectors in hard to reach places
- Handle contains male F-Type holder

| Description                           | Part No. |
|---------------------------------------|----------|
| CATV Install/Extract Tool 12" (shown) | 800-072  |
| CATV Install/Extract Tool 6"          | 800-079  |

### BNC Connector Insertion / Removal Tool

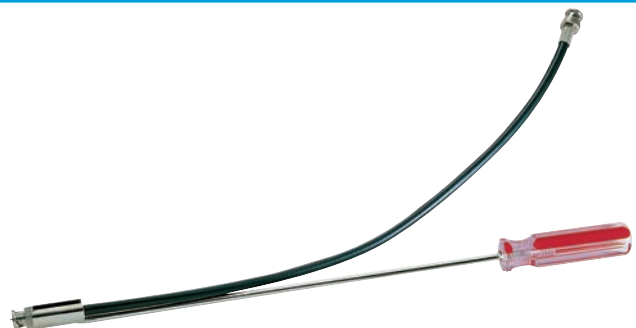

- Provides easy access to difficult to reach, high density connectors

| Description     | Part No. |
|-----------------|----------|
| 12 inch (shown) | 800-050  |
| 8 inch          | 800-049  |

## Double-end Reversible Screwdriver

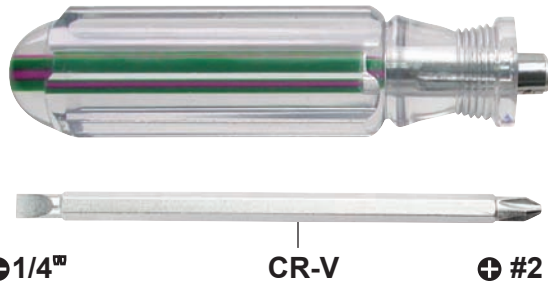

⊖ 1/4" CR-V ⊕ #2

| Description                       | Part No. |
|-----------------------------------|----------|
| Double-end Reversible Screwdriver | 800-148  |

## 1/2" T-handle Hex Hey

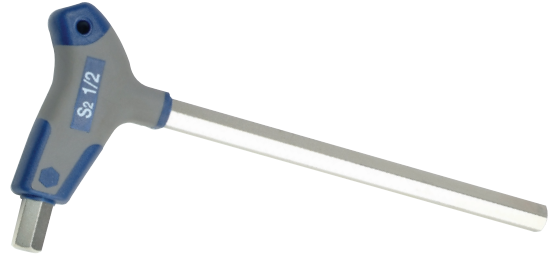

| Description           | Part No. |
|-----------------------|----------|
| 1/2" T-handle Hex Hey | HW-928   |

## 10 Pc T-Handle Hex Key Set

- 3/32", 7/64", 1/8", 9/64", 5/32", 3/16", 7/32", 1/4", 5/16", 3/8"



| Description                | Part No. |
|----------------------------|----------|
| 10 PC T-Handle Hex Key Set | 800-067  |

## 7 Pc T-Handle Hex Hey Set

- Long reach design with T-handle for greater torque and ease of use
- Hardened S2 steel alloy
- Set comes in a durable blow-molded case
- 3/32", 1/8", 5/32", 3/16", 1/4", 5/16" and 3/8"



| Description               | Part No. |
|---------------------------|----------|
| 7 PC T-Handle Hex Hey Set | 800-091  |

## Screwholding Screwdriver Set



- Contents:
- ⊖ 0.2 x 6.1, 0.2 x 5.1, 0.1 x 5.1
- ⊕ #1 0.2 x 5.1, #2 0.2 x 7.1

| Description                    | Part No. |
|--------------------------------|----------|
| Screwholding Screwdriver - Set | 800-151  |

## 3 Pc Anti-Static Alignment Set



- For protection of sensitive components
- Duplex, trimmer and square/hex tool
- Conductive nylon-avoid high voltage

| Description                    | Part No. |
|--------------------------------|----------|
| 3 PC Anti-Static Alignment Set | 800-130  |

**Bit Set**



**Item #: 800-128**

**Item #: 800-127**

| Description                   | Part No. |
|-------------------------------|----------|
| 18 Pc Bit Set (Clips to belt) | 800-127  |
| 20 Pc Bit Set (Clips to belt) | 800-128  |

**20-in-1 Telescoping, Magnetic Screwdriver**



- Self contained Bits and Sockets
- Magnetic telescoping tip to hold bits and screws
- 13 piece bits
- 5 piece sockets

| Description                               | Part No. |
|---|----------|
| 20-in-1 Telescoping, Magnetic Screwdriver | 800-039  |

**Star Wrench Driver Set**

T-8 to T-30 have tamper proof holes for preventing tampering for cordless telephones and wireless equipment.

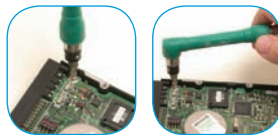

Design with tips at both ends for horizontal and vertical use.



| Description            | Part No. |
|------------------------|----------|
| Star Wrench Driver Set | 902-069  |

**Flexible, Ratcheted Screwdriver Set**

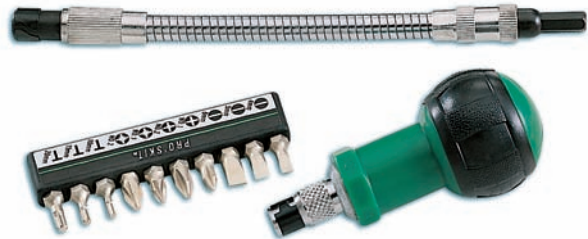

- 7.5" flexible shaft
- Good for getting into hard to reach areas
- 10 pc Bit set

| Description                         | Part No. |
|-------------------------------------|----------|
| Flexible, Ratcheted Screwdriver Set | 800-076  |

**Twin Wrench/Driver Set**



- Tips at both ends for vertical or horizontal use
- T10, T15, T20 Star Tip bits
- 3 Flat blade screwdriver bits
- 4 Phillips screwdriver bits

| Description            | Part No. |
|------------------------|----------|
| Twin Wrench/Driver Set | 800-068  |

**17 Pc Offset Ratchet & Socket Driver Set**



- Offset ratchet handle, reversible
- 6 pc socket set, 1/4" hex drive
- 10 pc 1/4" hex screwdriver bits

| Description                              | Part No. |
|--|----------|
| 17 PC Offset Ratchet & Socket Driver Set | 800-078  |

### 33 Pc Security Bit Pack



- Security bit assortment
- 8 piece security hex
- 12 piece security Torx
- 4 piece security spanner
- 4 piece tri-wing
- 4 piece phillips
- 1/4" magnetic bit holder
- Honeycomb plastic case

| Description   | Part No. |
|---|----------|
| 33 PC Security Bit Pack (S2 grade steel) Superior grade     | 800-048  |
| 33 PC Security Bit Pack (SAE 6150 CR-V steel) Economy grade | 800-048E |

### 22 Pc 1/4" Drive Socket Set



- 1/4" Ratchet
- 9 pc Inch 3/16" to 1/2"
- 9 pc metric 4mm to 12mm
- 3" and 6" extensions
- Nutdriver handle

| Description                 | Part No. |
|-----------------------------|----------|
| 22 Pc 1/4" Drive Socket Set | 900-194  |

### Ratcheted Screwdriver Handle



- Ratcheting
- Swiveling
- Reversible
- Heavy-duty rubber grip
- Your bits can be stored in handle holder

| Description                  | Part No. |
|------------------------------|----------|
| Ratcheted Screwdriver Handle | 800-074  |

### All-In-One Tool Set



- Contains: 9 SAE sockets, 9 metric sockets, 21 screwdriver bits, 5 drill bits, needle-nosed pliers, 6" adjustable wrench, reversible ratchet screwdriver handle, flexible extension, magnetic bit holder, socket adaptor

| Description         | Part No. |
|---------------------|----------|
| All-In-One Tool Set | 800-061  |

### 58-piece Precision Electronic Screwdriver Set

#### Features:

- Material: Chrome-Molybdenum Vanadium Steel Bits 56 pcs, Length: 1.1 inch
- Ergonomic, double molded structure. Non-slip.
- Light weight designed (10 ounces)



| Contents |  |
|----------|--|
| +        | #000, #00, #0, #1  |
| -        | 1.0mm, 1.5mm, 2.0mm, 2.5mm, 3.0mm, 3.5mm, 4.0mm  |
| T        | T5H, T6H, T7H, T8H, T9H, T10H, T15H, T20H  |
| T        | T3, T4, T5, T6, T7, T8, T9, T10, T15   |
| H        | 1.5mm, 2mm, 2.5mm, 3mm, 1/16", 5/64", 3/32"  |
| ●        | 2mm, 2.3mm, 2.5mm  |
| ●        | 0.7mm, 0.9mm, 1.3mm, 1.5mm, 2mm, 2.5mm, 3mm, 4mm, 0.028", 0.035", 0.05", 1/16", 5/64", 3/32" |
| *        | #0, #1   |
| Y        | TR1  |
| ▲        | 2mm  |

| Description                                   | Part No. |
|---|----------|
| 58-piece Precision Electronic Screwdriver Set | 902-219  |

### Ratcheted Screwdriver Set of 10 bits(double ended)

- ⊕ 4
- ⊕ 5
- ⊕ PH.0
- ⊕ PZ.0
- ⊕ PZ.1
- ⊕ PH.2
- ⊕ T-10
- ⊕ T-20
- ⊕ 2
- ⊕ 4
- ⊖ 3
- ⊖ 7
- ⊖ PH.3
- ⊖ PZ.3
- ⊖ PZ.2
- ⊖ PH.1
- ⊖ T-15
- ⊖ T-25
- ⊖ 3
- ⊖ 5

Discontinued

Possible discounts on remaining stock



| Description   | Part No. |
|---|----------|
| Ratcheted Screwdriver Set of 10 bits (double ended) | 800-051  |

### 11 Pc Cellular Phone Maintenance Tool Kit

Supplied with T-Grip holder, slotted tip 0.5mm X 2.0mm, T5, T6, T8, Phillips #1, pressing blade, panel pry bar, spanner 5mm, and antenna repair tool. It's ideal for the repair and maintenance of cellular phones.



| Description                               | Part No. |
|---|----------|
| 11 PC Cellular Phone Maintenance Tool Kit | 902-222  |

### Pro-soft Spanner Security Screwdriver Set

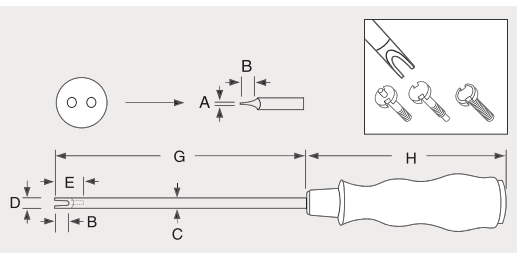

Unit: inch

| Description | Pro-soft Spanner Security Screwdriver Set |     |     |     |     |      |      |
|-------------|---|-----|-----|-----|-----|------|------|
| Part No.    | A   | B   | C   | D   | E   | G    | H    |
| 902-098     | .02                                       | .02 | .16 | .08 | .39 | 3.15 | 3.35 |
|             | .04                                       | .02 | .20 | .08 | .39 | 3.15 | 4.33 |
|             | .04                                       | .02 | .20 | .09 | .39 | 3.15 | 4.33 |
|             | .05                                       | .02 | .21 | .10 | .39 | 3.15 | 4.33 |
| Contents    | M1.7, M2.0, M2.3, M2.6                    |     |     |     |     |      |      |



### 14 Pc Ratchet Precision Screwdriver Set

Elastomer resin fitting exactly and double structure. Non-slip.

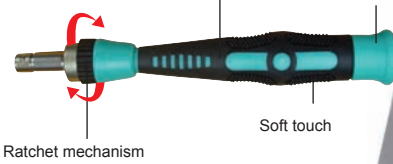

- Bits Contents:
- ⊕ #00, #0, #1
  - ⊖ 1.0, 1.5, 2.5
  - ⊖ 4.0, 5.0
  - ⊖ T5, T6, T7, T8
- Extension blade: 4.7" ratchet handle



| Description                             | Part No. |
|---|----------|
| 14 PC Ratchet Precision Screwdriver Set | SD-9312  |

### 33 Pc Screwdriver Set w/Bits

Bits Contents:

- ⊕ PH000x1.1
- ⊕ PH00x1.1
- ⊕ PH0x1.1
- ⊕ PH1x1.1
- ⊖ SL1.0x1.1
- ⊖ SL1.5x1.1
- ⊖ SL2.0x1.1
- ⊖ SL2.5x1.1
- ⊖ SL3.0x1.1
- ⊖ SL3.5x1.1
- ⊖ SL4.0x1.1
- ⊕ T4x28
- ⊕ T5x28
- ⊕ T6x28
- ⊕ T7x28
- ⊕ T8x1.1
- ⊕ T9x1.1
- ⊕ T10x1.1
- ⊕ T15x1.1
- ⊕ T20x1.1
- ⊕ H0.7x1.1
- ⊕ H0.9x1.1
- ⊕ H1.3x1.1
- ⊕ H1.5x1.1
- ⊕ H2.0x1.1
- ⊕ H2.5x1.1
- ⊕ H3.0x1.1
- ⊕ H4.0x1.1
- ⊕ PZ1x1.1
- ⊕ PZ0x1.1

- Socket:
- ⊖ M5
  - ⊖ M6
- Shaft:
- ⊖ M4



| Description                  | Part No. |
|------------------------------|----------|
| 33 PC Screwdriver Set w/Bits | 800-129  |

### 6 Pc Insulated Precision Screwdriver Set

- Provides Shock Protection to 1000V AC
- Meet VDE Standards for safety to 1000V AC
- Both sets come complete with a plastic storage case
- Material (Blade): Cr-Mo
- OAL: 6-4/16 inches



- ⊖ 0.4x2.0x2-9/16"
- ⊖ 0.4x2.5x2-9/16"
- ⊖ 0.23x1.5x2-9/16"
- ⊕ PH0x2-9/16"
- ⊕ PH00x2-9/16"
- ⊕ PH1x2-9/16"



| Description                              | Part No. |
|--|----------|
| 6 PC Insulated Precision Screwdriver Set | 902-099  |

### 30-Piece Do-It-All Kit

This comprehensive kit will work with almost every type of fastener.

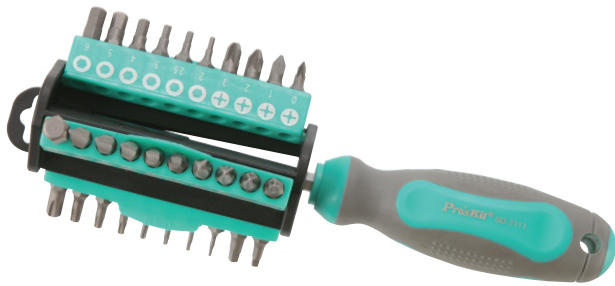

| Contents |                                    |
|----------|------------------------------------|
|          | SQ1, SQ2                           |
|          | PH0, PH1, PH2, PH3                 |
|          | PZ0, PZ1, PZ2, PZ3                 |
|          | SL3.5, 4.5, 5.5, 6, 8              |
|          | HX2, 2.5, 3, 4, 5, 6, 8            |
|          | T5, T6, T7, T8, T10, T15, T20, T35 |

| Description            | Part No. |
|------------------------|----------|
| 30-Piece Do-It-All Kit | SD-2313  |

### 5-in-1 Screwdriver with LED Flashlight

#0 1/8" #00 1/16"



### 50 pcs display pack

| Description  | Part No. |
|--|----------|
| 5-in-1 Screwdriver with LED Flashlight (50 Pcs display pack) | SD-804   |
| 5-in-1 LED Screwdriver Single pc                             | SD-804-1 |

### 12 Pc Pro-Soft Screwdriver Set

Exactly fit to screws and high accuracy hardened finished.

High grade Ni-Cr-Mo steel.

new design shape for comfortable and powerful handling in operation

Elastomer resin fitting exactly and double structure. Non-slip.

| Contents |         |
|----------|---------|
|          | 2.0x50  |
|          | 3.0x75  |
|          | 5.0x75  |
|          | 6.0x40  |
|          | 6.0x100 |
|          | 6.0x200 |
|          | #00x50  |
|          | #0x75   |
|          | #1x75   |
|          | #2x40   |
|          | #2x100  |
|          | #2x200  |

**Comes in a plastic molded tray!**

| Description                    | Part No. |
|--------------------------------|----------|
| 12 Pc Pro-Soft Screwdriver Set | SD-2312  |

### 10 Pc Pro-Soft Screwdriver Set

Mobile telephone, communication equipment, radio and precision equipment.

Exactly fit to screws and high accuracy hardened finished.

High grade chrome-molybdenum steel.

Working length: 50mm

Elastomer resin fitting exactly and double structure. Non-slip.

Soft touch

Rotary cap

| Spec. |  |
|-------|--|
| #000  |  |
| #00   |  |
| 1.0   |  |
| 1.6   |  |
| 2.0   |  |
| T3    |  |
| T4    |  |
| T5H   |  |
| T6H   |  |
| T7H   |  |

| Description                    | Part No. |
|--------------------------------|----------|
| 10 Pc Pro-Soft Screwdriver Set | SD-9810  |

## 62 Pc Security Bit Set

- Contents:
- M5, M6, M8
- C1, C2, C3
- 1/8", 3/16"
- 2mm x 2mm x 2mm
- S0, S1, S2, S3
- 1, 2, 3, 4, 5
- 0, 1, 2
- Wing nut driver
- 6, 8, 10
- PZ0, PZ1, PZ2
- 4, 6, 8, 10, 12
- T-5, T-6, T-7, T-8, T-10, T-15, T-20, T-25, T-27, T-30, T-40
- 2mm, 2.5mm, 3mm, 4mm, 5mm, 6mm, 8mm, 5/64", 3/32", 7/64", 1/8", 9/64", 5/32"
- 1 Pc 1/4" x 60mm magnetic bits holder
- 1 Pc bits holder socket
- 1 Pc socket adapter
- 1 Pc ratchet screwdriver

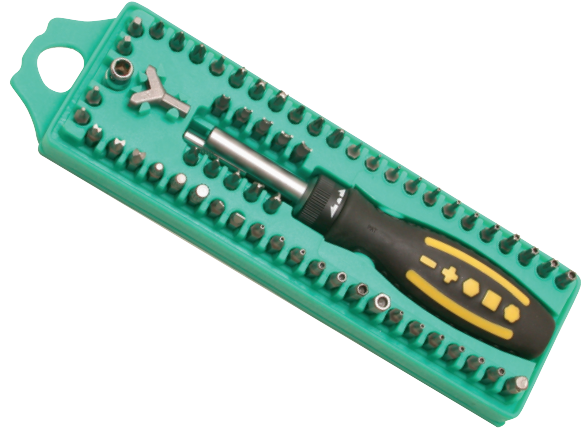

| Description            | Part No. |
|------------------------|----------|
| 62 Pc Security Bit Set | 800-081  |

## 21 Pc 1/4" & 3/8" Dual Function Ratchet Handle Sockets Set



- Handy, all-in-one 21-piece ratchet set!
- Chrome vanadium steel bits.
- Includes a custom storage case.
- Light weight design, 1063g per set.
- 18 bits with one stubby ratchet handle, and two extension bars.

| Description  | Part No. |
|--|----------|
| 21 Pc 1/4" & 3/8" Dual Function Ratchet Handle Sockets Set | SD-2306M |

| Contents  |
|---|
| 1 pc 1/4" DR & 3/8" DR stubby ratchet handle                                  |
| 1 pc extension bar 1/4" DR x2"  |
| 1 pc extension bar 3/8" DR x3"  |
| 8 pc 3/8" DR socket:<br>10mm, 11mm, 12mm, 13mm, 14mm, 15mm, 17mm, 19mm        |
| 10 pc 1/4" DR socket:<br>4mm, 5mm, 6mm, 7mm, 8mm, 9mm, 10mm, 11mm, 12mm, 13mm |

## 35 Pc 1/4" Drive Socket & Screwdriver



- Featuring ratchet lock function, and two unique handles for more flexible work.
- Handy, all-in-one 35-piece ratchet set!
- Chrome vanadium steel bits.
- Includes a custom storage case.
- Light weight design, 679g per set.

| Description                        | Part No. |
|------------------------------------|----------|
| 35 Pc 1/4" DR Socket & Screwdriver | SD-2307M |

| Contents  |
|---|
| 11 pc 1/4" DR sockets:<br>4mm, 5mm, 5.5mm, 6mm, 7mm, 8mm, 9mm, 10mm, 11mm, 12mm, 13mm   |
| 20 pc bits:<br>PH0, PH1, PH2, PH3     T10, T15, T20, T25, T30, T40<br>3mm, 5mm, 7mm     PZ2<br>2.5mm, 3mm, 4mm, 5mm, 6mm, 8mm |
| 1 pc ratchet handle 1/4" DR   |
| 1 pc bit holder   |
| 1 pc handle driver  |
| 1 pc 1/4" x 2" ext bar  |

## 35 Pc 1/4" Drive Socket & Screwdriver W/Long Nosed Plier Set

- Featuring ratchet lock function, universal joint, and adjustable T-bar.
- Chrome vanadium steel bits.
- Light weight design, 908g per set.
- Handy, all-in-one 35-piece variety of tools!
- Includes a patented reversible storage case.



Double-sided design reversible storage case.

| Contents  |                               |
|---|-------------------------------|
| 11 pc 1/4" DR sockets:<br>4mm, 5mm, 5.5mm, 6mm, 7mm, 8mm, 9mm, 10mm, 11mm, 12mm, 13mm |                               |
| 12 pc bits:<br>⊕ PH1, PH2, PH3      ⊗ T10, T15, T20, T25, T30<br>⊖ 3mm, 4mm, 5mm, 6mm |                               |
| 4 pc 50mm bit<br>⊕ PH2, PH3      ⊖ 6mm, 7mm   |                               |
| 2 pc ext bar 1/4"x3" ,1/4"x6"   | 1 pc long nose plier (135mm)  |
| 1 pc ratchet handle   | 1 pc 1/4" DR adjustable T-bar |
| 1 pc bit holder   | 1 pc handle driver            |
| 1 pc 1/4" x 1/4" universal joint  |                               |

| Description  | Part No. |
|--|----------|
| 35 Pc 1/4" DR Socket & Screwdriver W/Long Nose Plier Set | SD-2308M |

## 40 Pc Reversible Ratchet Screwdriver W/Bits & Sockets Set

- Handy, all-in-one 40-piece ratchet set!
- Featuring dual-color rotatable ratchet handle.
- Chrome vanadium steel bits.
- Includes a custom storage case.
- Light weight design, 733g per set.

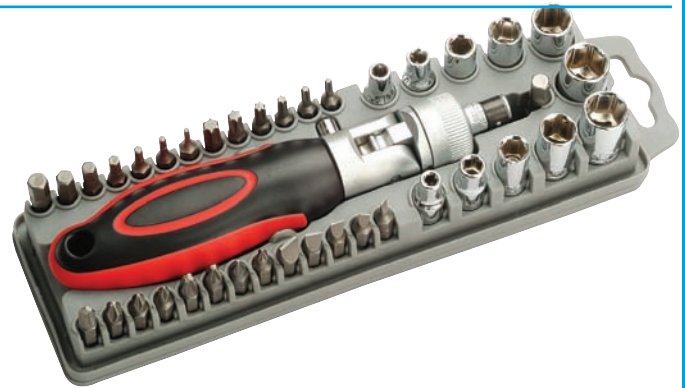

| Contents  |  |
|---|--|
| 11 pc 1/4" DR sockets:<br>4mm, 5mm, 5.5mm, 6mm, 7mm, 8mm, 9mm, 10mm, 11mm, 12mm, 13mm   |  |
| 26 pc bits:<br>⊕ PH0, PH1, PH2, PH3      ⊗ T10, T15, T20, T25, T30, T40<br>⊖ 3mm, 4mm, 5mm, 6mm, 8mm      ⊗ PZ0, PZ1, PZ2, PZ3<br>● 2mm, 2.5mm, 3mm, 4mm, 5mm, 6mm, 7mm |  |
| 1 pc adapter  |  |
| 1 pc magnetic bit holder 100mm  |  |
| 1 pc 3-position reversible ratchet screwdriver  |  |

| Description   | Part No. |
|---|----------|
| 40 Pc Reversible Ratchet Screwdriver W/Bits & Sockets Set | SD-2309  |

## 100 Pc Assorted Power Bits Set

- Handy, all-in-one 100-piece ratchet set!
- Includes a custom storage case.
- Chrome vanadium steel bits.
- Light weight design, 669g per set.

| Contents  |                          |
|---|--------------------------|
| 96 pc bits:<br>⊕ PH1, PH2      ⊕ S2: PH0, PH1, PH2, PH3<br>⊖ C1, C2, C3      ⊕ S0, S1, S2, S3<br>⊖ 1, 2, 3, 4, 5      ⊕ 6, 8, 10<br>⊗ PZ0, PZ1, PZ2, PZ3      ⊕ 2mm x 2mm x 2mm<br>● M5, M6, M8      ⊖ 2mm, 3mm, 5mm<br>⊖ 4, 6, 8, 10, 12      ⊕ Wing nut driver<br>● 1.5mm, 2mm, 2.5mm, 3mm, 4mm, 4.5mm, 5mm, 5.5mm, 6mm,<br>7mm, 8mm, 1/16", 5/64", 3/32", 7/64", 1/8", 9/64", 5/32", 3/16", 7/32", 1/4"<br>● 2mm, 3mm, 4mm, 5mm, 6mm, 7mm, 8mm, 5/64", 3/32", 7/64", 1/8", 9/64",<br>5/32", 3/16", 7/32", 1/4"<br>● T5H, T6H, T8H, T10H, T15H, T20H, T25H, T27H, T30H, T35H, T40H<br>● T5, T6, T8, T10, T15, T20, T25, T27, T30, T40 |                          |
| 1 pc sockets adapter  | 1 pc dry wall stopper    |
| 1 pc bits holder  | 1 pc magnetic bit holder |

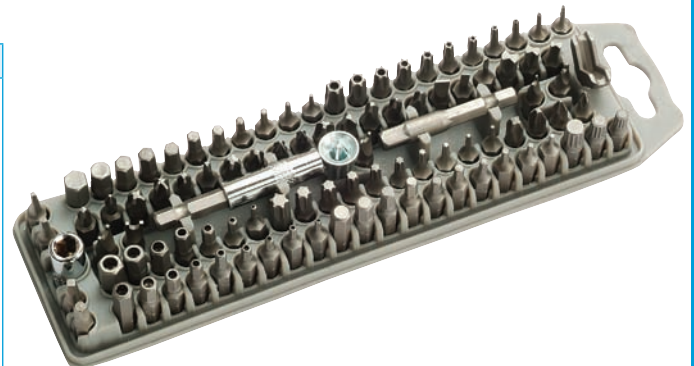

| Description                    | Part No. |
|--------------------------------|----------|
| 100 Pc Assorted Power Bits Set | SD-2310  |