

DASH NO.	M CODE	MADE FROM
----------	--------	-----------

SD

7705-10

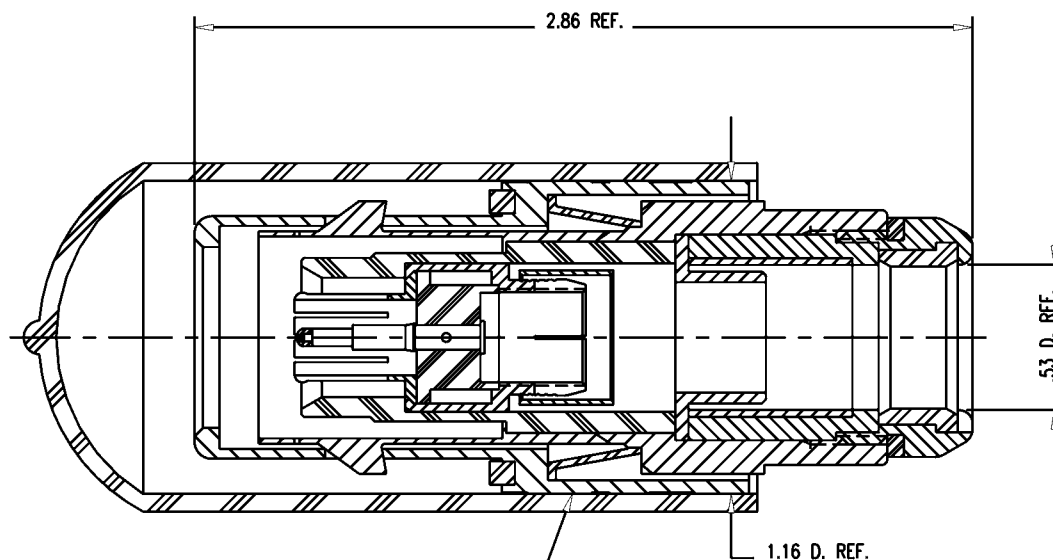

STAMP: KINGS 7705-10  
YRWK (DATE CODE)

REVISIONS

ISSUE	CHANGES
0	ER 37375 KH 09/08/97
1	CN 37519 A KH 12/17/97
2	CN 38434 E TML 10/24/01
3	CN 38787 E DCT 3/6/3

770510S1

SCALE 2:1	
APPROX SURFACE AREA	
WAS: E-19463	
USED ON	
REF:	
PLUG, TRI-LOC, LOW PROFILE FULL CRIMP (SERIAL DIGITAL)	
DRAWN PG	DATE 03/06/97
DESIGN LJ	DATE 03/06/97
APPR. FDH	DATE 09/08/97

**KINGS**  
ELECTRONICS CO., INC.  
ROCK HILL, SOUTH CAROLINA 29730

7705-10

SD

- NOTES:
- FOR USE WITH 740 CABLE GROUP. (GEPCO/COMMSCOPE 7826, MOHAWK M52479 & BELDEN 9232)
  - FOR CABLING INSTRUCTIONS SEE 3-651 (CONVENTIONAL METHOD) OR 3-711 (PRE-PREPARED DIMENSIONS).
  - USE CRIMPING TOOL KTH-8000 AND DIE KTH-8002.
  - FINGERS MUST MAKE CONTACT TO .955 DIA. RING AFTER BEING DEFLECTED TO .895 DIA.
  - MATERIALS:
    - INSULATORS: TEFLON, ASTM-D-4894
    - GASKETS: SILICONE RUBBER, ZZ-R-765
    - CONDUCTIVE GASKET: CONSIL C 87-10004
    - K-GRIP SLEEVE: COM BRONZE, ASTM-B-135
    - OUTER CONTACT & FINGER BODY: BER. COPPER, ASTM-B-196
    - CENTER CONTACT TIP: DELRIN
    - CAP: VINYL
    - ALL OTHER METAL PARTS: BRASS, ASTM-B16

- FINISHES:
  - CENTER CONTACTS: HARD GOLD PLATE, PER MIL-G-45204
  - ALL OTHER METAL PARTS: KINGS TARNISH RESISTANT NICKEL FINISH (TR-5)
- ELECTRICAL CHARACTERISTICS:
  - NOMINAL IMPEDANCE: 75 OHMS
  - FREQUENCY RANGE: DC-500 MHz
  - VOLTAGE BREAKDOWN: CENTER CONDUCTOR/INNER GROUND: 1500 VRMS
  - INNER GROUND/OUTER GROUND: 500 VRMS

- UNLESS OTHERWISE SPECIFIED
- TOLERANCES: FRACTIONS & 2 PLACE DECIMALS ± .010  
3 PLACE DECIMALS ± .004 ANGLES ± 1°  
CONCENTRICITY OF ANY 2 DIAMETERS MAY NOT EXCEED HALF THE SUM OF THEIR TOLERANCES.
  - REMOVE ALL BURRS, BREAK SHARP EDGES .005 MAX.
  - NO FILLETS PERMITTED.
  - SURFACE ROUGHNESS 63 MICROINCHES RMS MAX.
  - ALL DIMENSIONS PRIOR TO PLATING.
  - ALL PLATING IN ACCORDANCE WITH KER 10004.
  - ALL LEAD THREADS TO BE CHAMFERED 45° TO ROOT DIAMETER.  
★ CRITICAL DIMENSIONS