

1

2

3

4

5

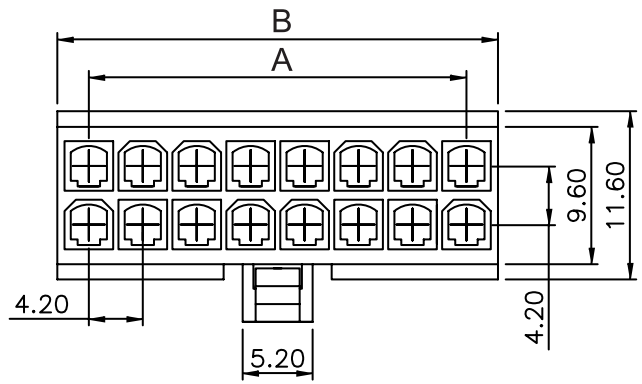
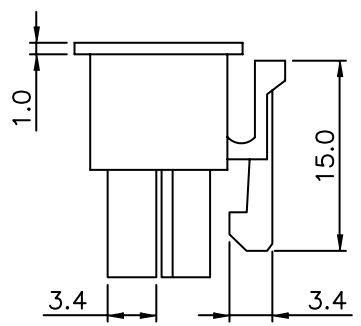
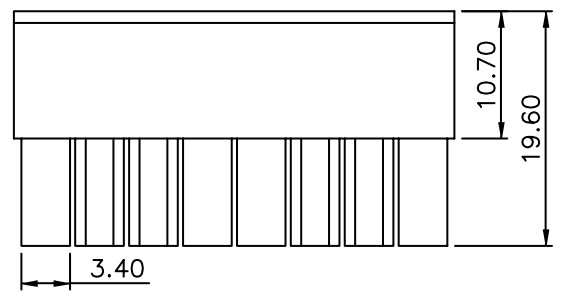
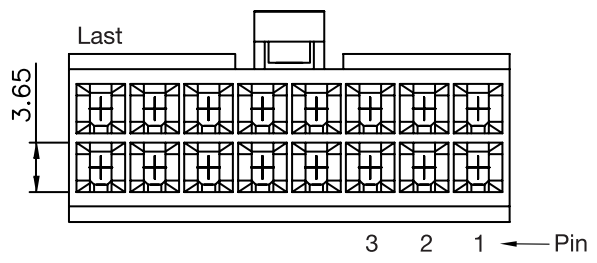

TECHNICAL CHARACTERISTICS

MATERIAL
 INSULATOR: NYLON 66
 FLAMABILITY RATING: UL94-V0
 COLOR: WHITE
 PITCH: 4.20MM

ENVIRONMENTAL
 OPERATING TEMPERATURE: -40 UP TO 105°C
 COMPLIANCE: LEAD FREE AND ROHS

ELECTRICAL
 CURRENT RATING: 6 TO 9A

NB CIRCUITS □	2-3 □	4-6 □	7-10 □	12-24
AMPERES ▣	9 □	8 □	7 □	6

WORKING VOLTAGE: 600V AC
 INSULATOR RESISTANCE: >1000 MOHM
 DIELECTRIC WITHSTANDING VOLTAGE: 1500V AC/MN

STANDARD
 CERTIFIED: E323964 / MODEL NUMBER 649-1133

PACKAGING
 BAG

DIMENSION
 A = 4.20 x (NB. PIN / 2 - 1)
 B = 4.20 x (NB. PIN / 2) + 1.20

RoHS Compliant			
G			
F	18-NOV-09	STANDARD	JP
E	24-JUN-09	BAG PACKAGING	JP
D	23-AVR-09	PACKAGING	JC
C	12-NOV-08	UL 94-V0 & PINING	JP
B □	20-MAR-07 □	DRAW □ □	EC
A □	□ □	LEAD FREE □	JP
REV	DATE	FILE	BY

PROJECTION:	
APPROVAL: RJ	

GENERAL TOLERANCE
.X = +/- 0.2
.XX = +/- 0.15

UNIT: MM
SCALE:
SHEET: 1/2
DRAW: PEARL

DESCRIPTION: 4.20MM FEMALE DUAL ROW RECEPTACLE	SIZE A4
WERI PART NO: 649 0xx 113 322	

A

B

C

D

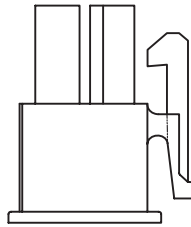
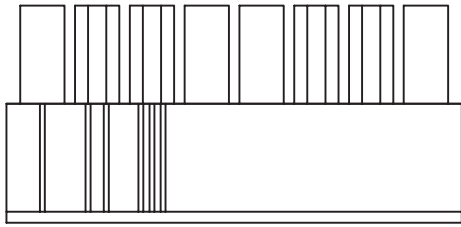
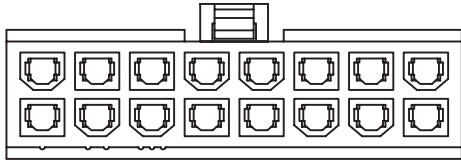

Note:
 1.Dimension:
 Carton Size:40*28*28(cm)
 2.Quantity:

Pin.	Pcs/Bag	Pcs/Carton	Pin.	Pcs/Bag	Pcs/Carton
2	1000	13000	14	500	2000
4	1000	8000	16	500	1500
6	1000	5000	18	500	1500
8	1000	4000	20	300	1200
10	500	3500	22	300	1200
12	500	3000	24	300	900

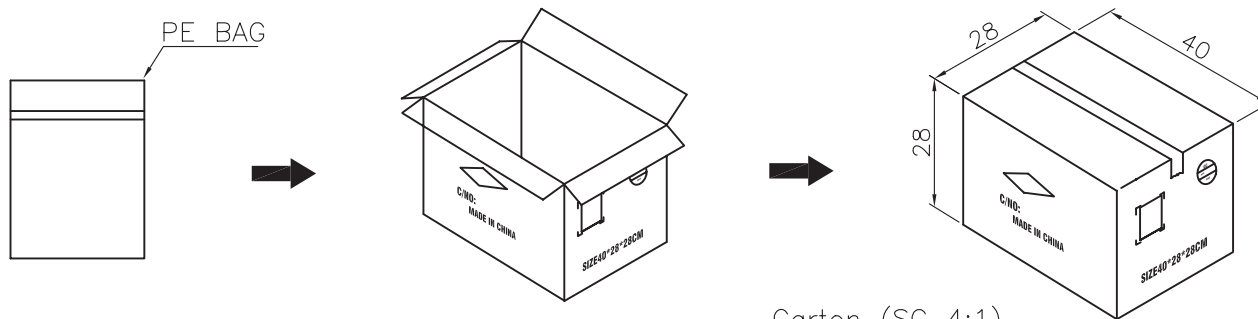

RoHS Compliant

G			
F			
E			
D			
C			
B			
A			
REV	DATE	FILE	BY

PROJECTION:

GENERAL TOLERANCE
 .X = +/- 0.2
 .XX = +/- 0.15



APPROVAL: RJ

UNIT: MM
 SCALE:
 SHEET: 2/2
 DRAW: PEARL

DESCRIPTION: 4.20MM FEMALE DUAL ROW RECEPTACLE
 WERI PART NO: 6490 xx 113322_TPK

SIZE
A4