

EAO – Your Expert Partner for Human Machine Interfaces

61-1300.0 - Illuminated pushbutton actuator round

61-1300.0 - Illuminated pushbutton actuator round

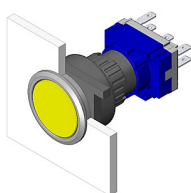

Attention: The preview is based on a sample product. This can differ from your current configuration.

Mounting

Design flush

Other Attributes

Weight 0,005 kg

Operating-/Indication part

Lens illumination illuminative

IP-Rating

Front protection IP65

Actuator

Switching action

Housing colour black

Housing material Plastic

Function

Illuminated pushbutton

EAO – Your Expert Partner for Human Machine Interfaces

61-1300.0 - Illuminated pushbutton actuator round

Dimensions

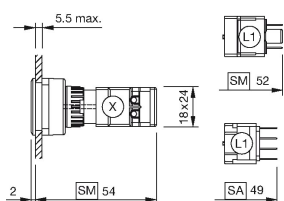

L1 = Solder/Plug-in terminal 2.8 x 0.5 mm

Mounting cut-outs

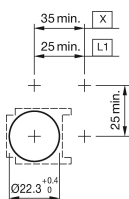

L1 = Solder/Plug-in terminal 2.8 x 0.5 mm

Wiring diagram

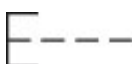

Additional information

B-C convertible from momentary to maintained action

Legend

Switching action: B = Momentary, C = Maintained