

P/N	APPLICABLE NOTE(S)	(Ø A)
-1CC	1,2	.036
-1CCSF	1,2	.036
-2CC	1,2	.020
-2CCSF	1,2	.020
-3CC	1,2	.010
-3CCSF	1,2	.010
-4CC	1,2	.012
-4CCSF	1,2	.012
-5CC	1,2	.015
-5CCSF	1,2	.015
-6CC	1,2	.018
-6CCSF	1,2	.018

REVISIONS				
ZONE	REV	DESCRIPTION	DATE	BY
—	—	—	—	—

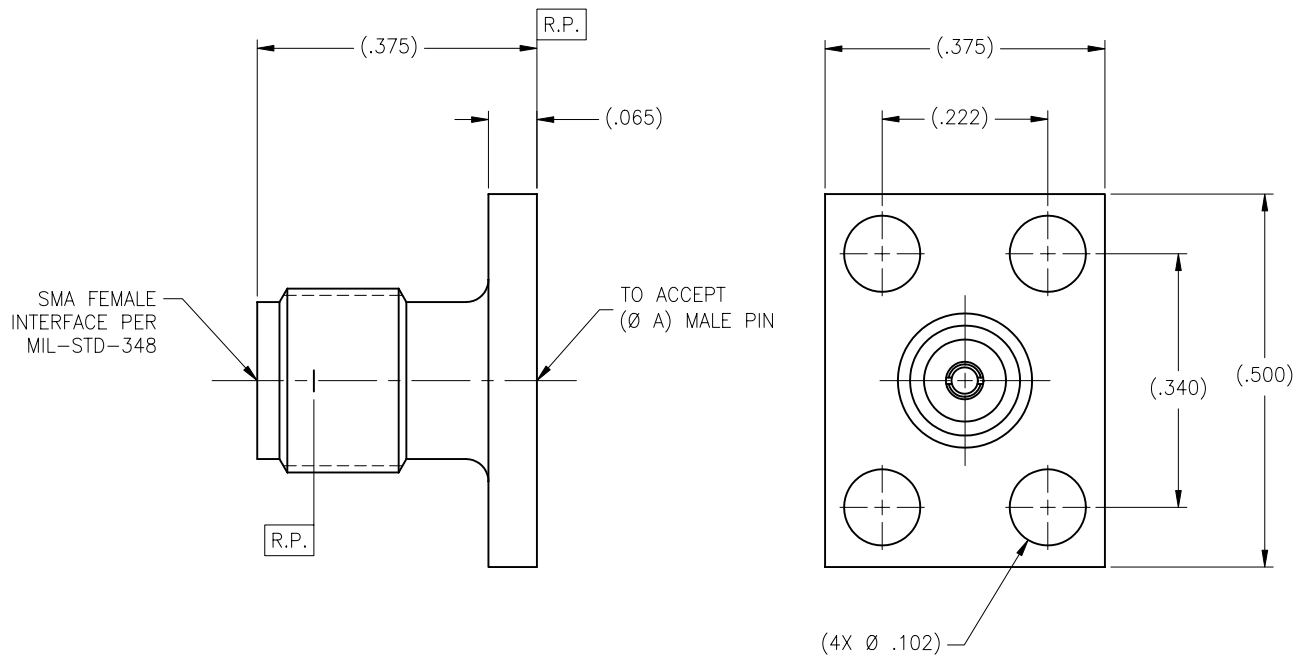

DRAWING NO.	5717	REV.	—
-------------	------	------	---

NOTES(S):

1. MATERIAL(S):

- 1.1 BODY: 303 SST PER ASTM A-582.
- 1.2 CENTER CONDUCTOR: BeCu ALLOY C173 PER ASTM B-196.
- 1.3 INSULATOR: PTFE PER ASTM D-1710.

2. FINISH(ES):

- 2.1 BODY:  
(FOR CCSF's): PASSIVATED PER ASTM A-967.  
(FOR CC's): GOLD PLATE PER ASTM B-488 OVER NICKEL PLATE PER AMS-QQ-N-290.
- 2.2 CENTER CONDUCTOR: GOLD PLATE PER ASTM B-488 OVER NICKEL PLATE PER AMS-QQ-N-290.
- 2.3 INSULATOR: NONE

**TOLERANCES AND NOTES**  
EXCEPT AS NOTED  
DIMENSIONS ARE IN INCHES.  
LINEAR .XX ±.015 ANGULAR ± 1/2°  
FRACTION ± 1/32

- 1. MACHINE FINISH: 63/RMS
- 2. BREAK ALL SHARP EDGES .003 MAX.
- 3. MACHINED FILLETS .005 MAX.
- 4. MACHINED SURFACES SQUARE TO RESPECTIVE AXIS WITHIN .005 INCHES PER INCH.
- 5. MACHINED DIAMETERS CONCENTRIC WITHIN .002 T.I.R.
- 6. DIMENSIONS TO BE MET BEFORE PLATING.
- 7. CHAMFER ALL THREADS 45°.
- 8. THREADS PER 14-28
- 9. REMOVE FRAVED EDGES ON TEFLON.
- 10. REMOVE ALL BURRS.

**NOTICE**  
THIS DRAWING EMBODIES A CONFIDENTIAL PROPRIETARY DESIGN ORIGINATED BY TENSOLITE COMPANY AND ALL DESIGN, MANUFACTURING REPRODUCTION, USE AND SALE RIGHTS REGARDING THE SAME ARE EXPRESSLY RESERVED. IT IS SUBMITTED UNDER A CONFIDENTIAL RELATIONSHIP FOR A SPECIFIED PURPOSE AND THE RECIPIENT AGREES BY ACCEPTING THIS DRAWING NOT TO SUPPLY OR DISCLOSE ANY INFORMATION REGARDING IT TO ANY UNAUTHORIZED PERSON TO INCORPORATE IN OTHER PROJECTS ANY SPECIAL FEATURES PECULIAR TO THIS DESIGN. ALL PATENT RIGHTS HERETO ARE EXPRESSLY RESERVED BY TENSOLITE COMPANY, LONG BEACH, CALIFORNIA 90815.

SEE NOTES		—	SEE NOTES		—
MATERIAL		SIZE	SPECIFICATION		PROCUREMENT
NEXT ASSY		<b>Tensolite</b> HIGH PERFORMANCE CABLES & INTERCONNECT SYSTEMS Long Beach, California 90815			
APPROVAL INITIALS		DATE		TITLE	
DRAWN BY R.C.		04.01.02		SMA FEMALE 4 HOLE FLANGE (.375 X .500) MOUNT FIELD REPLACEABLE	
CHECKED		SCALE	SUB-DIRECTORY/FILENAME		
QUALITY		8/1	OL		SHEET 1 OF 1
ENGINEERING ATV		06.17.02	SIZE	CAGE CODE	DRAWING NO.
			C	30990	5717
					REV. —