

Connectors for Copper Conductors

Two-Way Splice Connectors – Standard Barrel Certified to 600V and Recommended up to 35 kV*

Material: High-Conductivity Wrought Copper

Finish: Electro Tin Plate

Two-way connectors provide high pullout values, are easy to insulate and provide a low-resistance connection of high quality and low installed cost.

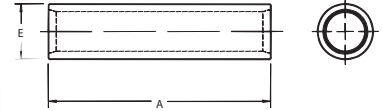

Compression

CAT. NO.	Code	WIRE SIZE Flex Class G, H, I, K, M*	Dimensions in. (mm)		Die Set Cat. No.	Color Code
			A	B		
54504	#8 AWG	#8 AWG, 37/24, #8 Weld	1.00 (25.4)	0.27 (6.9)	21	Red
54505	#6 AWG	#6 AWG, 61/24, #6 Weld, 133/0.014	1.00 (25.4)	0.30 (7.6)	24	Blue
54506	#4 AWG	#4 AWG, 91/24, 133/0.0177, 49/0.029	1.00 (25.4)	0.37 (9.4)	29	Grey
54507	#2 AWG	125/24, #4 Weld	1.25 (31.8)	0.41 (10.4)	33	Brown
54508	#1 AWG	#2 AWG, 150/24, 175/24, #2 Weld, 133/0.0223	1.50 (38.1)	0.47 (11.9)	37	Green
54509	1/0 AWG	225/24, #1 Weld, 133/0.0254	1.63 (41.4)	0.52 (13.2)	42	Pink
54510	2/0 AWG	1/0 AWG, 275/24, 1/0 Weld, 427/0.0155, 133/0.0282	1.75 (44.5)	0.57 (14.5)	45	Black
54511	3/0 AWG	2/0 AWG, 325/24, 2/0 Weld, 133/0.0316, 259/0.0227, 427/0.0177	1.75 (44.5)	0.63 (16.0)	50	Orange
53962		375/24, 179 kcmil, 133/0.0355, 259/0.0255, 427/0.0199	1.81 (46.0)	0.70 (17.8)	50	Orange
54512	4/0 AWG	3/0 AWG, 450/24, 3/0 Weld, 703/0.0154	1.88 (47.8)	0.70 (17.8)	54	Purple
54513	250 kcmil	4/0 AWG, 550/24, 4/0 Weld, 133/0.0399, 259/0.0286, 637/0.0183	2.25 (57.2)	0.77 (19.6)	62	Yellow
53964		4/0 AWG, 550/24, 4/0 Weld, 133/0.0399, 259/0.0286, 637/0.0183	2.13 (54.1)	0.79 (20.1)	62	Yellow
54514	300 kcmil	–	2.13 (54.1)	0.83 (21.1)	66	White
54515	350 kcmil	–	2.25 (57.2)	0.90 (22.9)	71	Red
54516	400 kcmil	–	2.75 (69.9)	0.93 (23.6)	76	Blue
53968		300 kcmil, 775/24 (313 kcmil)	3.00 (76.2)	1.13 (28.7)	87	Brown
54518	500 kcmil	–	2.75 (69.9)	1.11 (28.2)	87	Brown
54520	600 kcmil	–	3.00 (76.2)	1.18 (30.0)	94	Green
54522-TB	700 kcmil	–	3.25 (82.6)	1.23 (31.2)	99	Pink
53969		1325/24 = 500/535 kcmil, 427/0.0342	3.00 (76.2)	1.24 (31.5)	99	Pink
54523-TB	750 kcmil	–	3.00 (76.2)	1.30 (33.0)	106	Black
54528	1000 kcmil	–	3.63 (92.2)	1.50 (38.1)	125	N/A
54530	1250 kcmil	–	4.13 (104.9)	1.67 (42.4)	140	N/A

*Contact Technical Services for specific stranding listings.
Tooling: pp. 116–145 Die Selector Chart: pp. 146–153

‡ For installations from 16 kV up to 35 kV, consult shielded cable manufacturers for stress relief and insulation requirements.

Two-Way Splice Connectors – Long Barrel Certified to 600V and Recommended up to 35 kV* Applications

Material: High-Conductivity Wrought Copper

Finish: Electro Tin Plate

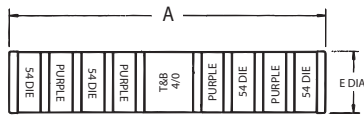

CAT. NO.	Code	WIRE SIZE Flex Class G, H, I, K, M	Dimensions in. (mm)		Die Code	Color Code
			A	E		
54804	#8 AWG	#8, 37/24 = 14.9 kcmil	1.75 (44.5)	0.27 (6.9)	21	Red
54805	#6 AWG	#6, 61/24 = 24.6 kcmil	1.75 (44.5)	0.31 (7.9)	24	Blue
54806	#4 AWG	#4, 91/24 = 36.7 kcmil	1.75 (44.5)	0.39 (9.9)	29	Grey
54807	#2 AWG	125/24 = 50.4 kcmil	1.88 (47.8)	0.43 (11.0)	33	Brown
54808	#1 AWG	#2, 150/24 = 60.5 kcmil 175/24 = 70.6 kcmil	2.00 (50.8)	0.49 (12.4)	37	Green
54809	1/0 AWG	225/24 = 90.8 kcmil	2.00 (50.8)	0.54 (13.7)	42	Pink
54810	2/0 AWG	1/0, 275/24 = 111 kcmil	2.13 (54.1)	0.59 (15.0)	45	Black
54811	3/0 AWG	2/0, 325/24 = 131 kcmil	2.25 (57.2)	0.65 (16.5)	50	Orange
54812	4/0 AWG	450/24 = 182 kcmil	2.75 (69.9)	0.72 (18.3)	54	Purple
54813	250 kcmil	4/0, 550/24 = 222 kcmil	3.38 (85.9)	0.79 (20.1)	62	Yellow

‡ For installations from 16 kV up to 35 kV, consult shielded cable manufacturers for stress relief and insulation requirements.

CAT. NO.	Code	WIRE SIZE Flex Class G, H, I, K, M	Dimensions in. (mm)		Die Code	Color Code
			A	E		
54814	300 kcmil	250, 650/24 = 262 kcmil	3.50 (88.9)	0.87 (22.1)	66	White
54815	350 kcmil	–	3.75 (95.3)	0.95 (24.1)	71	Red
54816	400 kcmil	775/24 = 313 kcmil	3.75 (95.3)	0.98 (24.9)	76	Blue
54818	500 kcmil	350, 925/24 = 373 kcmil	4.75 (120.6)	1.11 (28.2)	87	Brown
54820	600 kcmil	1100/24 = 444 kcmil	4.25 (108.0)	1.21 (30.7)	94	Green
54823	750 kcmil	500, 1325/24 = 535 kcmil	4.75 (120.6)	1.34 (34.0)	106	Black
58524		1600/24 = 646 kcmil	5.00 (127.0)	1.39 (35.3)	106	Black
58526*	900 kcmil	750, 1925/24 = 777 kcmil	5.50 (139.7)	1.51 (38.4)	115	Yellow
54828	1000 kcmil	–	5.63 (143.0)	1.56 (39.6)	125	N/A
54833	1500 kcmil	–	5.63 (143.0)	1.56 (39.6)	125	N/A
54839	2000 kcmil	–	7.06 (179.3)	2.13 (54.1)	–	N/A

*CSA approved code cable only
Tooling: pp. 116–145
Die Selector Chart: pp. 146–153

‡ For installations from 16 kV up to 35 kV, consult shielded cable manufacturers for stress relief and insulation requirements.