

4S1 & 4SS-Series

Sub-Miniature & **Sealed** Sub-Miniature Slide Switches

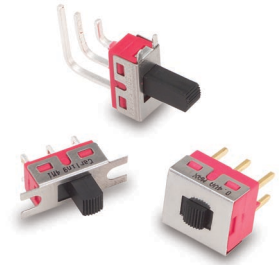

4M1-Series

Miniature Slide Switch

Specifications

Contact Rating refer to ordering scheme
 Electrical Life 30,000 make & break cycles at full load
 Contact Resistance. 10 mΩ max. initial @ 2-4 VDC
 100mA for both silver & gold plated contacts.
 Insulation Resistance . . . 1000 MΩ min.
 Dielectric Strength 1500 Volts RMS @ sea level
 Operating Temperature . . . -30°C to +85°C
 Solder Heat Resistance. . . MIL-STD-202, Method 210
 Actuator Travel 25°

Materials

Case Diallyl phthalate (DAP) (UL 94V-0)
 Slide Handle. Nylon
 Housing. Stainless Steel
 Terminal Seal Epoxy

4S1-Series Ordering Scheme



1 SERIES 4S1 Sub-Miniature Slide Switch			
2 POLES FSP single pole			
3 CIRCUIT			
Switching Position:			
1	2-1	OPEN	2-3
3	ON	NONE	ON
	ON	OFF	ON
4 TERMINATION			
M2 PCB			
M6 PC Mount, 90° horizontal			

5 CONTACT		
	<i>Material</i>	<i>Terminal Plating</i>
G	silver ¹	gold over silver ³
K	gold ²	tin-lead ⁴
P	silver ¹	tin-lead ⁴
Q	silver ¹	silver ¹
R	gold ²	gold ²
	<i>Rating</i>	
	3A@125VAC or 28VDC; 1.5A @ 250VAC	
	0.4VA max. @20V max (AC/DC)	
	3A@125VAC or 28VDC; 1.5A @ 250VAC	
	3A@125VAC or 28VDC; 1.5A @ 250VAC	
	0.4VA max. @20V max (AC/DC)	
NOTE:		
Tin-lead option available with PC type terminations only.		
1	Moveable contact & terminals: copper alloy, silver plate	
2	Moveable contact & terminals: copper alloy with gold plate over nickel plate	
3	Terminals: silver plate with outer layer in gold plating	

6 EPOXY SEAL	
E	epoxy seal

7 PACKAGING	
Switches are bulk packed, unless T/R is specified at the end of the part number.	
T/R tape reel - 500 pieces per reel	

4SS-Series Ordering Scheme



1 SERIES 4SS Sealed Sub-Miniature Slide Switch																
2 POLES FSP single pole																
3 CIRCUIT <table style="width: 100%; border-collapse: collapse;"> <tr> <td colspan="4" style="text-align: center;">Switching Position:</td> </tr> <tr> <td></td> <td style="text-align: center;">2-1</td> <td style="text-align: center;">OPEN</td> <td style="text-align: center;">2-3</td> </tr> <tr> <td style="text-align: center;">1</td> <td style="text-align: center;">ON</td> <td style="text-align: center;">NONE</td> <td style="text-align: center;">ON</td> </tr> <tr> <td style="text-align: center;">3</td> <td style="text-align: center;">ON</td> <td style="text-align: center;">OFF</td> <td style="text-align: center;">ON</td> </tr> </table>	Switching Position:					2-1	OPEN	2-3	1	ON	NONE	ON	3	ON	OFF	ON
Switching Position:																
	2-1	OPEN	2-3													
1	ON	NONE	ON													
3	ON	OFF	ON													
4 TERMINATION Termination options for switches with brick color actuators M2 PCB M6 PC Mount, 90° horizontal M7 PC Mount, 90° vertical Termination options for switches with white color actuators L6 Surface Mount, 90° flat S6 Surface Mount, 90° horizontal S7 Surface Mount, 90° vertical																

5 CONTACT		
Material	Terminal Plating	Rating
G silver ¹	gold over silver	3A@125VAC or 28VDC; 1.5A @ 250VAC
K gold ²	tin-lead ⁴	0.4VA max. @20V max (AC/DC)
P silver ¹	tin-lead	3A@125VAC or 28VDC; 1.5A @ 250VAC
R gold ²	gold ²	0.4VA max. @20V max (AC/DC)
NOTE: Tin-lead option available with PC type terminations only.		
1 Moveable contact & terminals: copper alloy, silver plate		
2 Moveable contact & terminals: copper alloy with gold plate over nickel plate		
3 Terminals: silver plate with outer layer in gold plating		
4 Outer terminals: copper alloy with tin-lead over nickel plate		

6 EPOXY SEAL E epoxy seal
--

7 PACKAGING Switches are bulk packed, unless T/R is specified at the end of the part number. T/R tape reel - 500 pieces per reel

4M1-Series Ordering Scheme

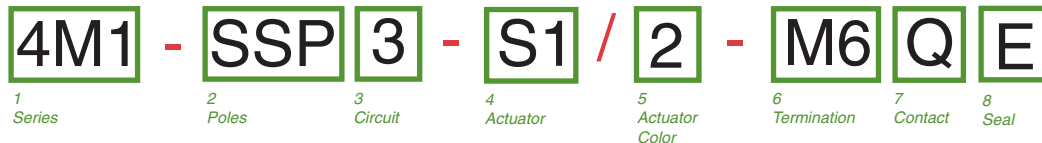

1 SERIES 4M1 Miniature Slide Switch												
2 POLES SSP single pole SDP double pole												
3 CIRCUIT Switching Position <table style="width: 100%; border-collapse: collapse;"> <tr> <td></td> <td style="text-align: center;">2-1, 5-4</td> <td style="text-align: center;">OPEN</td> <td style="text-align: center;">2-3, 5-6</td> </tr> <tr> <td style="text-align: center;">1</td> <td style="text-align: center;">ON</td> <td style="text-align: center;">NONE</td> <td style="text-align: center;">ON</td> </tr> <tr> <td style="text-align: center;">3</td> <td style="text-align: center;">ON</td> <td style="text-align: center;">OFF</td> <td style="text-align: center;">ON</td> </tr> </table>		2-1, 5-4	OPEN	2-3, 5-6	1	ON	NONE	ON	3	ON	OFF	ON
	2-1, 5-4	OPEN	2-3, 5-6									
1	ON	NONE	ON									
3	ON	OFF	ON									
4 ACTUATOR <table style="width: 100%; border-collapse: collapse;"> <tr> <td style="font-size: x-small;">S1 .201 [5.10] high</td> </tr> <tr> <td style="font-size: x-small;">S2 .285 [7.25] high</td> </tr> <tr> <td style="font-size: x-small;">S3 .370 [9.40] high</td> </tr> <tr> <td style="font-size: x-small;">S4 .140 [3.55] high</td> </tr> <tr> <td style="font-size: x-small;">S5 .053 [1.35] high (for DPDT only)</td> </tr> <tr> <td style="font-size: x-small;">S6 .482 [12.25] high</td> </tr> <tr> <td style="font-size: x-small;">S7 .311 [7.90] high</td> </tr> <tr> <td style="font-size: x-small;">T1 .201 [5.10] high (for DPDT only)</td> </tr> </table>	S1 .201 [5.10] high	S2 .285 [7.25] high	S3 .370 [9.40] high	S4 .140 [3.55] high	S5 .053 [1.35] high (for DPDT only)	S6 .482 [12.25] high	S7 .311 [7.90] high	T1 .201 [5.10] high (for DPDT only)				
S1 .201 [5.10] high												
S2 .285 [7.25] high												
S3 .370 [9.40] high												
S4 .140 [3.55] high												
S5 .053 [1.35] high (for DPDT only)												
S6 .482 [12.25] high												
S7 .311 [7.90] high												
T1 .201 [5.10] high (for DPDT only)												
5 ACTUATOR COLOR¹ <table style="width: 100%; border-collapse: collapse;"> <tr> <td style="font-size: x-small;">1 white</td> <td style="font-size: x-small;">3 red</td> <td style="font-size: x-small;">5 yellow</td> <td style="font-size: x-small;">7 blue</td> <td style="font-size: x-small;">9 gray</td> </tr> <tr> <td style="font-size: x-small;">2 black</td> <td style="font-size: x-small;">4 orange</td> <td style="font-size: x-small;">6 green</td> <td style="font-size: x-small;">8 brown</td> <td></td> </tr> </table> <p style="font-size: x-small;">1 White, black & red are standard. Other colors available for quantities of 5K or more.</p>	1 white	3 red	5 yellow	7 blue	9 gray	2 black	4 orange	6 green	8 brown			
1 white	3 red	5 yellow	7 blue	9 gray								
2 black	4 orange	6 green	8 brown									

6 TERMINATION	
M1 Solder Lug	M5-3 Wire Wrap [10.80]
M2 PCB	M5-4 Wire Wrap [26.97]
M3 Quick Connect	M6 PC Mount, 90° horizontal
M5-1 Wire Wrap .750 [19.05]	M7 PC Mount, 90° vertical
M5-2 Wire Wrap [24.48]	VS2 PC Mount, U bracket, .620 mounting x .460 high

7 CONTACT			
Material	Terminal Plating	Rating	Approvals
G silver ¹	gold over silver ²	5A@125VAC or 28VDC; 2A @ 250VAC	UL, CSA
K gold ²	tin-lead ⁴	0.4VA max. @20V max (AC/DC)	
P silver ¹	tin-lead ⁴	5A@125VAC or 28VDC; 2A @ 250VAC	UL, CSA
Q silver ¹	silver ¹	5A@125VAC or 28VDC; 2A @ 250VAC	UL, CSA
R gold ²	gold ²	0.4VA max. @20V max (AC/DC)	
NOTE: Tin-lead option available with PC type terminations only.			
1 Moveable contact & terminals: copper alloy, silver plate			
2 Moveable contact & terminals: copper alloy with gold plate over nickel plate			
3 Terminals: silver plate with outer layer in gold plating			
4 Outer terminals: copper alloy with tin-lead over nickel plate			

8 EPOXY SEAL E epoxy seal
--

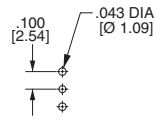
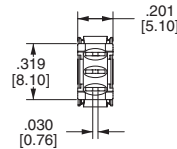
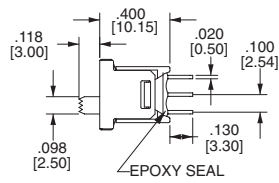
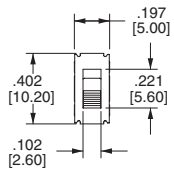
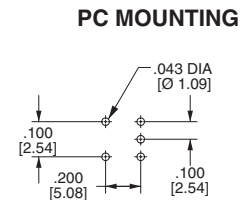
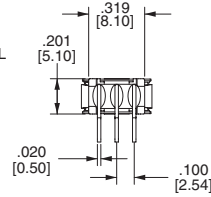
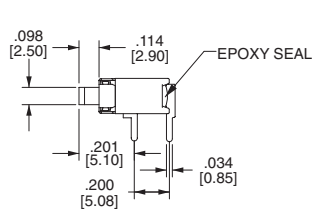
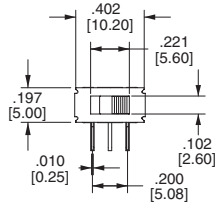
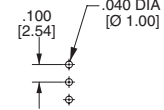
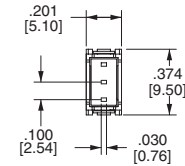
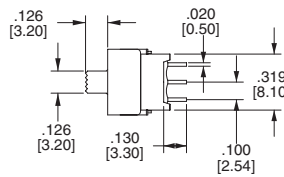
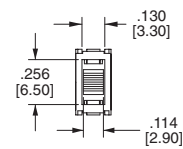
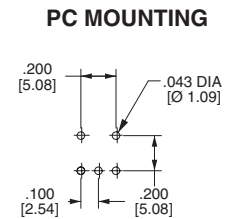
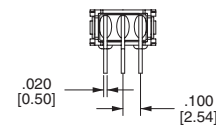
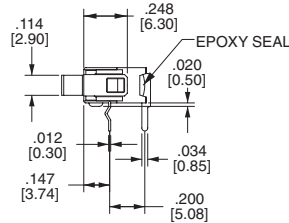
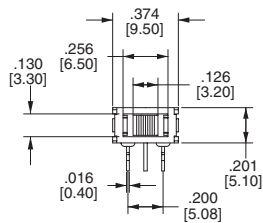
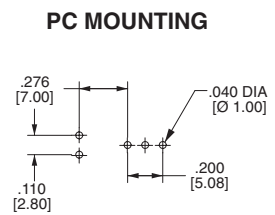
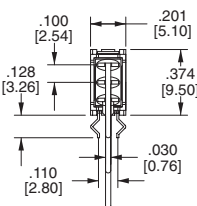
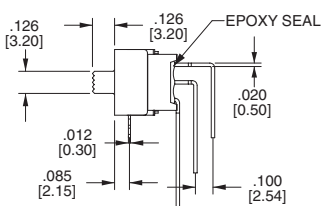
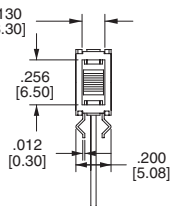
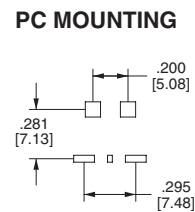
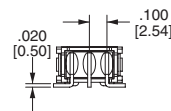
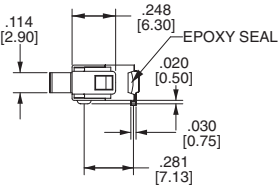
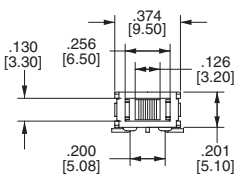
4S-Series Dimensional Specifications: in. [mm]
4S1-Series
TERMINATION
PC MOUNTING
M2

M6

4SS-Series
TERMINATION
PC MOUNTING
M2

M6

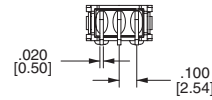
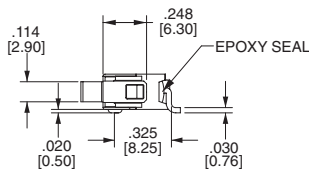
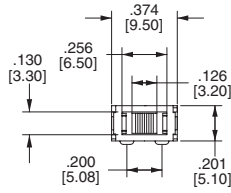
M7

L6

4SS-Series Dimensional Specifications: in. [mm]

TERMINATION

S6



PC MOUNTING

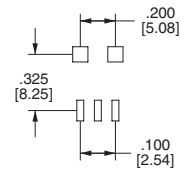

S7

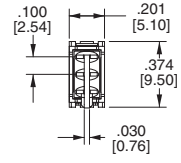
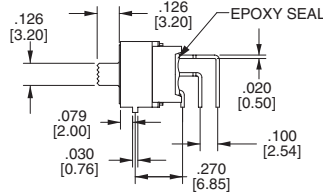
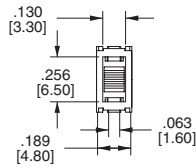

PC MOUNTING

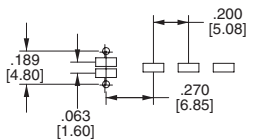

REEL TAPING

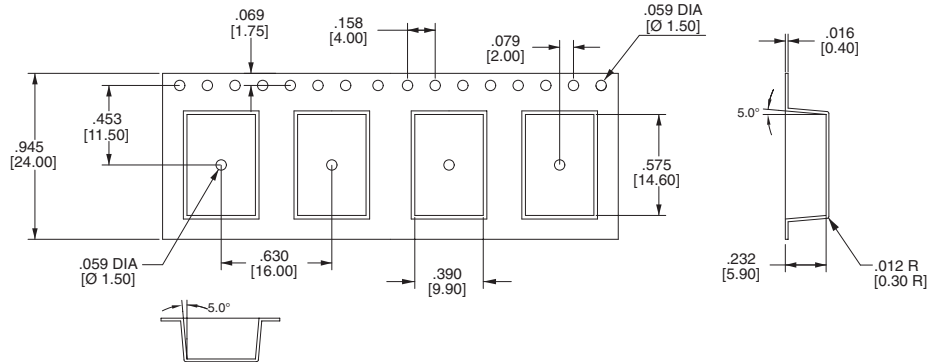

FOR S6, L6 ONLY

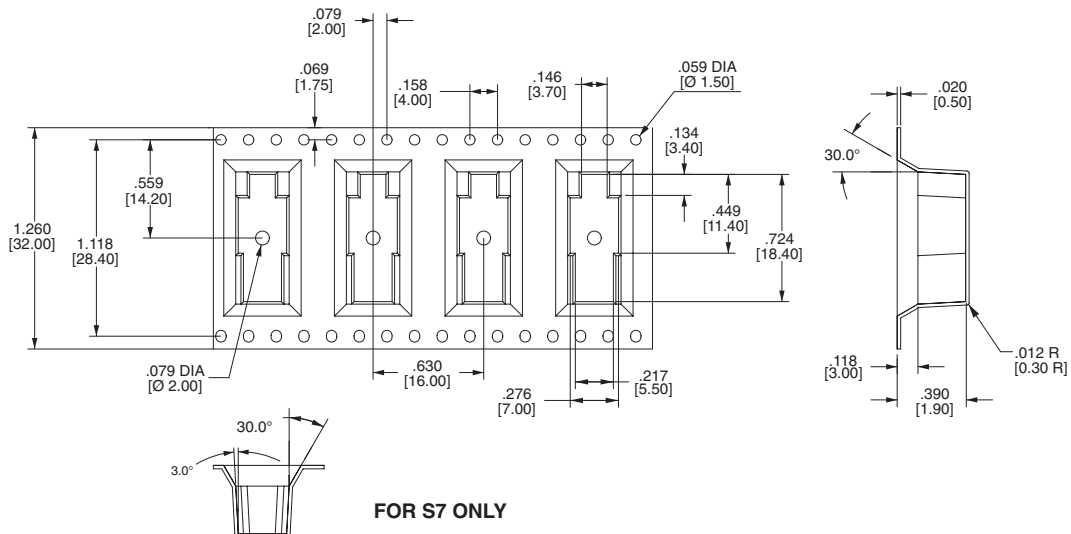

FOR S7 ONLY

4M1-Series Dimensional Specifications: in. [mm]

ACTUATOR

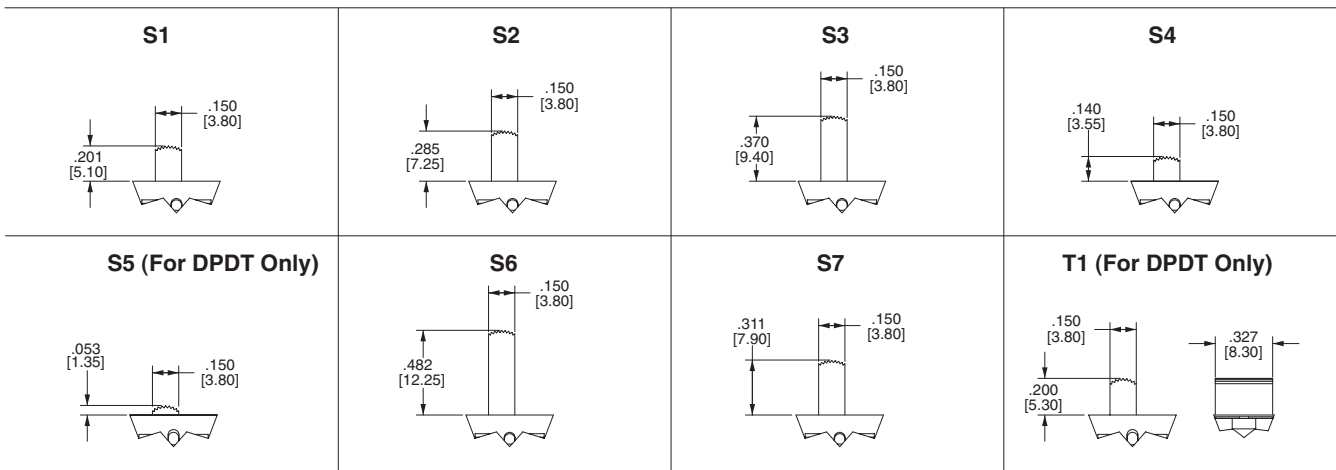

TERMINATION

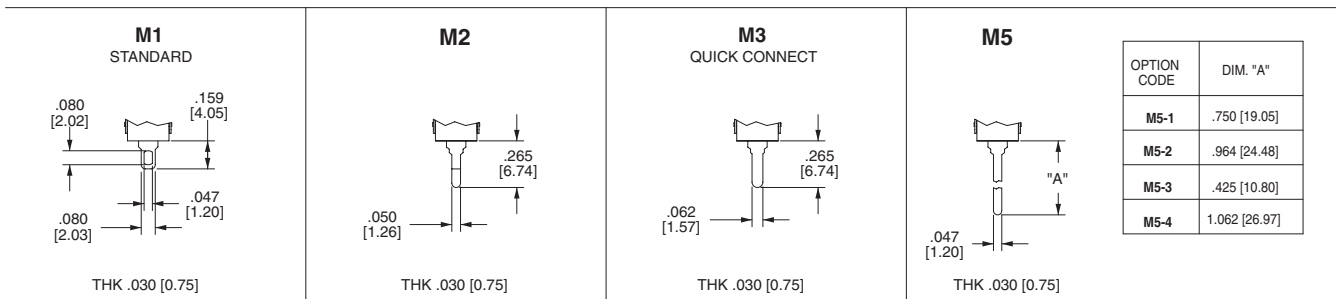

SINGLE POLE

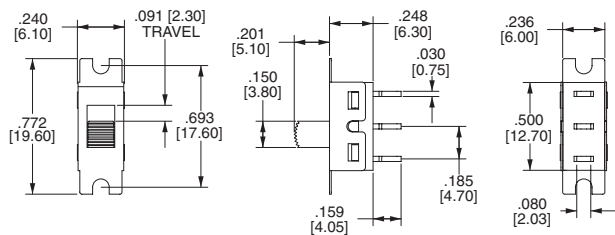

DOUBLE POLE

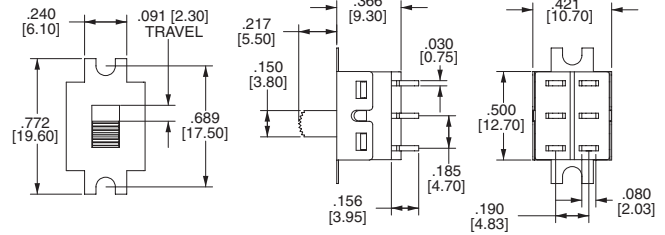

M6

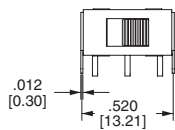

SINGLE POLE

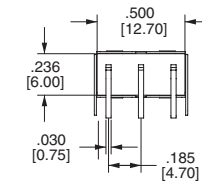
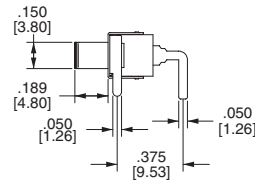

PC MOUNTING

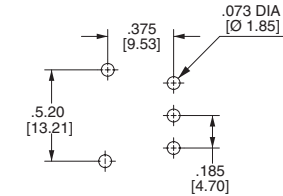

DOUBLE POLE

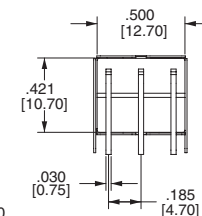
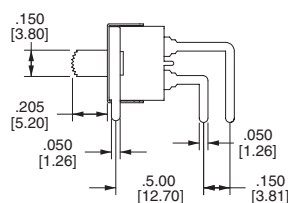
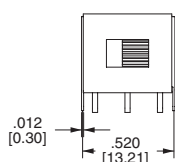

PC MOUNTING

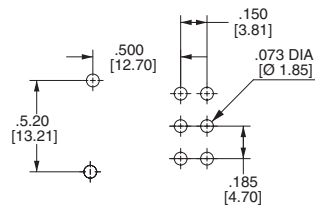

4M1-Series Dimensional Specifications: in. [mm]

TERMINATION

M7

SINGLE POLE

PC MOUNTING

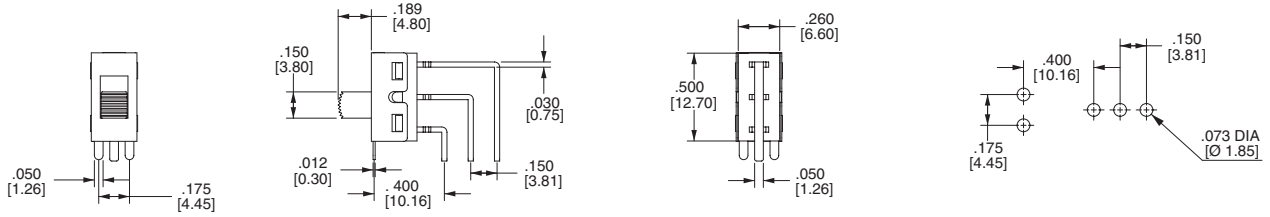

DOUBLE POLE

PC MOUNTING

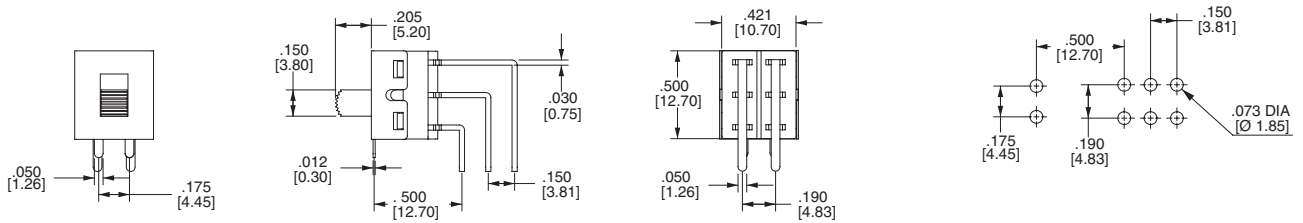

VS2

SINGLE POLE

PC MOUNTING

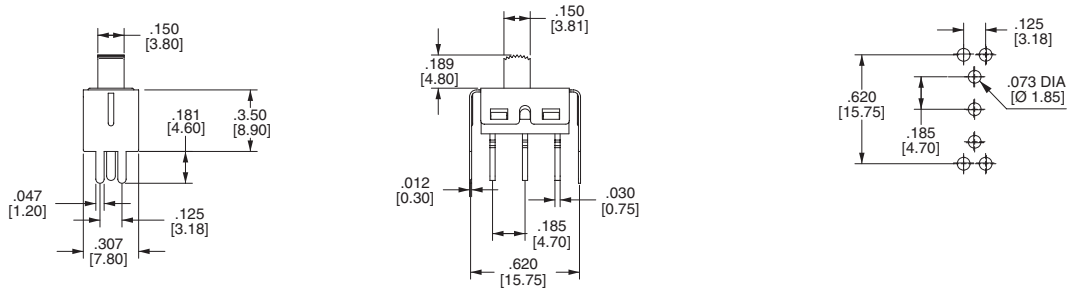

DOUBLE POLE

PC MOUNTING

