

# EAO – Your Expert Partner for Human Machine Interfaces

## 45-2231.31E0.000 - Illuminated pushbutton actuator, Momentary

### 45-2231.31E0.000 - Illuminated pushbutton actuator, Momentary

*Attention: The preview is based on a sample product. This can differ from your current configuration.*

#### Mounting

Design raised  
Mounting cut-out  $\varnothing$  22.5 mm

#### Front

Front shape round  
Front dimension  $\varnothing$  29.45 mm  
Front ring material Metal mat  
Front ring colour sandgrey

#### Other Attributes

Weight 0.020 kg

#### Operating-/Indication part

Lens optics opaque  
Lens material Plastic  
Lens colour red transparent  
Lens profile flat / level with front ring

#### IP-Rating

Front protection IP66, IP67, IP69K

#### Actuator

Switching action Momentary  
Housing material Plastic

#### Switching element

6

#### Function

Illuminated pushbutton

# EAO – Your Expert Partner for Human Machine Interfaces

45-2231.31E0.000 - Illuminated pushbutton actuator, Momentary

## Dimensions

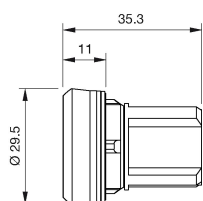

## Mounting cut-outs



## Wiring diagram

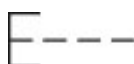

## Legend

Switching action: B = Momentary