

EAO – Your Expert Partner for Human Machine Interfaces

45-2131.1120.000 - Pushbutton actuator, Momentary

45-2131.1120.000 - Pushbutton actuator, Momentary



Attention: The preview is based on a sample product. This can differ from your current configuration.

Mounting

Design	raised
Mounting cut-out	Ø 22.5 mm

Front

Front shape	round
Front dimension	Ø 29.45 mm
Front ring material	Plastic
Front ring colour	black

Other Attributes

Weight	0.013 kg
--------	----------

Operating-/Indication part

Lens optics	opaque
Lens material	Plastic
Lens colour	red
Lens profile	flat / level with front ring

IP-Rating

Front protection	IP66, IP67, IP69K
------------------	-------------------

Actuator

Switching action	Momentary
Housing material	Plastic

Switching element

6

Function

Pushbutton

EAO – Your Expert Partner for Human Machine Interfaces

45-2131.1120.000 - Pushbutton actuator, Momentary

Dimensions

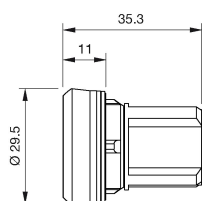

Mounting cut-outs



Wiring diagram

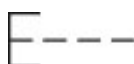

Legend

Switching action: B = Momentary