



RAF ELECTRONIC
HARDWARE

a Division of MW Industries, Inc.



[ABOUT US](#) [WHAT'S NEW](#) [CONTACT US](#) [SERVICES](#) [QUALITY](#) [SITE MAP](#)

- HOME
- PRODUCTS
- ONLINE CATALOG
- REQUEST QUOTE
- ORDER ONLINE
- CHECK STOCK
- REQUEST PRINT CATALOG
- REQUEST SAMPLES
- ENGINEERING DATA
- DISTRIBUTORS
- CAPABILITIES BROCHURE

CALL NOW:
203 888-2133



3/16 Hex Male-Female Standoffs

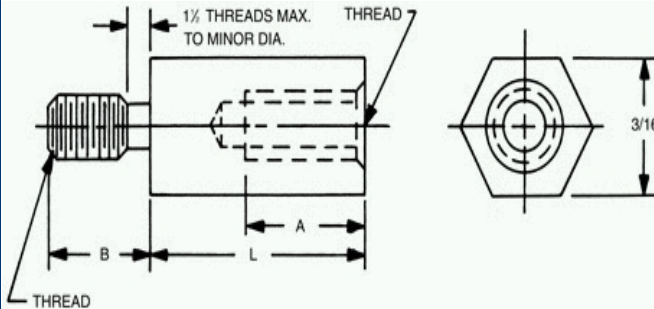

[Home](#) [Previous](#) [Next](#)
[Related Me](#)

Ordering Code			
xxxx	xxx	x	x
	Thread		Finish
Length		Material	

PART: ????-??-??

Red ?'s show missing selections. [H](#)

Select	Part No.	Length	Select	Part No.	Length	Select	Part No.	Length	Select	Code	Thread	Select	Code	Material	RoHS															
<input type="radio"/>	4500A	5/32	<input type="radio"/>	4509	3/4	<input type="radio"/>	4515	1-1/8	<input type="radio"/>	256	2-56	<input type="radio"/>	AL	Aluminum	YES															
<input type="radio"/>	4500	3/16	<input type="radio"/>	4509T	25/32	<input type="radio"/>	4516	1-3/16	<input type="radio"/>	440	4-40	<input type="radio"/>	B	Brass	YES															
<input type="radio"/>	4500T	7/32	<input type="radio"/>	4510	13/16	<input type="radio"/>	4517	1-1/4	<input type="radio"/>	632	6-32	<input type="radio"/>	SS	Stainless Steel	YES															
<input type="radio"/>	4501	1/4	<input type="radio"/>	4510T	27/32	<input type="radio"/>	4518	1-5/16	<table border="1"> <thead> <tr><th colspan="3">Thread Length Code</th></tr> <tr><th>Thread</th><th>A</th><th>B</th></tr> </thead> <tbody> <tr><td>2-56</td><td>3/16</td><td>5/32</td></tr> <tr><td>4-40</td><td>1/4</td><td>3/16</td></tr> <tr><td>6-32</td><td>3/8</td><td>1/4</td></tr> </tbody> </table>			Thread Length Code			Thread	A	B	2-56	3/16	5/32	4-40	1/4	3/16	6-32	3/8	1/4	<input type="radio"/>	S	Steel	YES
Thread Length Code																														
Thread	A	B																												
2-56	3/16	5/32																												
4-40	1/4	3/16																												
6-32	3/8	1/4																												
<input type="radio"/>	4501T	9/32	<input type="radio"/>	4511	7/8	<input type="radio"/>	4519	1-3/8	<input type="radio"/>	N	Nylon	YES																		
<input type="radio"/>	4502	5/16	<input type="radio"/>	4511T	29/32	<input type="radio"/>	4520	1-7/16	<p>In short lengths, 'A' will be tapped to maximum depth</p> <p>Material Specifications</p> <p>SELECT FINISH:</p> <p>select a material first <input type="button" value="v"/></p> <p>* Finishes ending with an asterisk are not RoHS Compliant</p> <p>Ordering non-standard items</p>																					
<input type="radio"/>	4502T	11/32	<input type="radio"/>	4512	15/16	<input type="radio"/>	4521	1-1/2																						
<input type="radio"/>	4503	3/8	<input type="radio"/>	4512T	31/32	<input type="radio"/>	4522	1-9/16																						
<input type="radio"/>	4503T	13/32	<input type="radio"/>	4513	1"	<input type="radio"/>	4523	1-5/8																						
<input type="radio"/>	4504	7/16	<input type="radio"/>	4514	1-1/16	<input type="radio"/>	4524	1-11/16																						
<input type="radio"/>	4504T	15/32				<input type="radio"/>	4525	1-3/4																						
<input type="radio"/>	4505	1/2				<input type="radio"/>	4526	1-13/16																						
<input type="radio"/>	4505T	17/32				<input type="radio"/>	4527	1-7/8																						
<input type="radio"/>	4506	9/16				<input type="radio"/>	4528	1-15/16																						
<input type="radio"/>	4506T	19/32				<input type="radio"/>	4529	2"																						
<input type="radio"/>	4507	5/8																												
<input type="radio"/>	4507T	21/32																												
<input type="radio"/>	4508	11/16																												
<input type="radio"/>	4508T	23/32																												

[HOME](#) | [PRODUCTS](#) | [ONLINE CATALOG](#) | [REQUEST QUOTE](#) | [ORDER ONLINE](#) | [CHECK STOCK](#) | [CONTACT US](#) | [SITE MAP](#)

© RAF Electronic Hardware, a Division of MW Industries | 95 Silvermine Rd., Seymour CT 06483 | Tel 203-888-2133 | Fax 203-888-9860