



SERIES 44-5 WEDGE-LOK

CID 59789

RECOMMENDED GAP WIDTH

PCB + 10.80 (.425)

RECOMMENDED TORQUE

180 N-cm (16 in-lbs)

WEIGHT

2.79 g/cm (.250 oz/in)

MATERIALS AND FINISH

WEDGES

Material: Aluminum Alloy 6061-T6 per QQ-A-200/8

Finish: See finish table on opposite page

SCREW

.14-in. or 3.6-mm hex. socket head cap screw, depending on mounting configuration

Material: 300 series stainless steel per QQ-S-763 ASTM A-582

Finish: Passivated per AMS2700

ALIGNMENT SPRINGS

Material: Beryllium Copper QQ-C-533

Finish: Nickel QQ-N-290, Class I, Grade G, Bright

OPTIONAL LOCK AND FLAT WASHER

Material: 300 series stainless steel per QQ-S-763 and ASTM A-582

Finish: Passivated per AMS2700

OPTIONAL LOCKNUT

Material: Type A286 stainless steel per ASTM AMS 5525

Finish: Silver plate per AMS 2410

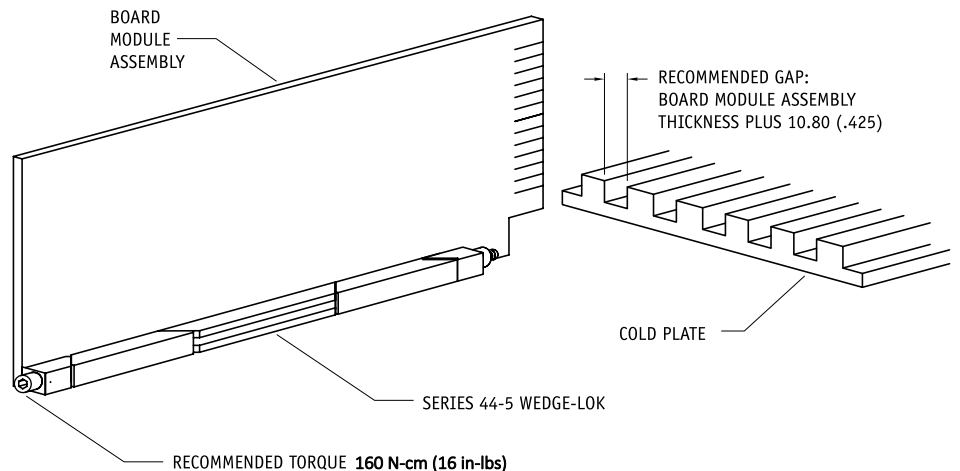
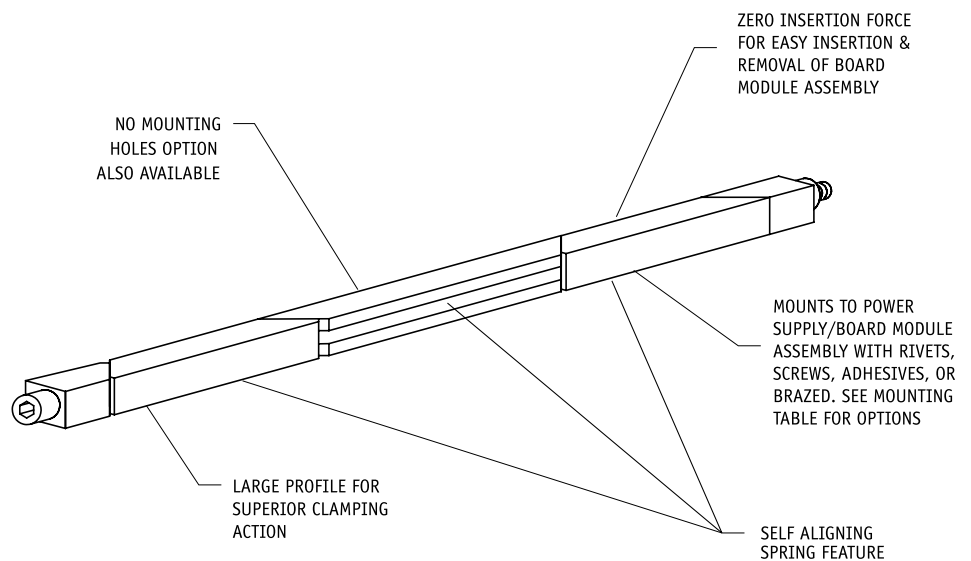

SERIES 44-5 WEDGE LOK

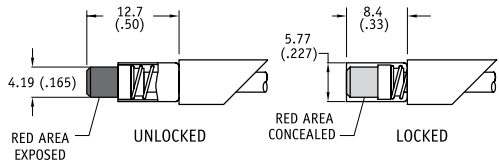

VI OPTION

Indicates assembly is unlocked (adds 5.1 (.20) to screw length)

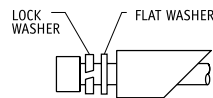

LF OPTION

Provides additional resistance to shock and vibration (adds 2.5 (.10) in screw length)

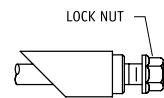

LN OPTION

Captivates rear wedge when untorqued (adds 2.5 (.10) to screw length)

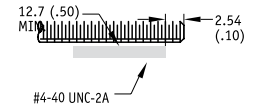

LO OPTION

Provides additional resistance to shock and vibration

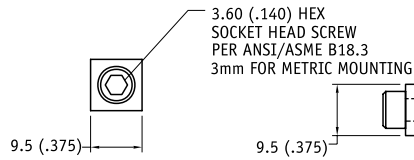

Units: mm(in)
unless specified otherwise,
.xx = ± .25, .x = ± .5
(.xxx = ±.010, .xx = ± .02)

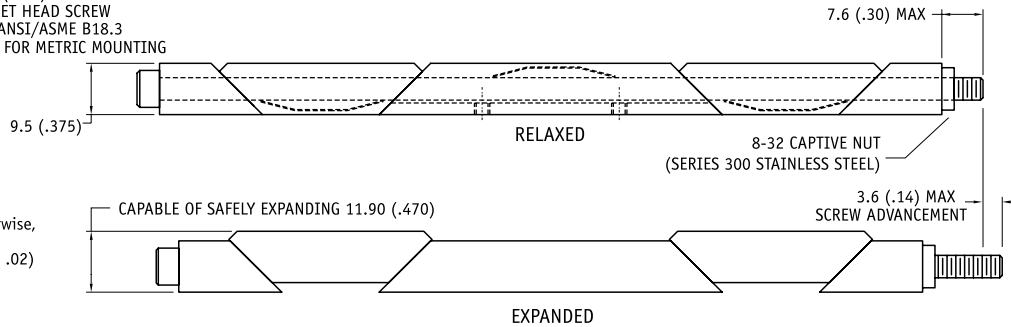

MOUNTING DIMENSIONS

25.40 (1.000) hole spacing centered on mounting body
-10 thru -13 2 holes
-14 thru -24 4 holes

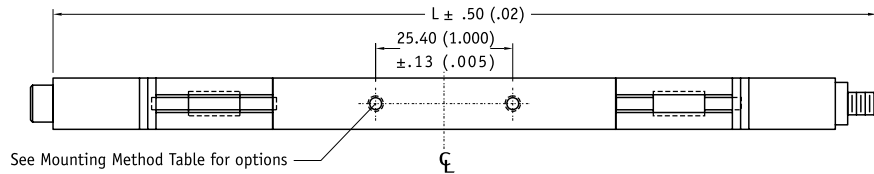

See Mounting Method Table for options

FINISH TABLE

CODE LETTER	SURFACE FINISH
[blank]	CHEMICAL FILM PER MIL-C-5541, CLASS 1A, GOLD, NON ROHS COMPLIANT
CC	CHEMICAL FILM PER MIL-C-5541, CLASS 1A, CLEAR
EN	ELECTROLESS NICKEL PER MIL-C-26074, CLASS 4, GRADE B, BRIGHT
N	NICKEL PLATE PER QQ-N-290, CLASS 1, GRADE G, BRIGHT BLACK
B	ANODIZE PER MIL-A-8625, TYPE II, CLASS 2
B3	HARD BLACK ANODIZE PER MIL-A-8625, TYPE III, CLASS 2 HARD
B3D	BLACK ANODIZE WITH DRY FILM LUBE PER MIL-L-46010

MOUNTING METHOD TABLE

CODE LETTER	METHOD
[blank]	4-40 UNC-2B TAPPED HOLES
A	NO MOUNTING HOLES
M	M2.5 X .45 TAPPED HOLE
M2	M2 X .40 TAPPED HOLE
M3	M3 X .50 TAPPED HOLE
R	RIVET MOUNT (Ø 3.45 + .10/-0.3 (.136 + .004/.001) THRU ⊥ Ø 4.95 (.195) ∇ 7.65 (.305) ∇ Ø 4.95 (.195) x 100°) RIVET "R" PARTS ARE SHIPPED UNASSEMBLED AND EXCLUDE ALIGNMENT PINS
S	2-56 UNC-2B TAPPED HOLE
T	0-80 UNF-2B TAPPED HOLE

*NOTE: FOR TORQUE LIMITING (TLC) VERSION:
VISUAL INDICATOR (VI), LOCK/FLAT WASHER (LF), LOCK PATCH (L) OPTIONS NOT AVAILABLE
ONE ALIGNMENT SPRING FOR -10 TO -15 LENGTHS
MUST CLICK 3+ TIMES FOR PROPER INSTALLATION

Part Number Code	44-5 VI - 10 - B - LF - LN - S - L
Type	
Torque Limiting version* _____	TLC
Standard version with Visual Indicator _____	VI
Standard version _____	[Blank]
Length	
Length in 12.7 (.50) increments _____	10 [127.0 (5.00)]
_____	to 24 [304.8 (12.00)]
Finish	
BlackAnodized _____	B
Or select code letter from Finish Table	
Lock/Flat Washers and Locknut	
Lock Washer and Flat Washer _____	LF
None _____	[Blank]
Lock Nut _____	LN
None _____	[Blank]
Mounting	
Standard 4-40 threaded holes _____	[Blank]
or choose from Mounting Method Table	
Lock Patch	
Lock Patch _____	L
None _____	[Blank]



SCHROFF