

D SUBMINIATURE CONNECTORS

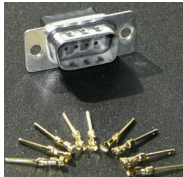
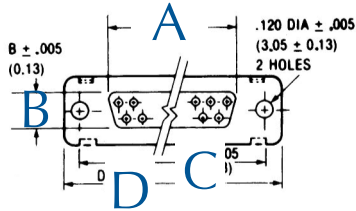

Fig. 1

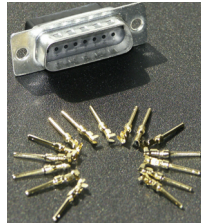

Fig. 2



Fig. 3

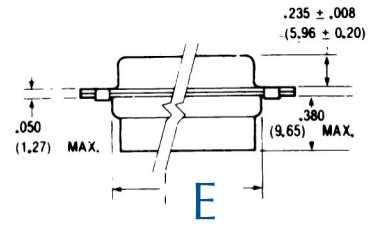

Fig. 4



Fig. 5



Fig. 6



Fig. 7



Fig. 8

Male D-Subminiature Connectors

Retail Part No.	Bulk Part No.	Bulk Part No. 100 Package	Fig. No.	Description	No. of Pins	Contact Position	A In. (mm)	B In. (mm)	C In. (mm)	D In. (mm)	E In. (mm)	F In. (mm)	G In. (mm)	H In. (mm)
	41-1040-BU		1	DB-9 Shell/Insert Kit	9	9	.666 (16.92)	.329 (8.36)	.984 (24.99)	1.218 (30.94)	.758 (19.25)	.500 (12.70)	.422 (10.72)	.422 (10.72)
	41-1041-BU		2	DB-15 Shell/Insert Kit	15	15	.994 (25.25)	.329 (8.36)	1.312 (33.32)	1.546 (39.27)	1.082 (27.48)	.500 (12.70)	.422 (10.72)	.422 (10.72)
	41-1042-BU		3	DB-25 Shell/Insert Kit	20	25	1.534 (38.96)	.329 (8.36)	1.852 (47.04)	2.088 (53.04)	1.624 (41.25)	.500 (12.70)	.422 (10.72)	.422 (10.72)
		41-1045-100	4	Package of 100 Pins	100	N/A	N/A	N/A	N/A	N/A	N/A	N/A	N/A	N/A

Note: All of the above have a contact rating of 7.5 Amps (max) and are good for wire sizes #20 to #24 AWG

Female D-Subminiature Connectors

Bulk Part No.	Bulk Part No. 100 Package	Fig. No.	Description	No. of Pins	Contact Position	A In. (mm)	B In. (mm)	C In. (mm)	D In. (mm)	E In. (mm)	F In. (mm)	G In. (mm)	H In. (mm)
41-1050-BU		5	DB-9 Shell/Insert Kit	9	9	.643 (16.33)	.311 (7.90)	.984 (24.99)	1.218 (30.94)	.758 (19.25)	.500 (12.70)	.422 (10.72)	.429 (10.90)
41-1051-BU		6	DB-15 Shell/Insert Kit	15	15	.971 (24.66)	.311 (7.90)	1.312 (33.32)	1.546 (39.27)	1.082 (27.48)	.500 (12.70)	.422 (10.72)	.429 (10.90)
41-1052-BU		7	DB-25 Shell/Insert Kit	20	25	1.511 (38.96)	.311 (7.90)	1.852 (47.04)	2.088 (53.04)	1.624 (41.25)	.500 (12.70)	.422 (10.72)	.429 (10.90)
	41-1055-100	8	Package of 100 Sockets	100	N/A	N/A	N/A	N/A	N/A	N/A	N/A	N/A	N/A

Note: All of the above have a contact rating of 7.5 Amps (max) and are good for wire sizes #20 to #24 AWG



Fig. 9

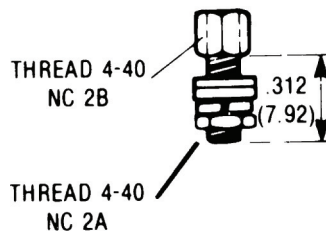

Screw Lock Assembly

Retail Part No.	Bulk Part No.	Bulk Part No. 100 Package	Fig. No.	Description	Material	Finish
		41-1033-100	9	Hex Nuts for Screw Lock Assembly, in accordance with MIL-STD-202A	Steel	Cadmium Plate, Yellow Chromate
41-1032-P			9	Female Screw Lock Assembly, in accordance with MIL-STD-202A	Steel	Cadmium Plate, Yellow Chromate

For the latest information—www.gcelectronics.com

All quantities are single; BU's are packages of 10 Unless otherwise noted.