



## Heyco® Snap-in PG Liquid Tight Bushings

- Can be used in threaded or unthreaded holes.
- Ozone and weather resistant.
- Provides light strain relief to the cable.
- Simple to install—just snap into place, pierce thin membrane, insert & pull back cable.
- Can be used as a liquid tight plug. Offers protection to IP 67.
- Sizes available to fit cable diameters ranging from .12" (3,0 mm) up to 1.38" (35,0 mm).

PANEL DIMENSIONS						CABLE DIAMETER RANGE				PART NO.	DESCRIPTION	Hole Size	PART DIMENSIONS					
Hole Diameter		Thickness Range				Min.		Max.					Gray	D Head Diameter	H Head Thickness		L Overall Length	
in.	mm.	in.	mm.	in.	mm.	in.	mm.	in.	mm.						in.	mm.		in.
.52	13,2	.04	1,0	.16	4,0	.12	3,0	.20	5,0	<b>4014</b>	LTB 30-50/PG7	PG7	.79	20,0	.24	6,1	.50	12,8
.63	16,0	.04	1,0	.16	4,0	.20	5,0	.28	7,0	<b>4015</b>	LTB 50-70/PG9	PG9	.79	20,0	.28	7,1	.75	19,0
.75	19,0	.04	1,0	.16	4,0	.28	7,0	.39	10,0	<b>4016</b>	LTB 70-100/PG11	PG11	.94	24,0	.28	7,1	.81	20,6
.91	23,0	.04	1,0	.16	4,0	.31	8,0	.55	14,0	<b>4017</b>	LTB 80-140/PG16	PG16	1.10	28,0	.28	7,1	.89	22,5
1.14	29,0	.04	1,0	.16	4,0	.55	14,0	.79	20,0	<b>4018</b>	LTB 140-200/PG21	PG21	1.36	34,5	.28	7,1	1.02	26,0
1.50	38,0	.04	1,0	.16	4,0	.79	20,0	1.02	26,0	<b>4019</b>	LTB 200-260/PG29	PG29	1.81	46,0	.26	6,6	1.14	29,0
1.89	48,0	.04	1,0	.16	4,0	1.02	26,0	1.38	35,0	<b>4020</b>	LTB 260-350/PG36	PG36	2.26	57,5	.31	7,9	1.42	36,0

Standard color gray.

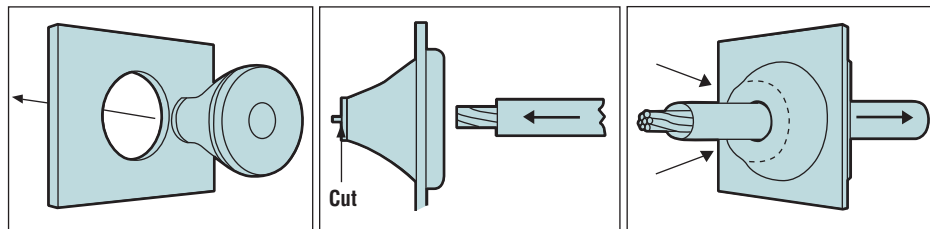
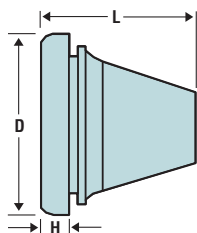

Snap Into Panel

Cut as shown and Insert Cable

Pull Back Cable to Form Seal



## Heyco® Snap-In Metric Liquid Tight Bushings

- For outdoor and indoor applications
- Good weather, UV, and ozone resistance

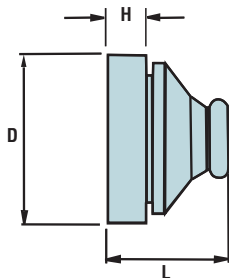

PANEL DIMENSIONS						CABLE DIAMETER RANGE				PART NO.	DESCRIPTION	Hole Size	PART DIMENSIONS					
Hole Diameter		Thickness Range				Min.		Max.					Gray	D Head Diameter	H Head Thickness		L Overall Length	
in.	mm.	in.	mm.	in.	mm.	in.	mm.	in.	mm.						in.	mm.		in.
.48	12,2	.05	1,3	.20	5,0	.12	3,0	.20	5,0	<b>4007</b>	LTB 30-50/M12	M12	.75	19,0	.26	6,5	.73	18,5
.64	16,2	.05	1,3	.20	5,0	.20	5,0	.28	7,0	<b>4008</b>	LTB 50-70/M16	M16	.91	23,0	.26	6,5	.73	18,5
.80	20,0	.05	1,3	.20	5,0	.28	7,0	.39	10,0	<b>4009</b>	LTB 70-100/M20	M20	1.06	27,0	.26	6,5	.77	19,5
.99	25,2	.05	1,3	.20	5,0	.39	10,0	.55	14,0	<b>4010</b>	LTB 100-140/M25	M25	1.26	32,0	.26	6,5	.77	19,5
1.27	32,2	.05	1,3	.20	5,0	.55	14,0	.79	20,0	<b>4011</b>	LTB 140-200/M32	M32	1.54	39,0	.26	6,5	.85	21,5
1.58	40,2	.05	1,3	.20	5,0	.79	20,0	1.02	26,0	<b>4012</b>	LTB 200-260/M40	M40	1.85	47,0	.26	6,5	.94	24,0
1.98	50,2	.05	1,3	.20	5,0	1.02	26,0	1.38	35,0	<b>4013</b>	LTB 260-350/M50	M50	2.28	58,0	.26	6,5	1.18	30,0

Standard color gray.

Quick Specs

Material  
Temperature Rating  
IP Rating

Ethylene Propylene Diene Monomes Rubber (EPDM)  
-40°F (40°C) to 200°F (93°C)  
IP 67