

Type 703

Screw type terminal block, solderable, centerline 9.52 mm / 0.375 inches, horizontal wire entry, lift system, modular

Technical Data

UL V / A / AWG 300 / 30 / 26 - 10

CSA 0.12 - 4 mm² 750 V / 8 kV / 24 A

Insulation co-ordination according to IEC 664-1

Clearance and creepage distances min. 8.5 mm

Insulating material class CTI 600

Overtoltage category III III II

Pollution degree 3 2 2

Rated voltage 630 1600 1600

Rated test voltage 6 8 6

Protection category according to IEC 529 IP20

Tightening torque UL 5.3 lb-in max.

Min. insul. strip length 7 mm

Solder pin dimension 0.8 x 1.0 mm

Recommended pc board hole dia. Ø 1.3 mm

Solder pin length 4.5 mm

Pole size 2 - 3

Color green

Dimensions in mm 1 mm = 0.0394 in.

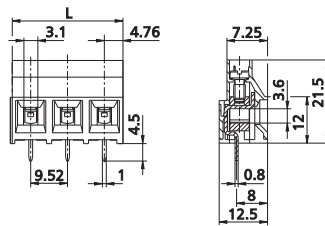

L = (pole size - 1) x centerline + 9.52 mm / 0.375 inches

Part numbers (P/N)

(informations: page 60)

Complete the part number by adding the pole size.

Type 703

centerline 9.52 mm / 0.375 inches

P/N 317031

	02	03				

■ Standard pole sizes

■ Available on demand. Minimum order quantity 5000 pieces per item.