



Headers

to **Type 009** and **Type 049**

Type 019 page 128

Type 020 page 129

Type 029 page 134

Type 030 page 135

Accessories

for **Type 009** and **Type 049**
Coding set
 716906 page 178

Note for wire range

Additional wire sizes and/or combinations of same size wires as follows:

Type 09

#(1) Wire range extended to No. 30 AWG for factory-wiring.

++ Two same size wires No. 22 - 18 AWG Cu Sol/Str for field-wiring; No. 30 - 18 AWG Cu Sol/Str factory-wiring.

Type 49

2 No. 22 - 18 AWG (field-wiring);
 2 No. 26 - 18 AWG or
 1 No. 26 - 14 AWG (factory-wiring)

Type 009

Screw type terminal block, pluggable, centerline
 5 mm / 0.197 inches, wire entry parallel to plug direction, wire protector, female contact

Technical Data

	V / A / AWG	300 / 15 / 22 - 12
	V / A / AWG	300 / 15 / 22 - 12
	0.08 - 2.5 mm ²	125 V / 2.5 kV / 10 A
	Insulation co-ordination according to IEC 664-1	
	Clearance and creepage distances	min. 1.9 mm
	Insulating material class	CTI 600
	Overvoltage category	III III II
	Pollution degree	3 2 2
	Rated voltage	125 320 320
	Rated test voltage	1.5 4 2.5
	Protection category according to IEC 529	IP00
	Tightening torque UL	7 lb-in max.
	Min. insul. strip length	6 mm
	Pole size	2 - 21
	Color	black

Type 049

Screw type terminal block, pluggable, centerline
 5 mm / 0.197 inches, wire entry parallel to plug direction, lift system, female contact

Technical Data

	V / A / AWG	300 / 15 / 22 - 12
	V / A / AWG	300 / 15 / 22 - 12
	0.08 - 2.5 mm ²	250 V / 4 kV / 10 A
	Insulation co-ordination according to IEC 664-1	
	Clearance and creepage distances	min. 4.7 mm
	Insulating material class	CTI 600
	Overvoltage category	III III II
	Pollution degree	3 2 2
	Rated voltage	320 800 800
	Rated test voltage	4 6 4
	Protection category according to IEC 529	IP20
	Tightening torque UL	7 lb-in max.
	Min. insul. strip length	6 mm
	Pole size	2 - 24
	Color	black

Dimensions in mm 1 mm = 0.0394 in.

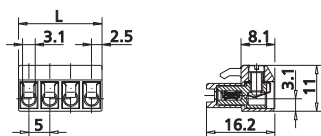

L = (pole size - 1) x centerline + 5 mm / 0.197 inches

Dimensions in mm 1 mm = 0.0394 in.

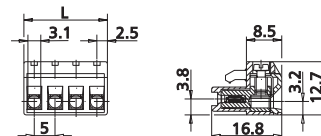

L = (pole size - 1) x centerline + 5 mm / 0.197 inches

Part numbers (P/N)

(informations: page 60)

Type 009

centerline 5 mm / 0.197 inches

P/N 310091

Complete the part number by adding the pole size.

	02	03	04	05	06	07	08
09	10	11	12	13	14	15	16
17	18	19	20	21			

- Standard pole sizes
- Available on demand. Minimum order quantity 5000 pieces per item.

Part numbers (P/N)

(informations: page 60)

Type 049

centerline 5 mm / 0.197 inches

P/N 310491

Complete the part number by adding the pole size.

	02	03	04	05	06	07	08
09	10	11	12	13	14	15	16
17	18	19	20	21	22	23	24

Type 049

centerline 10 mm / 0.394 inches

P/N 310492

	02	03	04	05	06	07	08
09	10	11	12				

- Standard pole sizes
- Available on demand. Minimum order quantity 5000 pieces per item.

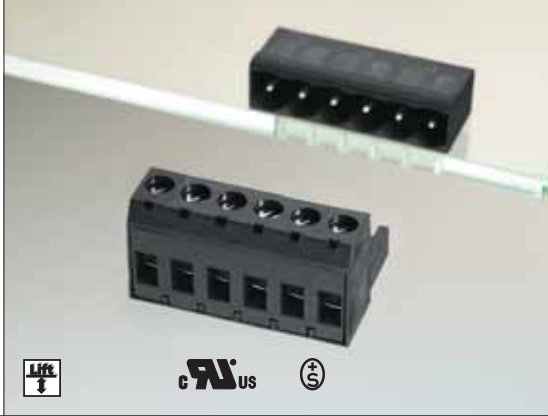

Headers

to Type 349 and Type 350

- Type 176 page 136
- Type 177 page 130
- Type 270 page 131
- Type 274 page 131
- Type 276 page 137
- Type 278 page 132
- Type 280 page 137
- Type 319 page 128
- Type 320 page 129
- Type 329 page 134
- Type 330 page 135

Accessories

for Type 349 and Type 350
(only in combination with headers type 176, 177, 319, 320, 329 and 330)
coding set
700025 page 180

Type 349

Screw type terminal block, pluggable, centerline 5 mm / 0.197 inches, wire entry parallel to plug direction, lift system, contact system with integrated wire protection

Technical Data

	V / A / AWG	300 / 16 / 28 - 12		
	0.08 - 2.5 mm ²	250 V / 4 kV / 12 A		
Insulation co-ordination according to IEC 664-1				
Clearance and creepage distances	min. 3.6 mm			
Insulating material class	CTI 600			
Overvoltage category	III	III	II	
Pollution degree	3	2	2	
Rated voltage	250	630	630	
Rated test voltage	2.5	6	4	
Protection category according to IEC 529	IP20			
Tightening torque UL	4.5 lb-in max.			
Min. insul. strip length	8 mm			
Pole size	2 - 24			
Color	black			

Type 350

Screw type terminal block, pluggable, centerline 5 mm / 0.197 inches, wire entry parallel to plug direction, lift system, contact system with integrated wire protection, strain relief

Technical Data

	V / A / AWG	300 / 16 / 28 - 12		
	0.08 - 4 mm ²	250 V / 4 kV / 12 A		
Insulation co-ordination according to IEC 664-1				
Clearance and creepage distances	min. 3.6 mm			
Insulating material class	CTI 600			
Overvoltage category	III	III	II	
Pollution degree	3	2	2	
Rated voltage	250	630	630	
Rated test voltage	2.5	6	4	
Protection category according to IEC 529	IP20			
Tightening torque UL	4.5 lb-in max.			
Min. insul. strip length	8 mm			
Pole size	3 - 12			
Color	black			

Dimensions in mm 1 mm = 0.0394 in.

Dimensions in mm 1 mm = 0.0394 in.

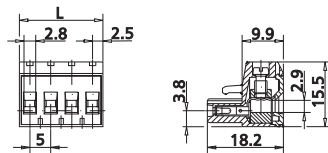

L = (pole size - 1) x centerline + 5 mm / 0.197 inches

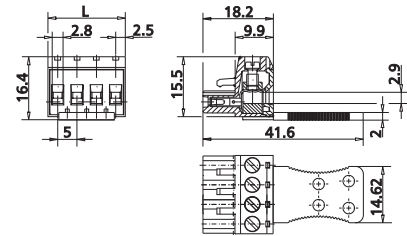

L = (pole size - 1) x centerline + 5 mm / 0.197 inches

Part numbers (P/N)

(informations: page 60)

Type 349

centerline 5 mm / 0.197 inches

P/N 313491

	02	03	04	05	06	07	08
	09	10	11	12	13	14	15
	17	18	19	20	21	22	23
	24						

Type 349

centerline 10 mm / 0.394 inches

P/N 313492

	02	03	04	05	06	07	08
	09	10	11	12			

Standard pole sizes

Available on demand. Minimum order quantity 5000 pieces per item.

Part numbers (P/N)

(informations: page 60)

Type 350

centerline 5 mm / 0.197 inches

P/N 313501

Complete the part number by adding the pole size.

		03	04	05	06	07	08
	09	10	11	12			

* approval pending

Standard pole sizes

Available on demand. Minimum order quantity 5000 pieces per item.



Headers

to Type 351

Type 335 page 130

Type 336 page 136

Accessories

for Type 351

coding set
700025 page 180

Type 351

Screw type terminal block, pluggable, centerline 5 mm / 0.197 inches, wire entry parallel to plug direction, lift system, contact system with integrated wire protection, with mounting flange

Technical Data

V / A / AWG 300 / 16 / 28 - 12

0.08 - 2.5 mm² 250 V / 4 kV / 12 A

Insulation co-ordination according to IEC 664-1

Clearance and creepage distances min. 3.6 mm

Insulating material class CTI 600

Overvoltage category III III II

Pollution degree 3 2 2

Rated voltage 250 630 630

Rated test voltage 2.5 6 4

Protection category according to IEC 529 IP20

Tightening torque UL 4.5 lb-in max.

Min. insul. strip length 8 mm

Pole size 2 - 24

Color black

Dimensions in mm

1 mm = 0.0394 in.

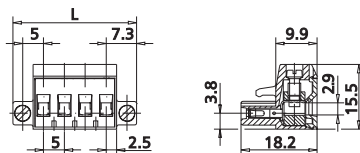

L = (pole size - 1) x centerline + 14.6 mm / 0.575 inches

Part numbers (P/N)

(informations: page 60)

Complete the part number by adding the pole size.

Type 351

centerline 5 mm / 0.197 inches

P/N 313511

	02	03	04	05	06	07	08
09	10	11	12	13	14	15	16
17	18	19	20	21	22	23	24

Type 351

centerline 10 mm / 0.394 inches

P/N 313512

	02	03	04	05	06	07	08
09	10	11	12				

Standard pole sizes

Available on demand. Minimum order quantity 5000 pieces per item.