

Terminal blocks

to Type 229

- ASP046 page 53
- Type 213 page 102
- Type 214 page 102
- Type 249 page 100
- Type 250 page 100

Accessories

for Type 229
Coding set
700024 page 180

Type 229

Header, centerline 5.08 mm / 0.200 inches, horizontal mounting, square contact pins 1 mm / 0.039 inches, open ends, codable

Technical Data

	V / A	300 / 15
	V / A	300 / 15
		250 V / 4 kV / 10 A

Insulation co-ordination according to IEC 664-1			
Clearance and creepage distances	min. 4.08 mm		
Insulating material class	CTI 600		
Overvoltage category	III	III	II
Pollution degree	3	2	2
Rated voltage	320	800	800
Rated test voltage	4	6	4
Protection category according to IEC 529	IP00		
Solder pin dimension	1.0 x 1.0 mm		
Recommended pc board hole dia.	Ø 1.5 mm		
Solder pin length	3.45 mm		
Pole size	2 - 24		
Color	black		

Dimensions in mm 1 mm = 0.0394 in.

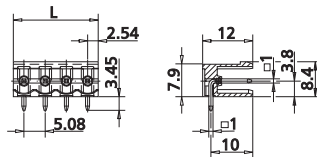

$L = (\text{pole size} - 1) \times \text{centerline} + 5.08 \text{ mm} / 0.200 \text{ inches}$

Part numbers (P/N)

(informations: page 111)

Complete the part number by adding the pole size.

Type 229

centerline 5.08 mm / 0.200 inches

P/N 312291

	02	03	04	05	06	07	08
09	10	11	12	13	14	15	16
17	18	19	20	21	22	23	24

Type 229

centerline 10.16 mm / 0.400 inches

P/N 312292

	02	03	04	05	06	07	08
09	10	11	12				

- Standard pole sizes
- Available on demand. Minimum order quantity 5000 pieces per item.