

Type 171

Screw type terminal block, solderable, centerline 7.5 mm / 0.295 inches, horizontal wire entry, wire protector

Technical Data

RIA V / A / AWG 300 / 15 / 26 - 14

SP V / A / AWG 300 / 15 / 26 - 14

CE 0.12 - 2.5 mm² 500 V / 6 kV / 16 A

Insulation co-ordination according to IEC 664-1

Clearance and creepage distances min. 5.8 mm

Insulating material class CTI 600

Overvoltage category III III II

Pollution degree 3 2 2

Rated voltage 400 1000 1000

Rated test voltage 4 8 6

Protection category according to IEC 529 IP20

Tightening torque UL 7 lb-in max.

Min. insul. strip length 8 mm

Solder pin dimension 1 mm

Recommended pc board hole dia. Ø 1.3 mm

Solder pin length 3 mm

Pole size 2 - 12

Color black

Dimensions in mm 1 mm = 0.0394 in.

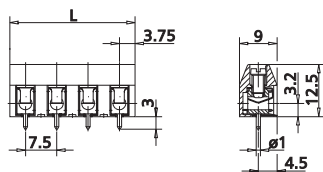

L = (pole size - 1) x centerline + 7.5 mm / 0.295 inches

Type 175

Screw type terminal block, solderable, centerline 7.5 mm / 0.295 inches, horizontal wire entry, wire protector

Technical Data

RIA^{us} V / A / AWG 300 / 20 / 22 - 12

CE 0.33 - 2.5 mm² 500 V / 4 kV / 16 A

Insulation co-ordination according to IEC 664-1

Clearance and creepage distances min. 6.5 mm

Insulating material class CTI 600

Overvoltage category III III II

Pollution degree 3 2 2

Rated voltage 500 1250 1250

Rated test voltage 4 8 6

Protection category according to IEC 529 IP20

Tightening torque UL 6 lb-in max.

Min. insul. strip length 8 mm

Solder pin dimension 0.8 x 1.0 mm

Recommended pc board hole dia. Ø 1.4 mm

Solder pin length 4.1 mm

Pole size 2 - 12

Color black

Dimensions in mm 1 mm = 0.0394 in.

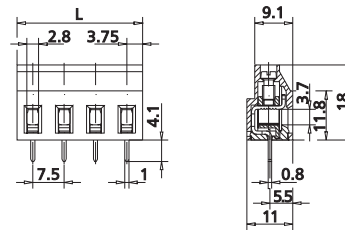

L = (pole size - 1) x centerline + 7.5 mm / 0.295 inches

Part numbers (P/N)

(informations: page 60)

Complete the part number by adding the pole size.

Type 171

centerline 7.5 mm / 0.295 inches

P/N 311711

| | | | | | | | |
|--------------------------|----|----|----|----|----|----|----|
| | 02 | 03 | 04 | 05 | 06 | 07 | 08 |
| <input type="checkbox"/> | 09 | 10 | 11 | 12 | | | |

Part numbers (P/N)

(informations: page 60)

Complete the part number by adding the pole size.

Type 175

centerline 7.5 mm / 0.295 inches

P/N 311751

| | | | | | | | |
|--------------------------|----|----|----|----|----|----|----|
| | 02 | 03 | 04 | 05 | 06 | 07 | 08 |
| <input type="checkbox"/> | 09 | 10 | 11 | 12 | | | |

Standard pole sizes

Available on demand. Minimum order quantity 5000 pieces per item.

Standard pole sizes

Available on demand. Minimum order quantity 5000 pieces per item.