

Note for wire range

Additional wire sizes and/or combinations of same size wires as follows:

Type 105

- ### 2 No. 22 - 20 AWG (field-wiring);
- 2 No. 30 - 20 AWG or
- 1 No. 30 - 18 AWG (factory-wiring)

Type 105

Screw type terminal block, solderable, centerline 3.5 mm / 0.138 inches, wire entry 45°, wire protector

Technical Data

	V / A / AWG	300 / 10 / 22 - 18
	V / A / AWG	300 / 10 / 22 - 18
	0.33 - 1 mm ²	130 V / 2.5 kV / 10 A

Insulation co-ordination according to IEC 664-1			
Clearance and creepage distances	min. 2.1 mm		
Insulating material class	CTI 600		
Overvoltage category	III	III	II
Pollution degree	3	2	2
Rated voltage	160	400	400
Rated test voltage	2.5	4	2.5
Protection category according to IEC 529	IP00		
Tightening torque UL	3 lb-in max.		
Min. insul. strip length	5 mm		
Solder pin dimension	0.9 mm		
Recommended pc board hole dia.	Ø 1.2 mm		
Solder pin length	3.7 mm		
Pole size	2 - 16		
Color	black		

Dimensions in mm 1 mm = 0.0394 in.

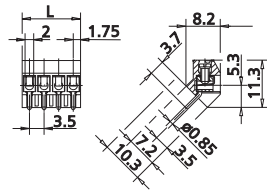

L = (pole size - 1) x centerline + 3.5 mm / 0.138 inches

Type 305

Screw type terminal block, solderable, centerline 3.5 mm / 0.138 inches, wire entry 55°, lift system

Technical Data

	V / A / AWG	300 / 6 / 28 - 16
	0.08 - 1.0 mm ²	160 V / 2.5 kV / 10 A

Insulation co-ordination according to IEC 664-1			
Clearance and creepage distances	min. 2.6 mm		
Insulating material class	CTI 600		
Overvoltage category	III	III	II
Pollution degree	3	2	2
Rated voltage	200	500	500
Rated test voltage	2.5	4	2.5
Protection category according to IEC 529	IP20		
Tightening torque UL	3 lb-in max.		
Min. insul. strip length	5 mm		
Solder pin dimension	0.5 x 0.9 mm		
Recommended pc board hole dia.	Ø 1.1 mm		
Solder pin length	3.5 mm		
Pole size	2 - 24		
Color	black		

Dimensions in mm 1 mm = 0.0394 in.

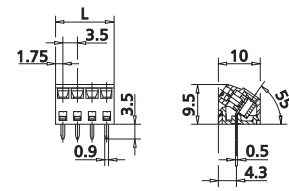

L = (pole size - 1) x centerline + 3.5 mm / 0.138 inches

Part numbers (P/N)

(informations: page 60)

Type 105

centerline 3.5 mm / 0.138 inches

P/N 311051

	02	03	04	05	06	07	08
	09	10	11	12	13	14	15
	16						

Complete the part number by adding the pole size.

Part numbers (P/N)

(informations: page 60)

Type 305

centerline 3.5 mm / 0.138 inches

P/N 313051

	02	03	04	05	06	07	08
	09	10	11	12	13	14	15
	17	18	19	20	21	22	23
	24						

Complete the part number by adding the pole size.

Standard pole sizes

Available on demand. Minimum order quantity 5000 pieces per item.

Standard pole sizes

Available on demand. Minimum order quantity 5000 pieces per item.