

Note for wire range

Additional wire sizes and/or combinations of same size wires as follows:

- Type 15**
- # 2 No. 22 - 18 AWG (field-wiring);
 - 2 No. 30 - 18 AWG or
 - 1 No. 30 - 14 AWG (factory-wiring)

Type 101

Screw type terminal block, solderable, centerline 5.08 mm / 0.200 inches, horizontal wire entry, wire protector

Technical Data

	V / A / AWG	300 / 15 / 28 - 14
	V / A / AWG	300 / 15 / 28 - 14
	0.08 - 1.5 mm ²	125 V / 2.5 kV / 13 A

Insulation co-ordination according to IEC 664-1

Clearance and creepage distances	min. 2.7 mm		
Insulating material class	CTI 600		
Overvoltage category	III	III	II
Pollution degree	3	2	2
Rated voltage	200	500	500
Rated test voltage	2.5	4	2.5

Protection category according to IEC 529

Tightening torque UL	7 lb-in max.
Min. insul. strip length	6 mm
Solder pin dimension	0.9 mm
Recommended pc board hole dia.	Ø 1.3 mm
Solder pin length	3.8 mm
Pole size	2 - 22
Color	black

Dimensions in mm 1 mm = 0.0394 in.

Type 015

Screw type terminal block, solderable, centerline 5.08 mm / 0.200 inches, horizontal wire entry, lift system, modular

Technical Data

	V / A / AWG	300 / 15 / 22 - 14
	V / A / AWG	300 / 15 / 22 - 14
	0.33 - 1.5 mm ²	250 V / 4 kV / 13 A

Insulation co-ordination according to IEC 664-1

Clearance and creepage distances	min. 3.9 mm		
Insulating material class	CTI 600		
Overvoltage category	III	III	II
Pollution degree	3	2	2
Rated voltage	250	630	630
Rated test voltage	2.5	6	4

Protection category according to IEC 529

Tightening torque UL	8 lb-in max.
Min. insul. strip length	7 mm
Solder pin dimension	0.8 x 1.0 mm
Recommended pc board hole dia.	Ø 1.4 mm
Solder pin length	4.1 mm
Pole size	2 - 3
Color	black

Dimensions in mm 1 mm = 0.0394 in.

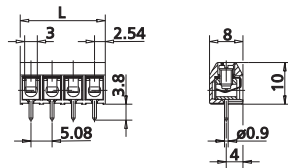

L = (pole size - 1) x centerline + 5.08 mm / 0.200 inches

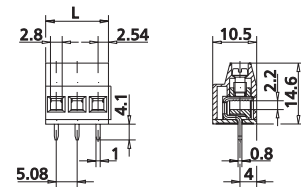

L = (pole size - 1) x centerline + 5.08 mm / 0.200 inches

Part numbers (P/N)

(informations: page 60)

Type 101

centerline 5.08 mm / 0.200 inches

P/N 311011

	02	03	04	05	06	07	08
	09	10	11	12	13	14	15
	17	18	19	20	21	22	

Part numbers (P/N)

(informations: page 60)

Type 015

centerline 5.08 mm / 0.200 inches

P/N 310151

Complete the part number by adding the pole size.

	02	03				

- Standard pole sizes
- Available on demand. Minimum order quantity 5000 pieces per item.

- Standard pole sizes
- Available on demand. Minimum order quantity 5000 pieces per item.

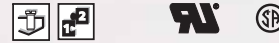
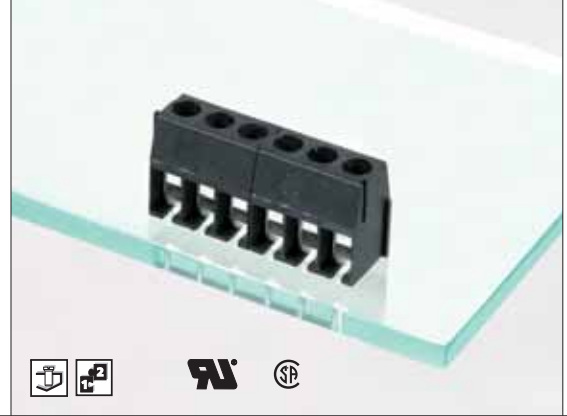
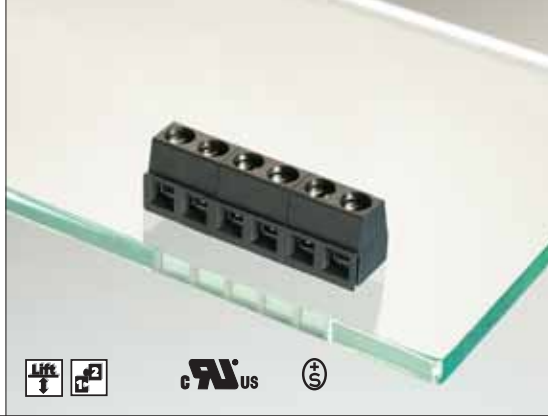



Type 095 is modular to Type 093

Type 095

Screw type terminal block, solderable, centerline 5.08 mm / 0.200 inches, horizontal wire entry, lift system, modular

Technical Data

 V / A / AWG	300 / 10 / 26 - 16		
 0.12 - 1 mm ²	250 V / 4 kV / 10 A		
Insulation co-ordination according to IEC 664-1			
Clearance and creepage distances	min. 3.2 mm		
Insulating material class	CTI 600		
Overvoltage category	III	III	II
Pollution degree	3	2	2
Rated voltage	250	630	630
Rated test voltage	2.5	6	4
Protection category according to IEC 529	IP20		
Tightening torque UL	7 lb-in max.		
Min. insul. strip length	6 mm		
Solder pin dimension	0.5 x 1.0 mm		
Recommended pc board hole dia.	Ø 1.3 mm		
Solder pin length	3.2 mm		
Pole size	2 - 3		
Color	black		

Dimensions in mm 1 mm = 0.0394 in.

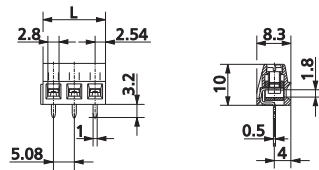



$L = (\text{pole size} - 1) \times \text{centerline} + 5.08 \text{ mm} / 0.200 \text{ inches}$

Type 083

Screw type terminal block, solderable, centerline 5.08 mm / 0.197 inches, horizontal wire entry, wire protector, modular

Technical Data

 V / A / AWG	300 / 20 / 22 - 14		
 V / A / AWG	300 / 20 / 22 - 14		
Insulation co-ordination according to IEC 664-1			
Clearance and creepage distances	min. 3.9 mm		
Insulating material class	CTI 600		
Overvoltage category	III	III	II
Pollution degree	3	2	2
Rated voltage	250	630	630
Rated test voltage	2.5	6	4
Protection category according to IEC 529	IP20		
Tightening torque UL	7 lb-in max.		
Min. insul. strip length	8 mm		
Solder pin dimension	0.9 mm		
Recommended pc board hole dia.	Ø 1.3 mm		
Solder pin length	4 mm		
Pole size	2 - 3		
Color	black		

Dimensions in mm 1 mm = 0.0394 in.

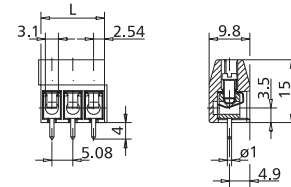

$L = (\text{pole size} - 1) \times \text{centerline} + 5.08 \text{ mm} / 0.200 \text{ inches}$

Part numbers (P/N)

(informations: page 60)

Complete the part number by adding the pole size.

Type 095

centerline 5.08 mm / 0.200 inches

P/N 310951

		02	03						

Part numbers (P/N)

(informations: page 60)

Complete the part number by adding the pole size.

Type 083

centerline 5.08 mm / 0.200 inches

P/N 310831

		02	03						

Standard pole sizes

Available on demand. Minimum order quantity 5000 pieces per item.

Standard pole sizes

Available on demand. Minimum order quantity 5000 pieces per item.

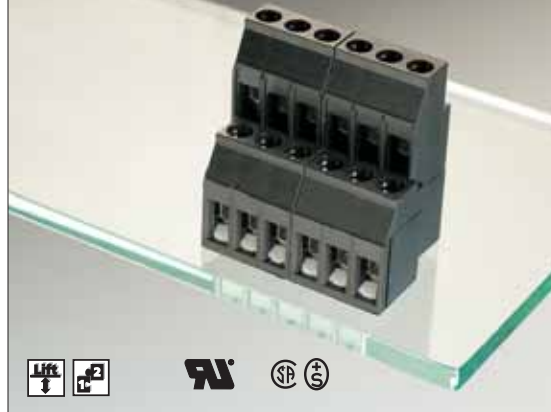
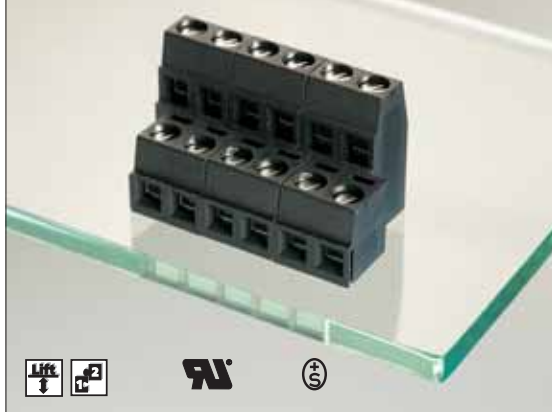

Accessories

for Type 093
Cover
711401 page 181

Type 093 is modular to Type 095

Note for wire range

Additional wire sizes and/or combinations of same size wires as follows:

- Type 97**
- ## 2 No. 22 - 16 AWG (field-wiring);
 - 2 No. 30 - 16 AWG or
 - 1 No. 30 - 12 AWG (factory-wiring)

Type 093

Screw type terminal block, solderable, centerline 5.08 mm / 0.200 inches, horizontal wire entry, lift system, modular, two-tier terminal block

Technical Data

	V / A / AWG	300 / 10 / 26 - 16
	0.12 - 1.5 mm ²	160 V / 4 kV / 13.5 A
Insulation co-ordination according to IEC 664-1		
Clearance and creepage distances	min. 3.2 mm	
Insulating material class	CTI 600	
Overvoltage category	III	III II
Pollution degree	3	2 2
Rated voltage	250	630 630
Rated test voltage	2.5	6 4
Protection category according to IEC 529	IP20	
Tightening torque UL	7 lb-in max.	
Min. insul. strip length	6 mm	
Solder pin dimension	2 x 0.5 x 1.0 mm	
Recommended pc board hole dia.	Ø 1.3 mm	
Solder pin length	3.2 mm	
Pole size	4 - 16	
Color	black	

Dimensions in mm 1 mm = 0.0394 in.

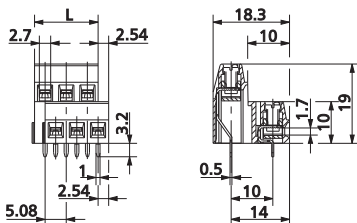

$L = (\text{pole size} - 1) \times \text{centerline} + 5.08 \text{ mm} / 0.200 \text{ inches}$

Type 097

Screw type terminal block, solderable, centerline 5.08 mm / 0.200 inches, horizontal wire entry, lift system, modular, two-tier terminal block

Technical Data

	V / A / AWG	300 / 20 / 22 - 12
	V / A / AWG	300 / 20 / 22 - 12
	0.33 - 2.5 mm ²	250 V / 4 kV / 16 A
Insulation co-ordination according to IEC 664-1		
Clearance and creepage distances	min. 4 mm	
Insulating material class	CTI 600	
Overvoltage category	III	III II
Pollution degree	3	2 2
Rated voltage	320	800 800
Rated test voltage	4	6 4
Protection category according to IEC 529	IP20	
Tightening torque UL	6 lb-in max.	
Min. insul. strip length	6 mm	
Solder pin dimension	2 x 0.8 x 1.0 mm	
Recommended pc board hole dia.	Ø 1.4 mm	
Solder pin length	5 and 4 mm	
Pole size	4 - 6	
Color	black	

Dimensions in mm 1 mm = 0.0394 in.

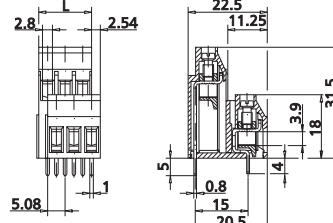

$L = (\text{pole size} - 1) \times \text{centerline} + 5.08 \text{ mm} / 0.200 \text{ inches}$

Part numbers (P/N)

(informations: page 60)

Type 093

centerline 5.08 mm / 0.200 inches

P/N 310931

Complete the part number by adding the pole size.

	04	06	08	10	12	14	16
<input type="checkbox"/>							

Part numbers (P/N)

(informations: page 60)

Type 097

centerline 5.08 mm / 0.200 inches

P/N 310971

Complete the part number by adding the pole size.

	04	06			
<input type="checkbox"/>					

- Standard pole sizes
- Available on demand. Minimum order quantity 5000 pieces per item.

- Standard pole sizes
- Available on demand. Minimum order quantity 5000 pieces per item.



Note for wire range

Additional wire sizes and/or combinations of same size wires as follows:

Type 73

- ## 2 No. 22 - 16 AWG (field-wiring);
- 2 No. 30 - 16 AWG or
- 1 No. 30 - 12 AWG (factory-wiring)

Type 073

Screw type terminal block, solderable, centerline 5.08 mm / 0.200 inches, horizontal wire entry, lift system, modular

Technical Data

UL V / A / AWG 300 / 20 / 22 - 12

SP V / A / AWG 300 / 20 / 22 - 12

CS 0.33 - 2.5 mm² 250 V / 4 kV / 16 A

Insulation co-ordination according to IEC 664-1

Clearance and creepage distances	min. 4 mm		
Insulating material class	CTI 600		
Overvoltage category	III	III	II
Pollution degree	3	2	2
Rated voltage	320	800	800
Rated test voltage	4	6	4
Protection category according to IEC 529	IP20		
Tightening torque UL	6 lb-in max.		
Min. insul. strip length	8 mm		
Solder pin dimension	0.8 x 1.0 mm		
Recommended pc board hole dia.	Ø 1.4 mm		
Solder pin length	4.1 mm		
Pole size	2 - 3		
Color	black		

Dimensions in mm 1 mm = 0.0394 in.

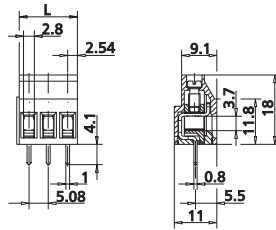

L = (pole size - 1) x centerline + 5 mm / 0.197 inches

Part numbers (P/N)

(informations: page 60)

Type 073

centerline 5.08 mm / 0.200 inches

Complete the part number by adding the pole size.

P/N 310731

		02	03						

- Standard pole sizes
- Available on demand. Minimum order quantity 5000 pieces per item.