

Note for wire range

Additional wire sizes and/or combinations of same size wires as follows:

Type 63

#(1) Wire range extended to No. 30 AWG for factory-wiring

++ Two same size wires No. 22 - 18 AWG Cu Sol/Str for field-wiring; 30 - 18 AWG Cu Sol/Str factory-wiring

Type 147

#(1) Wire range extended to No. 30 AWG for factory-wiring

+ Two same size wires No. 22 - 16 AWG Cu Sol/Str for field-wiring; 30 - 16 AWG Cu Sol/Str factory-wiring

Type 063

Screw type terminal block, solderable, centerline 5 mm / 0.197 inches, vertical wire entry, wire protector

Technical Data

	V / A / AWG	300 / 15 / 22 - 14
	V / A / AWG	300 / 15 / 22 - 14
	0.33 - 1.5 mm ²	125 V / 2.5 kV / 13 A

Insulation co-ordination according to IEC 664-1

Clearance and creepage distances	min. 2.6 mm		
Insulating material class	CTI 600		
Overvoltage category	III	III	II
Pollution degree	3	2	2
Rated voltage	200	500	500
Rated test voltage	2.5	4	2.5

Protection category according to IEC 529	IP00		
Tightening torque UL	7 lb-in max.		
Min. insul. strip length	6 mm		
Solder pin dimension	0.9 mm		
Recommended pc board hole dia.	Ø 1.3 mm		
Solder pin length	3.4 mm		
Pole size	2 - 22		
Color	grey		

Dimensions in mm 1 mm = 0.0394 in.

Type 147

Screw type terminal block, solderable, centerline 5 mm / 0.197 inches, vertical wire entry, wire protector

Technical Data

	V / A / AWG	300 / 15 / 22 - 14
	V / A / AWG	300 / 15 / 22 - 14
	0.33 - 1.5 mm ²	250 V / 4 kV / 10 A

Insulation co-ordination according to IEC 664-1

Clearance and creepage distances	min. 4 mm		
Insulating material class	CTI 600		
Overvoltage category	III	III	II
Pollution degree	3	2	2
Rated voltage	320	800	800
Rated test voltage	4	6	4

Protection category according to IEC 529	IP20		
Tightening torque UL	7 lb-in max.		
Min. insul. strip length	8 mm		
Solder pin dimension	1 mm		
Recommended pc board hole dia.	Ø 1.3 mm		
Solder pin length	3.25 mm		
Pole size	2 - 24		
Color	black		

Dimensions in mm 1 mm = 0.0394 in.

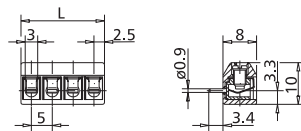

L = (pole size - 1) x centerline + 5 mm / 0.197 inches

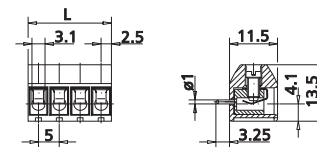

L = (pole size - 1) x centerline + 5 mm / 0.197 inches

Part numbers (P/N)

(informations: page 60)

Complete the part number by adding the pole size.

Type 063

centerline 5 mm / 0.197 inches

P/N 310631

02	03	04	05	06	07	08	
09	10	11	12	13	14	15	16
17	18	19	20	21	22		

Type 063

centerline 10 mm / 0.394 inches

P/N 310632

02	03	04	05	06	07	08
09	10	11				

- Standard pole sizes
- Available on demand. Minimum order quantity 5000 pieces per item.

Part numbers (P/N)

(informations: page 60)

Complete the part number by adding the pole size.

Type 147

centerline 5 mm / 0.197 inches

P/N 311471

02	03	04	05	06	07	08	
09	10	11	12	13	14	15	16
17	18	19	20	21	22	23	24

Type 147

centerline 10 mm / 0.394 inches

P/N 311472

02	03	04	05	06	07	08
09	10	11	12			

- Standard pole sizes
- Available on demand. Minimum order quantity 5000 pieces per item.