



CONTACT • REQUEST A QUOTE

PRODUCTS

RESOURCES

COMPANY

PART NUMBER SEARCH

search site



« Clamping Knobs

Three Arm Clamping Knobs

Series #3036

Clamping knobs are available in different materials, thermoplastic, and phenolic for a multiple of applications.

A variety of shapes and diameters with plain, tapped bosses or with studs are available with standard threads to fit the application.

Perfect for the industrial machinery, medical, general equipment and other industrial applications.

Knobs can be decorated or customized to your specific need.

Davies Molding is pleased to introduce our series of soft touch knobs and handles. Our soft touch parts are molded with a soft thermoplastic overmolded "rubber" top with a tough thermoplastic body underneath. The soft feel of the knob provides a comfortable touch with a sure grip.

Colors available upon request.

Please note: Not all variations available are listed below. Please [contact Customer Service](#) to inquire about all available options.

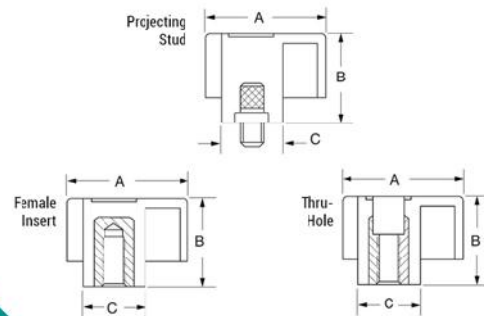

REQUEST CAD DRAWING

REQUEST A QUOTE

Item #	Diameter A	Height B	Hub C	Material Type	Mounting Diameter	Mounting Type	Thread Length/Depth	Color
3036	1.5	0.875	0.625	Thermoplastic	1/4-20	Female Insert	0.50	BLACK
3036-A	1.5	0.875	0.625	Thermoplastic	5/16-18	Female Insert	0.50	BLACK
3036-C	1.5	0.875	0.625	Thermoplastic	1/4-20	Projecting Stud	0.56	BLACK
3036-D	1.5	0.875	0.625	Thermoplastic	5/16-18	Projecting Stud	0.50	BLACK
3036-E	1.5	0.875	0.625	Thermoplastic	3/8-16	Projecting Stud	1.00	BLACK
3036-F	1.5	0.875	0.625	Thermoplastic	5/16-18	Thru-Hole		BLACK
3036-H	1.5	0.875	0.625	Thermoplastic	5/16-18	Thru-Hole		BLACK
3036-L	1.5	0.875	0.625	Thermoplastic	1/4-20	Thru-Hole		BLACK
3036-M	1.5	0.875	0.625	Thermoplastic	1/4-20	Projecting Stud	1.25	BLACK
3036-P	1.5	0.875	0.625	Thermoplastic	3/8-16	Thru-Hole		BLACK
3036-Q	1.5	0.875	0.625	Thermoplastic	1/4-20	Projecting Stud	1.125	BLACK
3036-W	1.5	0.875	0.625	Thermoplastic	5/16-18	Projecting Stud	1.25	BLACK
3036-X	1.5	0.875	0.625	Thermoplastic	1/4-20	Projecting Stud	2	BLACK
3036-Y	1.5	0.875	0.625	Thermoplastic	5/16-18	Projecting Stud	0.75	BLACK
3036-Z	1.5	0.875	0.625	Thermoplastic	5/16-18	Thru-Hole		WHITE

3036AA	1.5	0.875	0.625	Thermoplastic	1/4-20	Projecting Stud	1.50	BLACK
3036AB	1.5	0.875	0.625	Thermoplastic	1/4-20	Projecting Stud	1.00	BLACK
3036AD	1.5	0.875	0.625	Thermoplastic	1/4-20	Projecting Stud	1.75	BLACK
3036AH	1.5	0.875	0.625	Thermoplastic	1/4-20	Projecting Stud	0.75	BLACK
3036AJ	1.5	0.875	0.625	Thermoplastic	3/8-16	Projecting Stud	2.50	BLACK

PRODUCTS

- Knobs
- Handles
- Leveling Feet
- Latches
- Hinges
- Indexing Plungers
- Electronic Enclosures
- Two-Shot / Soft Touch
- Frac Balls
- Custom Molding

RESOURCES

- Engineering Specifications
- Distributor Listing
- Sales Representative Listing

COMPANY

- About Us
- Capabilities
- Certifications
- Contact Us
- Blog
- Careers

QUESTIONS ?

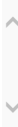
Copyright © 2016 Davies Molding, LLC. All Rights Reserved.
 350 Kehoe Blvd. | Carol Stream, IL 60188-1818 | Phone: (800) 554-9208 | Fax: (630) 510-9944