

MICRO SWITCH

FREERPORT, ILLINOIS, U.S.A.
A DIVISION OF HONEYWELL
FED. MFG. CODE 91929

SWITCH-TOGGLE

CATALOG LISTING
2TL1-72 SERIES
CHART 1

MILITARY STANDARD NUMBER

CATALOG LISTING

AVAILABLE LOCKING COMBINATIONS FOR CONFIGURATION SEE LETTERED DETAILS

STYLE NUMBER

MILITARY RATING (AMPS)

RESISTIVE LOAD		LAMP LOAD		INDUCTIVE LOAD	
DC VOLTS	AC VOLTS	28 VDC	125 VAC	28 VDC	125 VAC
28	125	.5	11	6	8

THIS DRAWING COVERS A PROPRIETARY ITEM AND IS THE PROPERTY OF MICRO SWITCH, A DIVISION OF HONEYWELL. THIS DRAWING IS NOT TO BE COPIED OR USED WITHOUT THE APPROVAL OF MICRO SWITCH.

27407-3

2TL1-72

NONE

1

27408-3 ⁶

2TL1-72 ⁶

E, L, N

2

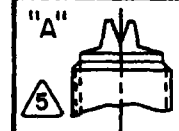

LOCKED IN THREE POSITIONS

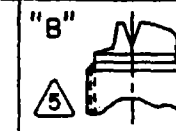

LOCKED IN CENTER AND EXTREME POSITION (KEYWAY SIDE)

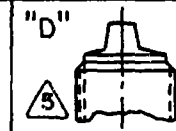

LOCKED OUT OF CENTER POSITION

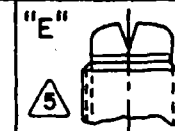

LOCKED IN CENTER POSITION

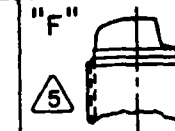

LOCKED IN EXTREME POSITION (OPPOSITE KEYWAY)

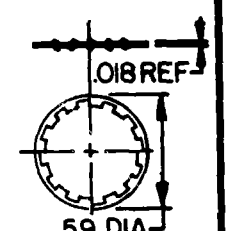

LOCKWASHER

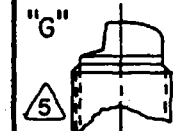

LOCKED IN EXTREME POSITION (KEYWAY SIDE)

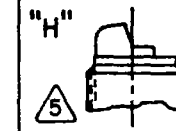

LOCKED OUT OF CENTER AND EXTREME POSITION (KEYWAY SIDE)

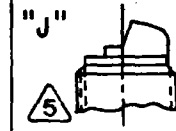

LOCKED OUT OF CENTER AND EXTREME POSITION (OPPOSITE KEYWAY)

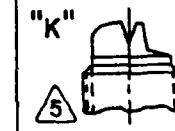

LOCKED IN CENTER AND EXTREME POSITION (OPPOSITE KEYWAY)

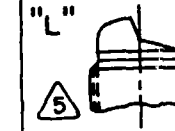

LOCKED OUT OF EXTREME POSITION (KEYWAY SIDE)

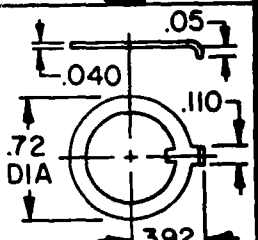

LOCKING RING

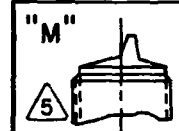

LOCKED OUT OF AND INTO EXTREME POSITION (OPPOSITE KEYWAY)

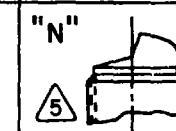

LOCKED OUT OF EXTREME POSITION (OPPOSITE KEYWAY)

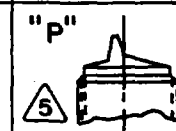

LOCKED OUT OF AND INTO EXTREME POSITION (KEYWAY SIDE)

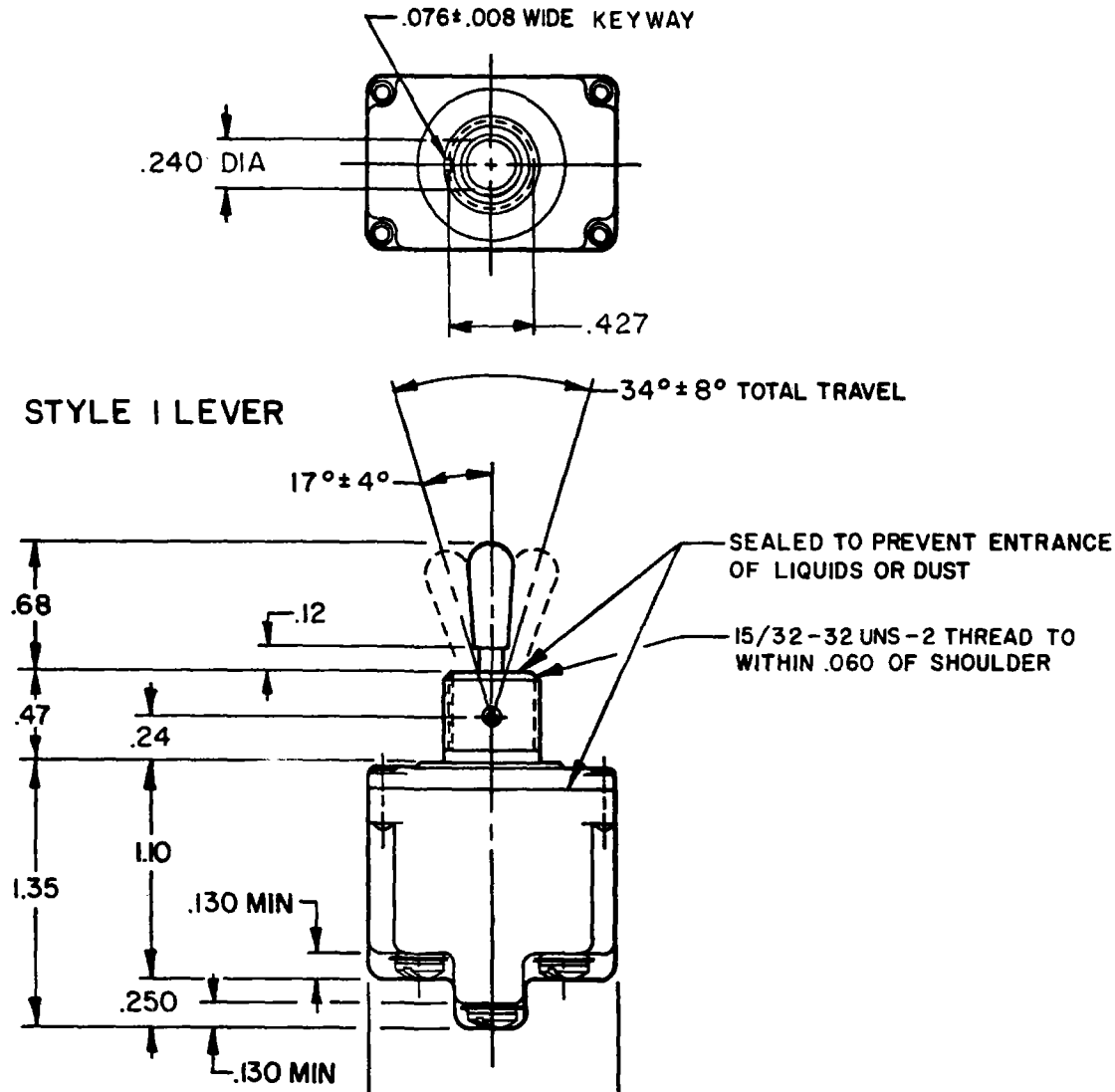

CIRCUIT MADE WITH TOGGLE LEVER IN

KEYWAY SIDE	CENTER	OPPOSITE KEYWAY
MOMENTARY POSITION	MAINTAINED POSITION	MOMENTARY POSITION

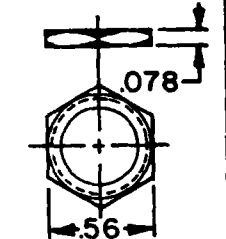

HEX NUT (2)

6-32 UNC X .260 REF BINDING HEAD TERMINAL SCREW AND LOCKWASHER (SEMS) ONE PER TERMINAL ³

NOTES

- SWITCHES ARE CAPABLE OF WITHSTANDING A TEMPERATURE OF 160°F CONTINUOUSLY AT FULL RATED LOAD
- CIRCUIT DESIGNATION, MICRO SWITCH CATALOG LISTING, AND MS NUMBER MARKED ON SIDE OF SWITCH
- ³ FURNISHED UNASSEMBLED
- FOR TERMINAL COVER SEE MICRO SWITCH CAT. LIST. 5PA8
- ⁵ KEYWAY SHOWN ON LEFT SIDE
- ⁶ SUFFIX LETTER MUST BE ADDED FOR DESIRED TYPE OF TOGGLE LOCKING. SEE CHART FOR AVAILABLE LOCKING COMBINATIONS
- THESE SWITCHES ARE QUALIFIED UNDER MIL-S-3950

SCALE FULL
DO NOT SCALE PRINT
UNLESS OTHERWISE NOTED
DIMENSIONS ARE IN INCHES
TOLERANCES ARE:
ONE PLACE (.0) ±.030
TWO PLACE (.00) ±.015
THREE PLACE (.000) ±.005
ANGLES ±.005
WEIGHT .15 LB APPROX

10A-125,250 OR 277VAC
1/4HP-125VAC; 1/2HP-250,277VAC
3A-125VAC "L" CODE L192

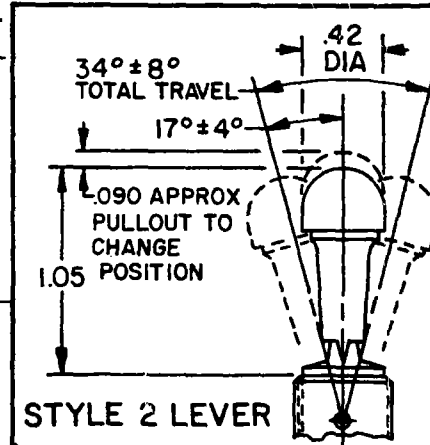

STYLE 2 LEVER

CATALOG LISTING 2TL1-72 SERIES CHART 1
 ISSUE 4
 REVISIONS:
 A CO 20 APR 84
 B CO 94432 23 NOV 99
 C 0003011 KRB 05 FEB 04
 CHECK 06 FEB 04
 CHECK 23 JUN 04
 CHECK 10 JUN 94
 FORMTEK DRAWN
 KDR 10 JUN 94
 RELEASE NO. CO-78465 REPLACES 2TL1-72 SERIES PAGE 1 OF 1