

GSD

2431-87-* (SHEET 1 OF 2)

REVISIONS

REVISION	CHANGES
0	ER 36807 VLS 02/07/96
1	CN 36939 A KH 04/23/96

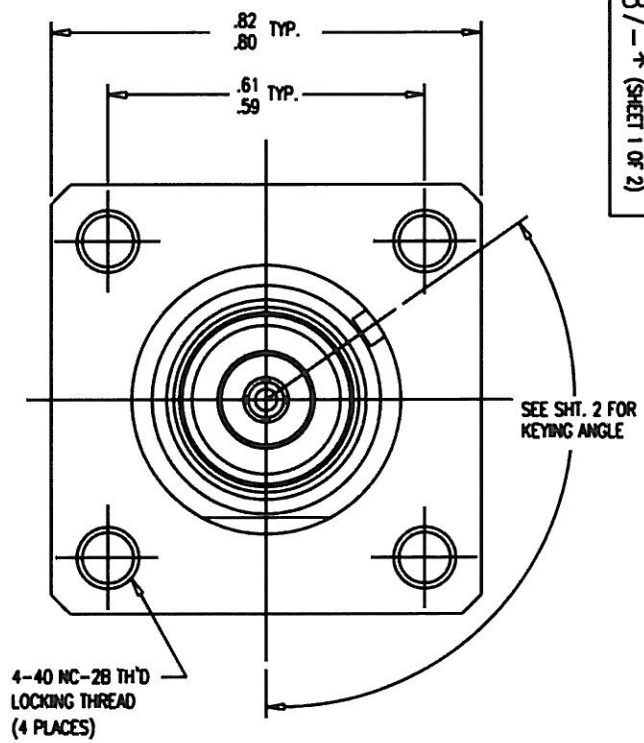
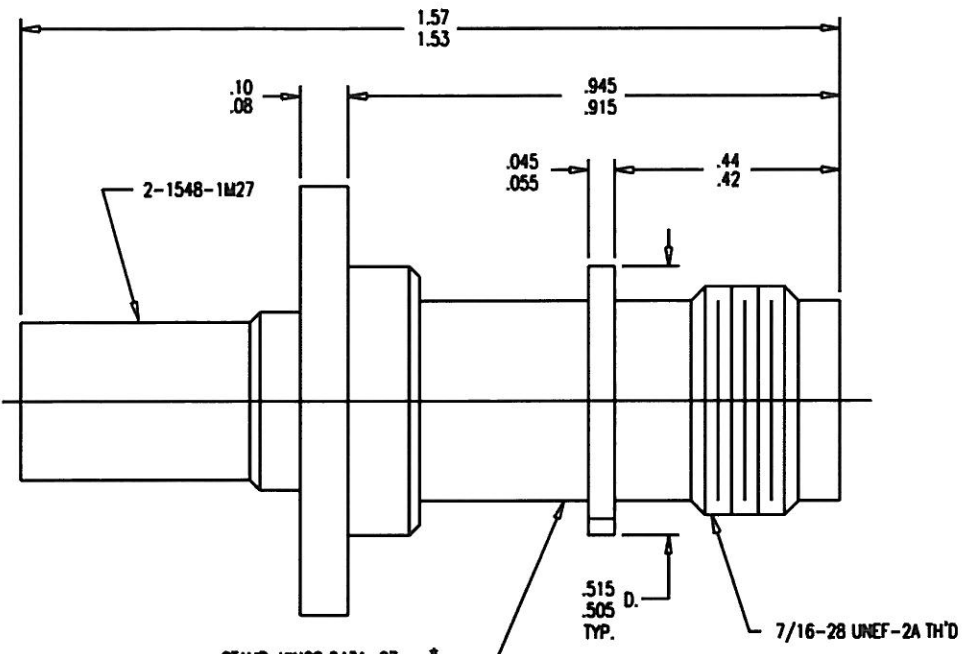

STAMP: KINGS 2431-87- *
XX XX (DATE CODE) SEE SHEET 2

- NOTES:**
- FOR USE WITH BOEING S280W503-3 & ADAMS RUSSELL FC20Z CABLE.
 - FOR CABLING INSTRUCTIONS SEE 3-546-1.
 - FOR CRIMPING USE DIE KTH-2216.
 - INTERFACE PER MIL-STD-348, FIG. 313-2.
 - FOR USE WITH .075 MAX. PANEL.
 - CENTER CONTACT (1-5671-4MA9) SUPPLIED UNASSEMBLED.
 - MARK PACKAGE: KINGS 2431-87- *
XXXX (DATE CODE) SEE SHEET 2
 - MATERIALS:**
INSULATORS-TEFLON, ASTM-D-4894
K-GRIP SLEEVE-COMMERCIAL BRONZE, ASTM-B-140
CENTER CONTACT F-BER. COP., ASTM-B-196
ALL OTHER METAL PARTS-BRASS, ASTM-B16
 - FINISHES:**
CENTER CONTACT-GOLD PLATE PER MIL-G-45204
ALL OTHER METAL PARTS-KINGS TARNISH RESISTANT NICKEL FINISH (TR-5)
 - ELECTRICAL CHARACTERISTICS:**
NOMINAL IMPEDANCE-50 OHMS
FREQUENCY RANGE-DC TO 11 GHZ
WORKING VOLTAGE-500 VRMS

MJB2906

SCALE 4:1

APPROX SURFACE AREA

USED ON

REF: BOEING

JACK, PANEL, KEYED, TNC

DRAWN MJB 09/20/95

DESIGN DATE

APPR. DATE

KINGS
ELECTRONICS CO., INC.
TUCUMPHOE, NEW YORK 10707

2431-87-* (SHEET 1 OF 2)

GSD

KINGS PART NO.	KEYING ANGLE
2431-87-1	42-
2431-87-2	54-
2431-87-3	66-
2431-87-4	78-
2431-87-5	90-
2431-87-6	102-
2431-87-7	114-
2431-87-8	126-
2431-87-9	138-
2431-87-10	150-
2431-87-11	162-
2431-87-12	174-
2431-87-13	186-
2431-87-14	198-
2431-87-15	210-
2431-87-16	222-
2431-87-17	234-
2431-87-18	246-
2431-87-19	258-
2431-87-20	270-
2431-87-21	282-
2431-87-22	294-
2431-87-23	306-
2431-87-24	318-

GSD

2431-87-*
(SHEET 2 OF 2)

REVISIONS	
ISSUE	CHANGES
0	ER 36807 VLS 02/07/96
1	CN 36939 A KH 04/23/96
MJB2907	

SCALE 1:1

APPROX SURFACE AREA

USED ON

REF:

PART NO. & ANGLE TABLE

DRAWN	MJB	DATE	12/20/95
DESIGN		DATE	
APPR.		DATE	

 **KINGS**
ELECTRONICS CO., INC.
TUCKAHOE, NEW YORK 10707

2431-87-*
(SHEET 2 OF 2)

GSD