

**PLEASE CHECK WWW.MOLEX.COM FOR LATEST PART INFORMATION**

**Part Number:** [2125153102](#)  
**Status:** **Active**  
**Overview:** [Mini-Fit Family Power Connectors](#)  
**Description:** Mini-Fit Max Female Crimp Terminal, Tin over Nickel Plating, 16 AWG, Reel

**Documents:**

[Drawing \(PDF\)](#) [RoHS Certificate of Compliance \(PDF\)](#)  
[Packaging Specification 2125150001-PK-000 \(PDF\)](#)

**General**

Product Family	Crimp Terminals
Series	<a href="#">212515</a>
Application	Power, Wire-to-Board, Wire-to-Wire
Crimp Quality Equipment	Yes
Overview	<a href="#">Mini-Fit Family Power Connectors</a>
Product Name	Mini-Fit Max
UPC	193264598410

**Physical**

Durability (mating cycles max)	30
Gender	Female
Material - Metal	High Conductivity Copper
Material - Plating Mating	Tin
Material - Plating Termination	Tin
Net Weight	0.310/g
Packaging Type	Reel
Termination Interface: Style	Crimp or Compression
Wire Insulation Diameter	2.42mm Max.
Wire Size AWG	16
Wire Size mm <sup>2</sup>	N/A

**Electrical**

Voltage - Maximum	600V
-------------------	------

**Material Info**

**Reference - Drawing Numbers**

Packaging Specification	2125150001-PK-000
Sales Drawing	2125150001-SD-000

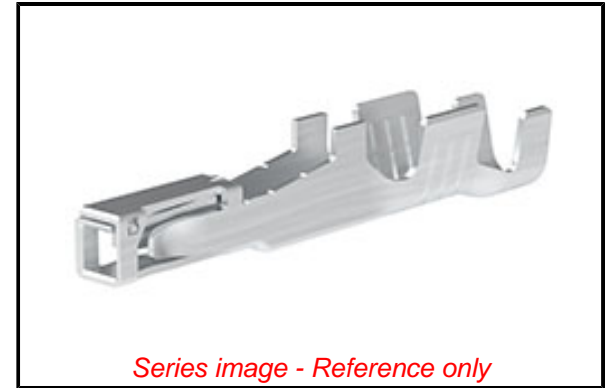

**EU ELV**

**Not Relevant**

**EU RoHS**

**Compliant**

**REACH SVHC**

Not Contained Per -  
D(2020)4578-DC (25  
June 2020)

**Halogen-Free**

**Status**

**Not Low-Halogen**

For more information, please visit [Contact US](#)

China ROHS

ELV

RoHS Phthalates

**China RoHS**

Green Image

Not Relevant

Not Contained

**Search Parts in this Series**

[212515 Series](#)

**Use With**

Mini-Fit Max Crimp Housing [212514](#)

**Application Tooling | FAQ**

*Tooling specifications and manuals are found by selecting the products below. Crimp Height Specifications are then contained in the Application Tooling Specification document.*

**Global**

Description	Product #
Hand Crimp Tool for Mini-Fit MAX Receptacle Crimp Terminals, 16 AWG, UL1007 Wire	<a href="#">2133092300</a>
Extraction and Activation Tool	<a href="#">638132700</a>

**PLEASE CHECK [WWW.MOLEX.COM](http://WWW.MOLEX.COM) FOR LATEST PART INFORMATION**