



ABOUT US | WHAT'S NEW | CONTACT US | SERVICES | QUALITY | SITE MAP

- HOME
- PRODUCTS
- ONLINE CATALOG
- REQUEST QUOTE
- ORDER ONLINE
- CHECK STOCK
- REQUEST PRINT CATALOG
- REQUEST SAMPLES
- ENGINEERING DATA
- DISTRIBUTORS
- CAPABILITIES BROCHURE

CALL NOW:
203 888-2133

PART NO. SEARCH - ENTER 3-4 CHARS:

ENTER

Catalogs: [ASE](#) | [Metric](#) | [Handles & Ferrules](#)

1/4 Hex Female Standoffs

[Home](#) [Previous](#) [Next](#)
[Related Metric](#)

Ordering Code			
xxxx	xxx	x	x
Length	Thread	Material	Finish

PART: 2101-1032-B-5

Enter desired quantities:
Qty 1 Qty 2 Qty 3

[Request Quote](#)

[Check Stock](#)

[Request Drawing](#)

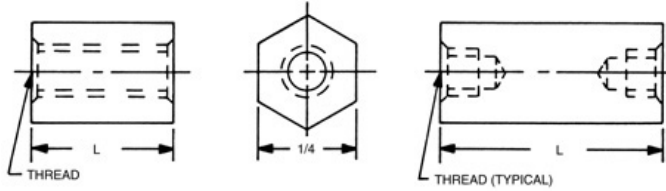

Select	Part No.	Length
<input type="radio"/>	2098A	3/32
<input type="radio"/>	2098	1/8
<input type="radio"/>	2098T	5/32
<input type="radio"/>	2099	3/16
<input type="radio"/>	2099T	7/32
<input type="radio"/>	2100	1/4
<input type="radio"/>	2100T	9/32
<input checked="" type="radio"/>	2101	5/16
<input type="radio"/>	2101T	11/32
<input type="radio"/>	2102	3/8
<input type="radio"/>	2102T	13/32
<input type="radio"/>	2103	7/16
<input type="radio"/>	2103T	15/32
<input type="radio"/>	2104	1/2
<input type="radio"/>	2104T	17/32
<input type="radio"/>	2105	9/16
<input type="radio"/>	2105T	19/32
<input type="radio"/>	2106	5/8
<input type="radio"/>	2106T	21/32
<input type="radio"/>	2107	11/16
<input type="radio"/>	2107T	23/32
<input type="radio"/>	2108	3/4
<input type="radio"/>	2108T	25/32
<input type="radio"/>	2109	13/16
<input type="radio"/>	2109T	27/32
<input type="radio"/>	2110	7/8
<input type="radio"/>	2110T	29/32

Select	Part No.	Length
<input type="radio"/>	2111	15/16
<input type="radio"/>	2111T	31/32
<input type="radio"/>	2112	1"
<input type="radio"/>	2113	1-1/16
<input type="radio"/>	2114	1-1/8
<input type="radio"/>	2115	1-3/16
<input type="radio"/>	2116	1-1/4
<input type="radio"/>	2117	1-5/16
<input type="radio"/>	2118	1-3/8
<input type="radio"/>	2119	1-7/16
<input type="radio"/>	2120	1-1/2
<input type="radio"/>	2121	1-9/16
<input type="radio"/>	2122	1-5/8
<input type="radio"/>	2123	1-11/16
<input type="radio"/>	2124	1-3/4
<input type="radio"/>	2125	1-13/16
<input type="radio"/>	2126	1-7/8
<input type="radio"/>	2127	1-15/16
<input type="radio"/>	2128	2"
<input type="radio"/>	2129	2-1/8
<input type="radio"/>	2130	2-1/4
<input type="radio"/>	2131	2-3/8
<input type="radio"/>	2132	2-1/2
<input type="radio"/>	2133	2-5/8
<input type="radio"/>	2134	2-3/4
<input type="radio"/>	2135	2-7/8
<input type="radio"/>	2136	3"

Select	Part No.	Length
<input type="radio"/>	2137	3-1/4
<input type="radio"/>	2138	3-1/2
<input type="radio"/>	2139	3-3/4
<input type="radio"/>	2140	4"
<input type="radio"/>	2141	4-1/4
<input type="radio"/>	2142	4-1/2
<input type="radio"/>	2143	4-3/4
<input type="radio"/>	2144	5"
<input type="radio"/>	2145	5-1/4
<input type="radio"/>	2146	5-1/2
<input type="radio"/>	2147	5-3/4
<input type="radio"/>	2148	6"
<input type="radio"/>	2149	6-1/4
<input type="radio"/>	2150	6-1/2
<input type="radio"/>	2151	6-3/4
<input type="radio"/>	2152	7"
<input type="radio"/>	2153	7-1/4
<input type="radio"/>	2154	7-1/2
<input type="radio"/>	2155	7-3/4
<input type="radio"/>	2156	8"
<input type="radio"/>	2157	8-1/4
<input type="radio"/>	2158	8-1/2
<input type="radio"/>	2159	8-3/4
<input type="radio"/>	2160	9"
<input type="radio"/>	2161	9-1/4
<input type="radio"/>	2162	9-1/2
<input type="radio"/>	2163	9-3/4
<input type="radio"/>	2164	10"

Select	Code	Thread
<input type="radio"/>	440	4-40
<input type="radio"/>	632	6-32
<input type="radio"/>	832	8-32
<input checked="" type="radio"/>	1032	10-32

Select	Code	Material	RoHS
<input type="radio"/>	AL	Aluminum	YES
<input type="radio"/>	B	Brass	YES
<input checked="" type="radio"/>	SS	Stainless Steel	YES
<input type="radio"/>	S	Steel	YES
<input type="radio"/>	N	Nylon	YES

[Thread depth information](#)

[Material Specifications](#)

SELECT FINISH:

5-Nickel

* Finishes ending with an asterisk are **not** RoHS Compliant

[Ordering non-standard items](#)

[HOME](#) | [PRODUCTS](#) | [ONLINE CATALOG](#) | [REQUEST QUOTE](#) | [ORDER ONLINE](#) | [CHECK STOCK](#) | [CONTACT US](#) | [SITE MAP](#)

© RAF Electronic Hardware, a Division of MW Industries | 95 Silvemine Rd., Seymour CT 06483 | Tel 203-888-2133 | Fax 203-888-9860