

SD

2065-6-9

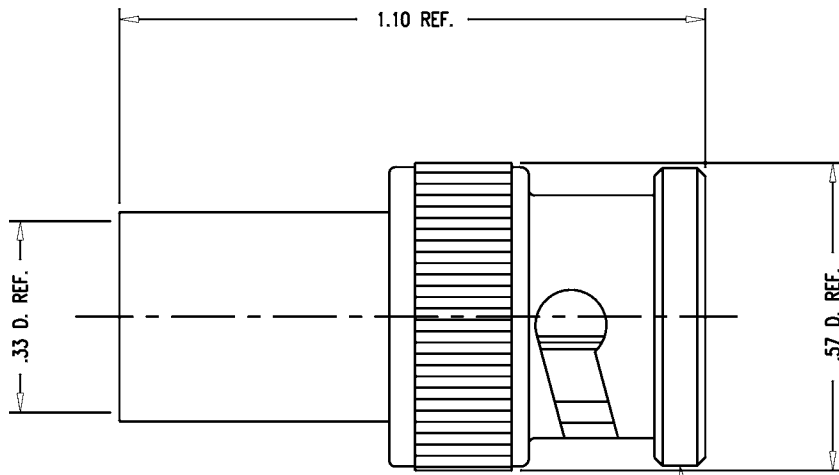

STAMP: KINGS 2065-6-9
YRWK (DATE CODE)

- NOTES:
1. FOR USE WITH WE 724 AND BELDEN 8281.
 2. FOR CABLING INSTRUCTIONS SEE 3-661-1.
 3. FOR CABLE TRIMMING USE KTJ-43 & KTD-30.
 4. FOR CRIMPING USE DIE KTH-2119.
 5. INTERFACE PER MIL-STD-348, FIG. 301-1 (AS APPLICABLE).
 6. MATERIALS:
 - INSULATOR-TEFLON, ASTM-D-1457
 - GASKET-SILICONE RUBBER, ZZ-R-765
 - K-GRIP SLEEVE-COMMERCIAL BRONZE, ALLOY 220
 - OUTER CONTACT } BER. COP., ASTM-B-196
 - SPRING WASHER }
 - ALL OTHER METAL PARTS-BRASS, ASTM-B16
 7. FINISHES:
 - SPRING WASHER-SILVER PLATE PER QQ-S-365
 - ALL OTHER METAL PARTS-KINGS TARNISH RESISTANT FINISH (TR-5)
 8. ELECTRICAL CHARACTERISTICS:
 - NOMINAL IMPEDANCE-75 OHMS
 - WORKING VOLTAGE-500 VRMS
 - FREQUENCY RANGE-DC TO 3 GHZ

REVISIONS

ISSUE	CHANGES
0	ER 37755 DCT 12/28/98
1	CN 37782 E DCT 01/29/99
2	CN 37810 A REDRAWN TML 03/17/99
3	CN 37932 D TML 11/08/99
4	CN 38011 D HVN 05/23/00
5	CN 38047 E TML 08/09/00
6	CN 38495 E TML 02/01/02
7	CN 38876 A DCT 6/20/03

SCALE 4:1			
APPROX SURFACE AREA			
USED ON			
REF:			
PLUG, 75 BNC			
DRAWN	TML	DATE	12/28/98
DESIGN	DCT	DATE	12/28/98
APPR.		DATE	

KINGS
ELECTRONICS CO., INC.
ROCK HILL, SOUTH CAROLINA 29730

2065-6-9

SD