

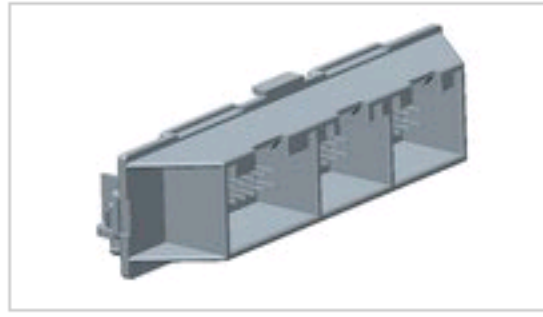

# 1241209-1 Product Details

[Share](#) | [Print](#) | [Email](#)

Active

## .100 AMPMODU Headers, Housings & Contacts

MODU STLEI16+12+12P

**1241209-1**

TE Internal Number: 1241209-1

**Product Highlights** [View All](#)

- Connector
- Header
- Connector Style = Plug
- Contact Type = Pin
- 2.50 mm Centerline

[Pricing & Availability](#)

[Request Sample](#)

[Add to My Part List](#)

[Buy Product through Distributor](#)

Feedback

[Documents](#) | [Features](#) | [Compliance](#)

**Please Note:**  
Use the Product Drawing for all design activity

Product Type Features	
Product Type	Connector
Connector Type	Header
Post Size (mm [in])	0.64 [.025]
PCB Mounting Orientation	Right Angle
PCB Mount Style	Through Hole
Profile	Standard
Mating Connector Lock	With
PCB Mount Retention	With
PCB Orientation Feature	No
Connector Series	Mod II

Body Features	
Row-to-Row Spacing (mm [in])	2.54 [0.100]

Contact Features	
Contact Type	Pin
Contact Plating, Mating Area, Material	Tin
Solder Tail Contact Plating	Tin
Contact Base Material	CuSn6
Contact Shape	Square

Housing Features	
Connector Style	Plug
Centerline (mm [in])	2.50 [0.098]
Mating Alignment	With
Mating Alignment Type	Polarization
Housing Color	Black
Housing Material	PBT GF15

Configuration Features	
Number of Positions	40
Number of Rows	2

Industry Standards	
RoHS/ELV Compliance	RoHS compliant, ELV compliant
Lead Free Solder Processes	Wave solder capable to 240°C
RoHS/ELV Compliance History	Always was RoHS compliant

Conditions for Usage	
Applies To	Printed Circuit Board

Packaging Features	
Packaging Method	Carton
Packaging Quantity	168

Other	
Brand	AMP

**Related Products**

Not quite the product you're looking for?  
[Find Similar Products](#)

[View Part in Product Feature Selector](#)

[Check for Tooling](#)

**Corporate Information**

- [About TE](#)
- [Investors](#)
- [News Room](#)
- [Supplier Portal](#)
- [Careers](#)
- [Terms & Conditions](#)
- [Privacy Policy](#)
- [Global Accessibility Statement](#)

**Quick Links**

- [Distributor Inventory](#)
- [Product Cross Reference](#)
- [Documents & Drawings](#)
- [Product Compliance Support Center](#)
- [Site Map](#)

**Customer Support**

- [Email or Chat With Us](#)
- [Find a Phone Number](#)
- [Knowledge Base](#)
- [Manage Your Account](#)

**Keep Me Informed**

