



ABOUT US WHAT'S NEW CONTACT US SERVICES QUALITY SITE MAP

- HOME
- PRODUCTS
- ONLINE CATALOG
- REQUEST QUOTE
- ORDER ONLINE
- CHECK STOCK
- REQUEST PRINT CATALOG
- REQUEST SAMPLES
- ENGINEERING DATA
- DISTRIBUTORS
- CAPABILITIES BROCHURE

CALL NOW:
203 888-2133

PART NO. SEARCH - ENTER 3-4 CHARS:

ENTER

Catalogs: [ASE](#) | [Metric](#) | [Handles & Ferrules](#)

1/2 Round Spacers

[Home](#) [Previous](#) [Next](#)
[Related Metric](#)

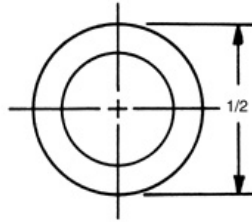
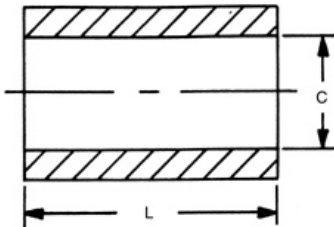

Ordering Code			
xxxx	x	x	x
	Clearance Hole		Finish
Length		Material	

PART: 1221-10-S-12

Enter desired quantities:
Qty 1 Qty 2 Qty 3

Request Quote

Check Stock

Request Drawing

Select	Part No.	Length
<input type="radio"/>	1215A	3/32
<input type="radio"/>	1215	1/8
<input type="radio"/>	1215T	5/32
<input type="radio"/>	1216	3/16
<input type="radio"/>	1216T	7/32
<input type="radio"/>	1217	1/4
<input type="radio"/>	1217T	9/32
<input type="radio"/>	1218	5/16
<input type="radio"/>	1218T	11/32
<input type="radio"/>	1219	3/8
<input type="radio"/>	1219T	13/32
<input type="radio"/>	1220	7/16
<input type="radio"/>	1220T	15/32
<input checked="" type="radio"/>	1221	1/2
<input type="radio"/>	1221T	17/32

Select	Part No.	Length
<input type="radio"/>	1222	9/16
<input type="radio"/>	1222T	19/32
<input type="radio"/>	1223	5/8
<input type="radio"/>	1223T	21/32
<input type="radio"/>	1224	11/16
<input type="radio"/>	1224T	23/32
<input type="radio"/>	1225	3/4
<input type="radio"/>	1225T	25/32
<input type="radio"/>	1226	13/16
<input type="radio"/>	1226T	27/32
<input type="radio"/>	1227	7/8
<input type="radio"/>	1227T	29/32
<input type="radio"/>	1228	15/16
<input type="radio"/>	1228T	31/32
<input type="radio"/>	1229	1"

Select	Part No.	Length
<input type="radio"/>	1230	1-1/16
<input type="radio"/>	1231	1-1/8
<input type="radio"/>	1232	1-3/16
<input type="radio"/>	1233	1-1/4
<input type="radio"/>	1234	1-5/16
<input type="radio"/>	1235	1-3/8
<input type="radio"/>	1236	1-7/16
<input type="radio"/>	1237	1-1/2
<input type="radio"/>	1238	1-9/16
<input type="radio"/>	1239	1-5/8
<input type="radio"/>	1240	1-11/16
<input type="radio"/>	1241	1-3/4
<input type="radio"/>	1242	1-13/16
<input type="radio"/>	1243	1-7/8
<input type="radio"/>	1244	1-15/16
<input type="radio"/>	1245	2"

Hole Clearance Code		
Select	Code	
<input type="radio"/>		+0.010
<input type="radio"/>		-0.000
<input type="radio"/>	6	.140
<input type="radio"/>	8	.166
<input checked="" type="radio"/>	10	.192
<input type="radio"/>	12	.218
<input type="radio"/>	25	.252

Select	Code	Material	RoHS
<input type="radio"/>	AL	Aluminum	YES
<input type="radio"/>	B	Brass	YES
<input type="radio"/>	SS	Stainless Steel	YES
<input checked="" type="radio"/>	S	Steel	YES
<input type="radio"/>	N	Nylon	YES
<input type="radio"/>	PH	Phenolic	YES

Material Specifications

SELECT FINISH:

12-Zinc

* Finishes ending with an asterisk are not RoHS Compliant

[Ordering non-standard items](#)

[HOME](#) | [PRODUCTS](#) | [ONLINE CATALOG](#) | [REQUEST QUOTE](#) | [ORDER ONLINE](#) | [CHECK STOCK](#) | [CONTACT US](#) | [SITE MAP](#)

© RAF Electronic Hardware, a Division of MW Industries | 95 Silvermine Rd., Seymour CT 06483 | Tel 203-888-2133 | Fax 203-888-9860