

1. PART NUMBER AND C

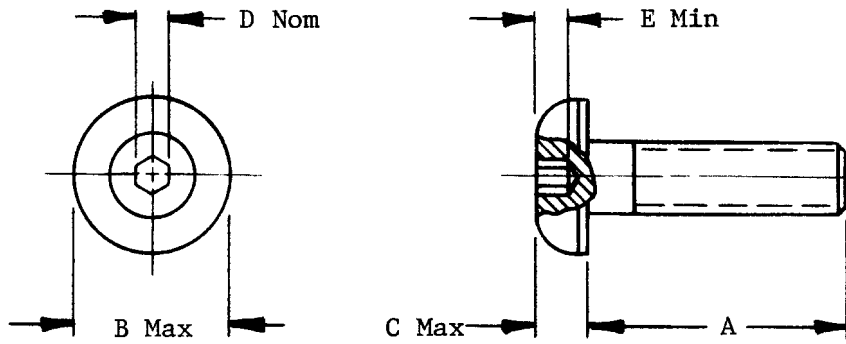

SEE ALSO 24921

Tyco Part No	Rev	Thread Size	A	B	C	D	E
21002-1	T	0-80UNF	.125	.114	.032	.035	.020
21002-2	T	0-80UNF	.188	.114	.032	.035	.020
21002-3	T	0-80UNF	.250	.114	.032	.035	.020
21002-4	T	0-80UNF	.375	.114	.032	.035	.020
21002-5	T	1-72UNF	.125	.139	.039	.050	.028
21002-6	T	1-72UNF	.188	.139	.039	.050	.028
21002-7	T	1-72UNF	.250	.139	.039	.050	.028
21002-8	T	1-72UNF	.375	.139	.039	.050	.028
21002-9	T	2-56UNC	.188	.164	.046	.050	.028
1-21002-0	T	2-56UNC	.250	.164	.046	.050	.028
1-21002-1	T	2-56UNC	.375	.164	.046	.050	.028
1-21002-2	T	2-56UNC	.500	.164	.046	.050	.028
1-21002-3	T	4-40UNC	.250	.213	.059	.062	.035
1-21002-4	T	4-40UNC	.375	.213	.059	.062	.035
1-21002-5	T	4-40UNC	.500	.213	.059	.062	.035
1-21002-6	T	6-32UNC	.250	.262	.073	.078	.044
1-21002-7	T	6-32UNC	.375	.262	.073	.078	.044
1-21002-8	T	6-32UNC	.500	.262	.073	.078	.044
1-21002-9	T	6-32UNC	.625	.262	.073	.078	.044
2-21002-0	T	8-32UNC	.250	.312	.087	.094	.052
2-21002-1	T	8-32UNC	.375	.312	.087	.094	.052
2-21002-2	T	8-32UNC	.500	.312	.087	.094	.052
2-21002-3	T	8-32UNC	.625	.312	.087	.094	.052
2-21002-4	T	8-32UNC	.750	.312	.087	.094	.052
2-21002-5	T	10-32UNF	.250	.361	.101	.125	.070

THIS DOCUMENT IS UNCLASSIFIED AND/OR CUSTOMER CONTROLLED PRODUCT(S).  
 IT IS SUBJECT TO THE MIL-SPEC QPL AND/OR CUSTOMER CONTROLLED PRODUCT(S) APPROVED SOURCE POLICIES (TEC-1005) AND/OR CUSTOMER CHANGE REQUIREMENTS MAY APPLY.  
 Receipt of this document does not constitute an approval.

<b>COMMERCIAL ITEM SPECIFICATION</b>			MATERIAL Alloy Steel		Tyco Electronics Corporation Harrisburg, PA 17110-3608			
			FINISH Black Oxide					
© 2005 Tyco Electronics Corporation, Harrisburg, PA All International Rights Reserved				DIMENSIONS IN INCHES	NO <b>21002</b>	REV <b>U</b>	LOC <b>B</b>	DIST <b>31</b>
U	Clarify finish	AFM		27JUN05	TITLE <b>SCREW, CAP, SOCKET, BUTTON HEAD</b>			
REV	ENGINEERING CHANGE	CHK	DATE	SHEET 1 OF 3				

1. PART NUMBER AND CHARACTERISTIC

Tyco Part No	Rev	Thread Size	A	B	C	D	E
2-21002-6	T	10-32UNF	.375	.361	.101	.125	.070
2-21002-7	T	10-32UNF	.500	.361	.101	.125	.070
2-21002-8	T	10-32UNF	.625	.361	.101	.125	.070
2-21002-9	T	10-32UNF	.750	.361	.101	.125	.070
3-21002-0	T	10-32UNF	.875	.361	.101	.125	.070
3-21002-1	T	10-32UNC	1.000	.361	.101	.125	.070
3-21002-2	T	1/4-20UNC	.375	.437	.132	.156	.087
3-21002-3	T	1/4-20UNC	.500	.437	.132	.156	.087
3-21002-4	T	1/4-20UNC	.625	.437	.132	.156	.087
3-21002-5	T	1/4-20UNC	.750	.437	.132	.156	.087
3-21002-6	T	1/4-20UNC	.875	.437	.132	.156	.087
3-21002-7	T	1/4-20UNC	1.000	.437	.132	.156	.087
3-21002-8	T	5/16-18UNC	.375	.547	.166	.187	.105
3-21002-9	T	5/16-18UNC	.500	.547	.166	.187	.105
4-21002-0	T	5/16-18UNC	.625	.547	.166	.187	.105
4-21002-1	T	5/16-18UNC	.750	.547	.166	.187	.105
4-21002-2	T	5/16-18UNC	.875	.547	.166	.187	.105
4-21002-3	T	5/16-18UNC	1.000	.547	.166	.187	.105
4-21002-4	T	3/8-16UNC	.500	.656	.199	.219	.122
4-21002-5	T	3/8-16UNC	.625	.656	.199	.219	.122
4-21002-6	T	3/8-16UNC	.750	.656	.199	.219	.122
4-21002-7	T	3/8-16UNC	.875	.656	.199	.219	.122
4-21002-8	T	3/8-16UNC	1.000	.656	.199	.219	.122
4-21002-9	T	3/8-16UNC	1.250	.656	.199	.219	.122
5-21002-0	T	1/2-13UNC	1.000	.875	.265	.312	.175
5-21002-1	T	1/2-13UNC	1.250	.875	.265	.312	.175
5-21002-2	T	1/2-13UNC	1.500	.875	.265	.312	.175
5-21002-3	T	1/2-13UNC	1.750	.875	.265	.312	.175
5-21002-4	T	1/2-13UNC	2.000	.875	.265	.312	.175
5-21002-5	T	10-24UNC	2.500	.361	.101	.125	.070
5-21002-6	T	8-36UNF	.250	.312	.087	.094	.052
5-21002-7	T	8-36UNF	.375	.312	.087	.094	.052
5-21002-8	T	8-36UNF	.500	.312	.087	.094	.052
5-21002-9	T	8-36UNF	.625	.312	.087	.094	.052
6-21002-0	T	8-36UNF	.750	.312	.087	.094	.052
6-21002-1	T	10-24UNC	.250	.361	.101	.125	.070
6-21002-2	T	10-24UNC	.375	.361	.101	.125	.070
6-21002-3	T	10-24UNC	.500	.361	.101	.125	.070
6-21002-4	T	10-24UNC	.625	.361	.101	.125	.070
6-21002-5	T	10-24UNC	.750	.361	.101	.125	.070
6-21002-6	T	10-24UNC	.875	.361	.101	.125	.070
6-21002-7	T	10-24UNC	1.000	.361	.101	.125	.070
6-21002-8	T	1/4-28UNF	.375	.437	.132	.156	.087
6-21002-9	T	1/4-28UNF	.500	.437	.132	.156	.087
7-21002-0	T	1/4-28UNF	.625	.437	.132	.156	.087

NOTICE-USED ON MIL SPEC QPL AND/OR CUSTOMER CONTROLLED PRODUCT(S):  
 Approved Source Policies (TEC-1005) and/or Customer Change Requirements may apply.  
 Receipt of this document does not constitute an approval.

1. PART NUMBER AND CHARACTERISTIC

Tyco Part No	Rev	Thread Size	A	B	C	D	E
7-21002-1	T	1/4-28UNF	.750	.437	.132	.156	.087
7-21002-2	T	1/4-28UNF	.875	.437	.132	.156	.087
7-21002-3	T	1/4-28UNF	1.000	.437	.132	.156	.087
7-21002-4	T	5/16-24UNF	.375	.547	.166	.187	.105
7-21002-5	T	5/16-24UNF	.500	.547	.166	.187	.105
7-21002-6	T	5/16-24UNF	.625	.547	.166	.187	.105
7-21002-7	T	5/16-24UNF	.750	.547	.166	.187	.105
7-21002-8	T	5/16-24UNF	.875	.547	.166	.187	.105
7-21002-9	T	5/16-24UNF	1.000	.547	.166	.187	.105
8-21002-0	T	3/8-24UNF	.375	.656	.199	.219	.122
8-21002-1	T	3/8-24UNF	.500	.656	.199	.219	.122
8-21002-2	T	3/8-24UNF	.625	.656	.199	.219	.122
8-21002-3	T	3/8-24UNF	.750	.656	.199	.219	.122
8-21002-4	T	3/8-24UNF	.875	.656	.199	.219	.122
8-21002-5	T	3/8-24UNF	1.000	.656	.199	.219	.122
8-21002-6	T	3/8-24UNF	1.250	.656	.199	.219	.122
8-21002-7	T	1/4-20UNC	1.750	.437	.132	.156	.087
8-21002-8	T	4-40UNC	.188	.213	.059	.062	.035
8-21002-9	T	8-32UNC	1.000	.312	.087	.094	.052
9-21002-0	T	10-32UNF	1.250	.361	.101	.125	.070
9-21002-1	T	1/4-20UNC	.250	.437	.132	.156	.087
9-21002-2	T	1/4-20UNC	1.250	.437	.132	.156	.087
9-21002-3	T	5-40UNC	.250	.238	.066	.078	.044
9-21002-4	T	8-36UNF	1.625	.312	.087	.094	.052
9-21002-5	T	5-40UNC	.375	.238	.066	.078	.044
9-21002-6	T	8-32UNC	.875	.312	.087	.094	.052
9-21002-7	T	4-40UNC	.750	.213	.059	.062	.035
9-21002-8	T	3/8-16UNC	1.500	.656	.199	.219	.122
9-21002-9	T	3/8-16UNC	1.750	.656	.199	.219	.122

- 1.1. Hardness: Rockwell C36-45
- 1.2. Shall comply with ANSI B18.3
- 2. RECOMMENDED MANUFACTURER  
None

NOTICE-USED ON MIL SPEC QPL AND/OR CUSTOMER CONTROLLED PRODUCT(S):  
 Approved Source Policies (TEC-1005) and/or Customer Change Requirements may apply.  
 Receipt of this document does not constitute an approval.