

DASH NO.	M CODE	MADE FROM
----------	--------	-----------

GSD

M39012/01-0017

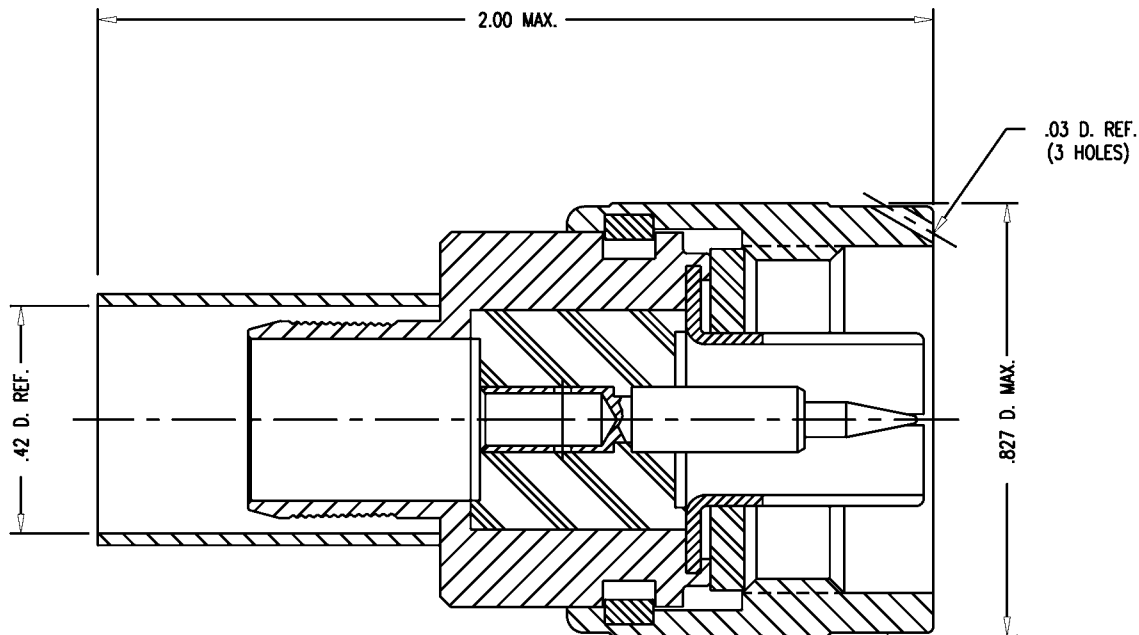

STAMP: 91836 M39012/01-0017  
1205-68-5 YRWK (DATE CODE)

NOTES:

- FOR USE WITH M17/74-213 CABLE.
- FOR CABLING INSTRUCTIONS SEE 3-610.
- FOR CABLE TRIMMING USE KTJ-137 & KTD-138.
- FOR CRIMPING USE DIE KTH-2004.
- INTERFACE PER MIL-STD-348, FIG. 304-1.
- CENTER CONTACT SUPPLIED UNASSEMBLED.
- MATERIALS:  
INSULATOR: TEFLON, ASTM-D-4894  
GASKETS: SILICONE RUBBER, ZZ-R-765  
K-GRIP SLEEVE: COM. BRONZE TUBE, ASTM-B-140  
C-RING } PHOSPHOR BRONZE, ASTM-B-103  
OUTER CONTACT }  
ALL OTHER METAL PARTS: BRASS, ASTM-B16
- FINISHES:  
CENTER CONTACT: HARD GOLD PLATE PER MIL-G-45204  
ALL OTHER METAL PARTS: SILVER PLATE PER QQ-S-365
- ELECTRICAL CHARACTERISTICS:  
NOMINAL IMPEDANCE: 50 OHMS  
WORKING VOLTAGE: 1000 VRMS  
FREQUENCY RANGE: DC TO 11 GHz.

REVISIONS

ISSUE	CHANGES
0	ER 36057 MJB 01/18/95
1	CN 36099 E ME 02/09/95
2	CN 38571 E TML 05/21/02

MJB2547

SCALE	4:1		
APPROX SURFACE AREA	1205-68-5		
USED ON			
REF:	PL, N		
DRAWN	MJB	DATE	12/02/94
DESIGN	LI	DATE	12/02/94
APPR.	LI	DATE	01/24/95

**KINGS**  
ELECTRONICS CO., INC.  
ROCK HILL, SOUTH CAROLINA 29730  
M39012/01-0017

GSD