

SCALA NON IMPEGNATIVA
(DO NOT SCALE)
DIMENSIONI IN mm
(DIMENSIONS IN mm)

METRIC

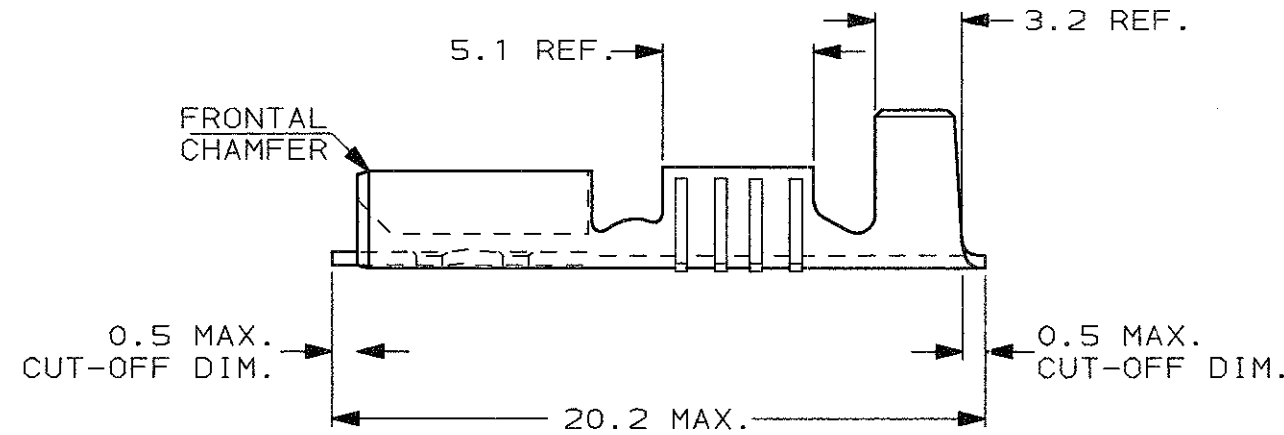
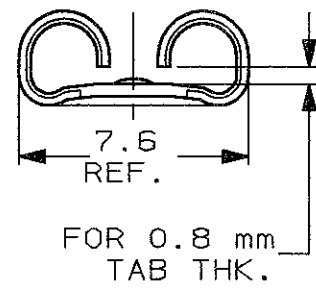
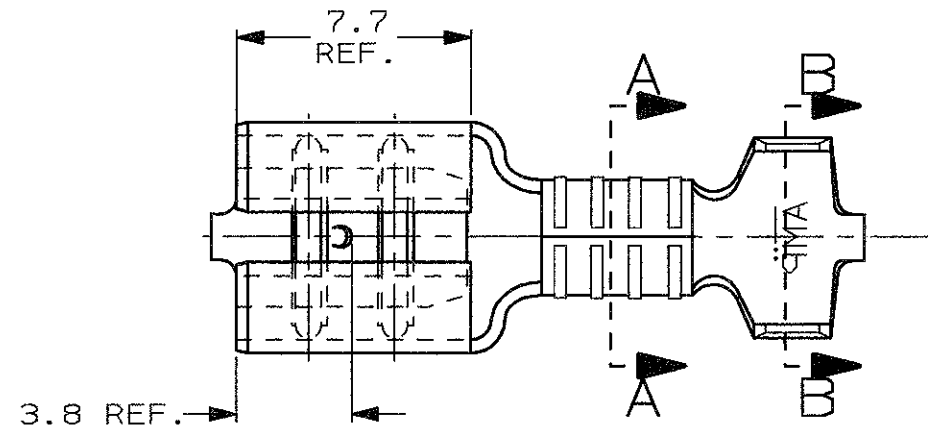
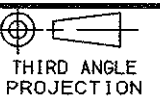

1) PER LE VERSIONI IN NASTRO
VEDERE DISEGNO 160256
(FOR STRIP FORM VERSION SEE DRAWING 160256)

SEZIONE A-A
SECTION A-A

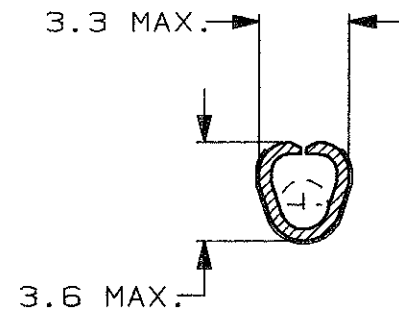

SEZIONE B-B
SECTION B-B

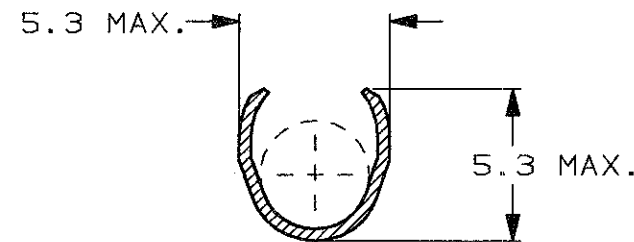

PRE NICHELATO (PRE NICKELPLATED)	ACCIAIO (STEEL)	2-160304-4	Y
STAGNATO (TIN PLATED)	BRONZO FOS. (PHOS. BRONZE)	1-160304-8	Y
ARGENTATO (SILVER PLATED)	OTTONE (BRASS)	1-160304-7	Y
NUDO (PLAIN)	BRONZO FOS. (PHOS. BRONZE)	1-160304-5	Y
STAGNATO (TIN PLATED)	OTTONE (BRASS)	1-160304-2	Y
NUDO (PLAIN)	OTTONE (BRASS)	1-160304-0	Y
FINITURA / COLORE (FINISH / COLOUR)	MATERIALE (MATERIAL)	NUMERO (PART NUMBER)	REV

CUSTOMER DWG. FOR REFERENCE ONLY **DISEGNO PER CLIENTE SOLO PER RIFERIMENTO**

THIS DRAWING IS UNPUBLISHED RELEASE FOR PUBLICATION 19

© COPYRIGHT 19 BY AMP INCORPORATED, HARRISBURG, PA. ALL INTERNATIONAL RIGHT RESERVED. AMP PRODUCTS MAY BE COVERED BY U.S. AND FOREIGN PATENT AND/OR PATENT PENDING

TOLLERANZE: SE NON DIVERSAMENTE SPECIFICATO (TOLERANCES, UNLESS OTHERWISE SPECIFIED)	DIAM. ISOLANTE (INS. DIA. RANGE)	RANGO FILO (WIRE RANGE)	SCALA (SCALE)
± 0.3	3.0-4.3	1.0-2.5	4:1

ANGOLI (ANGLES) ± 2°

AMP AMP ITALIA S.p.A.
Corso F. LUI Cervi, 15
COLLEGNO (TORINO)

DIS. H. YAALI (DR.) 15 SEP 2000

DESCRIZIONE (DESCRIPTION) **FASTON® Connector, .250" sr. REC. CONTACT. (LOOSE PIECE VERSION)**

CONT. C. TARTARI (CHK) 15 SEP 2000

LOC. SIZE NUMERO (DWG NO) REV. FOGLIO (SHEET)

Y	OBSOLETE PARTS & REDRAWN ET00-0246-00	H. Y.	02 JAN 2001	APP.		I A3	C-160304	Y	1
REV.	REVISIONI (REVISION RECORD)	DIS. (DR)	DATA (DATE)	APP. (APP.)					

DISTRIBUZIONE (PRINT DIST.)