



ABOUT US | WHAT'S NEW | CONTACT US | SERVICES | QUALITY | SITE MAP

- HOME
- PRODUCTS
- ONLINE CATALOG
- REQUEST QUOTE
- ORDER ONLINE
- CHECK STOCK
- REQUEST PRINT CATALOG
- REQUEST SAMPLES
- ENGINEERING DATA
- DISTRIBUTORS
- CAPABILITIES BROCHURE

**CALL NOW:**  
203 888-2133



PART NO. SEARCH - ENTER 3-4 CHARS:

ENTER

Catalogs: [ASE](#) | [Metric](#) | [Handles & Ferrules](#)

## 1/4 Round Spacers

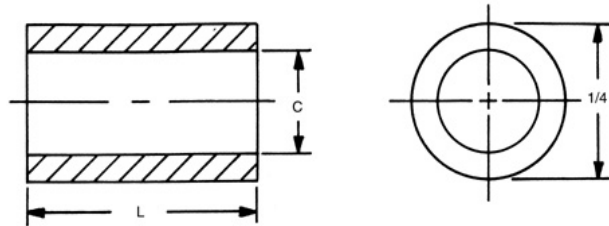

[Home](#) | [Previous](#) | [Next](#)  
[Related Metric](#)

Ordering Code			
xxxx	x	x	x
Clearance		Finish	
Hole		Material	
Length			

**PART: 1124-6-AL**

Enter desired quantities:

Qty 1 | Qty 2 | Qty 3

0 | 0 | 0

Request Quote

Check Stock

Download drawing

Select	Part No.	Length	Select	Part No.	Length	Select	Part No.	Length
<input type="radio"/>	1122A	3/32	<input type="radio"/>	1129	9/16	<input type="radio"/>	1137	1-1/16
<input type="radio"/>	1122	1/8	<input type="radio"/>	1129T	19/32	<input type="radio"/>	1138	1-1/8
<input type="radio"/>	1122T	5/32	<input type="radio"/>	1130	5/8	<input type="radio"/>	1139	1-3/16
<input type="radio"/>	1123	3/16	<input type="radio"/>	1130T	21/32	<input type="radio"/>	1140	1-1/4
<input type="radio"/>	1123T	7/32	<input type="radio"/>	1131	11/16	<input type="radio"/>	1141	1-5/16
<input checked="" type="radio"/>	1124	1/4	<input type="radio"/>	1131T	23/32	<input type="radio"/>	1142	1-3/8
<input type="radio"/>	1124T	9/32	<input type="radio"/>	1132	3/4	<input type="radio"/>	1143	1-7/16
<input type="radio"/>	1125	5/16	<input type="radio"/>	1132T	25/32	<input type="radio"/>	1144	1-1/2
<input type="radio"/>	1125T	11/32	<input type="radio"/>	1133	13/16	<input type="radio"/>	1145	1-9/16
<input type="radio"/>	1126	3/8	<input type="radio"/>	1133T	27/32	<input type="radio"/>	1146	1-5/8
<input type="radio"/>	1126T	13/32	<input type="radio"/>	1134	7/8	<input type="radio"/>	1147	1-11/16
<input type="radio"/>	1127	7/16	<input type="radio"/>	1134T	29/32	<input type="radio"/>	1148	1-3/4
<input type="radio"/>	1127T	15/32	<input type="radio"/>	1135	15/16	<input type="radio"/>	1149	1-13/16
<input type="radio"/>	1128	1/2	<input type="radio"/>	1135T	31/32	<input type="radio"/>	1150	1-7/8
<input type="radio"/>	1128T	17/32	<input type="radio"/>	1136	1"	<input type="radio"/>	1151	1-15/16
<input type="radio"/>			<input type="radio"/>			<input type="radio"/>	1152	2"

Hole Clearance Code		
Select	Code	+0.010 -0.000
<input type="radio"/>	2	.090
<input type="radio"/>	4	.115
<input checked="" type="radio"/>	6	.140
<input type="radio"/>	8	.166

Select	Code	Material	RoHS
<input checked="" type="radio"/>	AL	Aluminum	YES
<input type="radio"/>	B	Brass	YES
<input type="radio"/>	SS	Stainless Steel	YES
<input type="radio"/>	S	Steel	YES
<input type="radio"/>	N	Nylon	YES
<input type="radio"/>	PH	Phenolic	YES

Material Specifications

SELECT FINISH:

Plain Finish

\* Finishes ending with an asterisk are not RoHS Compliant  
[Ordering non-standard items](#)