

NYLON FASTENERS & MISC.

Nylon Machine Screws

Our Nylon machine screws come in a variety of styles and sizes. They are made of the highest quality nylon and to the toughest specifications.

Size	Part Numbers Round Head	Part Numbers Flat Head	Part Numbers Binder Head
2-56 x 1/4"	10-922	10-822	10-722
2-56 x 1/2"	10-925	10-825	10-725
4-40 x 1/4"	10-942	10-842	10-742
4-40 x 1/2"	10-945	10-845	10-745
4-40 x 3/4"	10-947	10-847	10-747
6-32 x 1/4"	10-962	10-862	10-762
6-32 x 3/8"	10-963	10-863	10-763
6-32 x 1/2"	10-965	10-865	10-765
6-32 x 5/8"	10-966	10-866	10-766
6-32 x 3/4"	10-967	10-867	10-767
8-32 x 3/8"	10-983	10-883	10-783
8-32 x 1/2"	10-985	10-885	10-785
8-32 x 3/4"	10-987	10-887	10-787
10-32 x 1/2"	10-905	10-805	10-705
10-32 x 1"	10-911	10-811	10-711

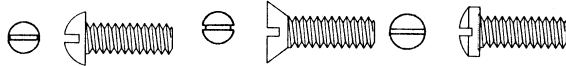

Nylon Hex Nuts

Size	Part Number
2-56 x 3/16"	10-512
4-40 x 1/4"	10-514
6-32 x 1/4"	10-516
8-32 x 1/4"	10-518
10-32 x 3/8"	10-510

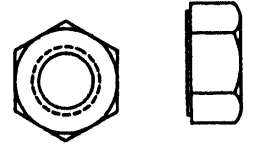

Nylon Flat Washers

Size	Part Number
#2 x 1/4"	10-502
#4 x 1/4"	10-504
#6 x 5/16"	10-506
#8 x 3/8"	10-508
#10 x 3/8"	10-501

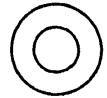

Snap-In Hole Plugs

These plugs have excellent spring retention. They are made of Nickel plated steel. They may be used to cover chassis holes, access ports, and wiring outlets.

Part Number	Hole Dia.	"A"	"B"	"C"
10-025	1/4"	.406"	.234"	.062"
10-026	3/8"	.500"	.234"	.062"
10-027	1/2"	.656"	.281"	.078"
10-028	3/4"	.921"	.296"	.078"

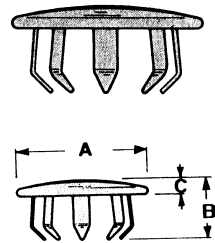

Nylon Finish Washers

These washers are used with flathead screws.

Size	Part Number
# 6	10-526
#8	10-528
#10	10-521



Rubber Grommets

Part Number	I.D. "A"	Hole Size "B"	"C"	"D"	"E"
10-046	.125"	.250"	.062"	.343"	.187"
10-047	.187"	.312"	.062"	.437"	.218"
10-048	.250"	.375"	.062"	.562"	.250"
10-049	.500"	.750"	.093"	.968"	.281"

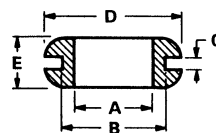

Lockwasher Solder Lugs

These nuts are Nickel plated brass and are used on controls, switches, capacitors, and tip jacks.

Size	Part Number
#4 (.120) x 7/8"	10-478
#6 (.140) x 23/32"	10-479
#8 (.171) x 47/64"	10-480



Note: All Hardware Available in 100 pack Add (C) suffix when ordering.

Package quantity is listed in Distributor price schedule.