

## Terminals

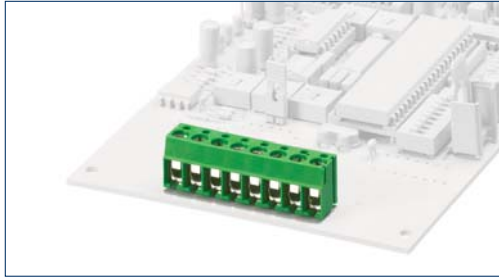

5,00 mm

## PK 100/... /5,00-V-BL vertical



## PK 100/... /5,00-H-BL horizontal

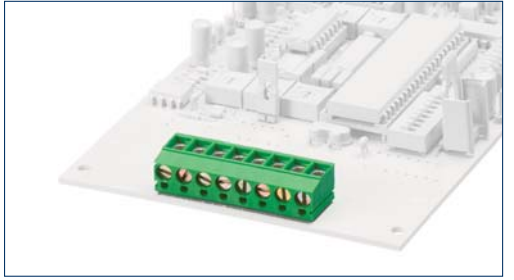

## Drawings

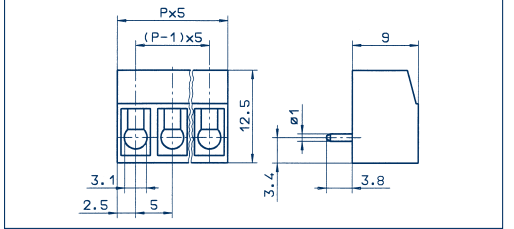
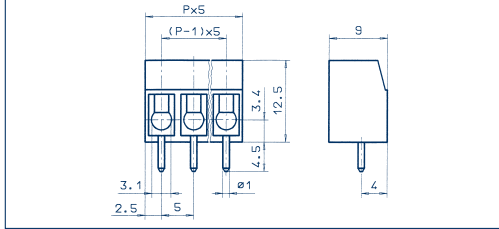

## Connection principle

### Dimensions

|                                |      |
|--------------------------------|------|
| Spacing mm                     | 5,00 |
| Insulation stripping length mm | 7,00 |
| PCB hole diameter mm           | 1,30 |

### Connection data

|   |      |
|---|------|
| Single wire (solid) mm <sup>2</sup>           | 2,50 |
| Stranded wire (flexible) mm <sup>2</sup>      | 1,50 |
| Stranded wire (with ferrules) mm <sup>2</sup> | 1,50 |

### Rating

|  |       |            |
|--|-------|------------|
| Rated voltage V                        | 300 V | 250 V      |
| Rated current A                        | 15 A  | 24 A (T60) |
| Cross section max. AWG/mm <sup>2</sup> | 22-14 | 2,50       |
| Rated surge voltage                    | –     | 2,00 kV    |
| Rated torque/Screw size                | –     | 0,50 Nm/M3 |
| Contamination degree                   | –     | –          |

### Materials

|  |                      |  |
|--|----------------------|--|
| Insulating material/Flammability class | PA 6.6 V0 / UL 94 V0 |  |
| Temperature Range                      | -30°C / +105°C       |  |
| Clamping part                          | CuZn                 |  |
| Clamping cage/Eccentric                | –                    |  |
| Contact pin                            | –                    |  |
| Cage tension spring                    | –                    |  |
| Wire protection                        | stainless steel      |  |
| Soldering lug                          | –                    |  |
| Contact Spring                         | –                    |  |

### Order information

Standard colour(s)

(further colours on request, see page 5)

| No. of poles | Cat.-No.            |                         | Qty.p.pck. | No. of poles | Cat.-No.            |                         | Qty.p.pck. |
|--------------|---------------------|-------------------------|------------|--------------|---------------------|-------------------------|------------|
|              | ●                   | ●                       |            |              | ●                   | ●                       |            |
|              | green<br>(Ral 6018) | dark grey<br>(Ral 7016) |            |              | green<br>(Ral 6018) | dark grey<br>(Ral 7016) |            |
| 2            | 10045.1             | 10045.4                 | 50         | 2            | 10056.1             | 10056.4                 | 50         |
| 3            | 10046.1             | 10046.4                 | 50         | 3            | 10057.1             | 10057.4                 | 50         |
| 4            | 10047.1             | 10047.4                 | 50         | 4            | 10058.1             | 10058.4                 | 50         |
| 5            | 10048.1             | 10048.4                 | 50         | 5            | 10059.1             | 10059.4                 | 50         |
| 6            | 10049.1             | 10049.4                 | 50         | 6            | 10060.1             | 10060.4                 | 50         |
| 7            | 10050.1             | 10050.4                 | 50         | 7            | 10061.1             | 10061.4                 | 50         |
| 8            | 10051.1             | 10051.4                 | 50         | 8            | 10062.1             | 10062.4                 | 50         |
| 9            | 10052.1             | 10052.4                 | 50         | 9            | 10063.1             | 10063.4                 | 50         |
| 10           | 10053.1             | 10053.4                 | 50         | 10           | 10064.1             | 10064.4                 | 50         |
| 11           | 10054.1             | 10054.4                 | 50         | 11           | 10065.1             | 10065.4                 | 50         |
| 12           | 10055.1             | 10055.4                 | 50         | 12           | 10066.1             | 10066.4                 | 50         |
| 13           | 12421.1             | 12421.4                 | 50         | 13           | 12433.1             | 12433.4                 | 50         |
| 14           | 12422.1             | 12422.4                 | 50         | 14           | 12434.1             | 12434.4                 | 50         |
| 15           | 12423.1             | 12423.4                 | 50         | 15           | 12435.1             | 12435.4                 | 50         |
| 16           | 12424.1             | 12424.4                 | 50         | 16           | 12436.1             | 12436.4                 | 50         |
| 17           | 12425.1             | 12425.4                 | 50         | 17           | 12437.1             | 12437.4                 | 50         |
| 18           | 12426.1             | 12426.4                 | 50         | 18           | 12438.1             | 12438.4                 | 50         |
| 19           | 12427.1             | 12427.4                 | 50         | 19           | 12439.1             | 12439.4                 | 50         |
| 20           | 12428.1             | 12428.4                 | 50         | 20           | 12440.1             | 12440.4                 | 50         |
| 21           | 12429.1             | 12429.4                 | 50         | 21           | 12441.1             | 12441.4                 | 50         |
| 22           | 12430.1             | 12430.4                 | 50         | 22           | 12442.1             | 12442.4                 | 50         |
| 23           | 12431.1             | 12431.4                 | 50         | 23           | 12443.1             | 12443.4                 | 50         |
| 24           | 12432.1             | 12432.4                 | 50         | 24           | 12444.1             | 12444.4                 | 50         |

## Accessories

Marking

Page 126 - 129

Page 126 - 129