

Product data sheet

Miniature connectors



Product description **M16 IP40 male panel mount connector, Contacts: 6 DIN, shielding is not possible, solder, IP40**

Area **M16 IP40 series 680**
Order number **09 0323 80 06**

Illustration



Scale drawing

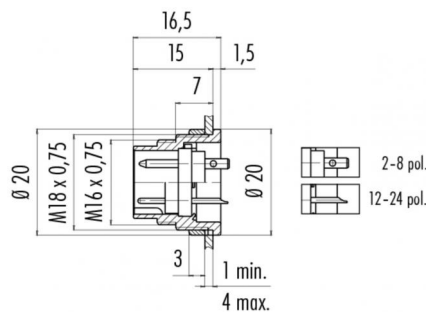

Contact arrangement

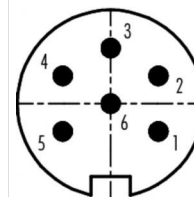

| | X | Y |
|---|-------|-------|
| 1 | 3,03 | -1,75 |
| 2 | 3,03 | 1,75 |
| 3 | 0,00 | 3,50 |
| 4 | -3,03 | 1,75 |
| 5 | -3,03 | -1,75 |
| 6 | 0,00 | 0,00 |

You can find the assembly instructions on the next page.

Technical data

General values

| | |
|--------------------------|----------------------------|
| Connector design | male panel mount connector |
| Connector locking system | screw |
| Termination | solder |
| Wire gauge (mm) | 0.75 mm ² |
| Wire gauge (AWG) | 18 |
| Upper limit temperature | 85 °C |
| Lower limit temperature | -40 °C |
| Customs tariff number | 85369010 |
| Packaging Unit | 20 |

Electrical values

| | |
|---------------------------|---------------------------|
| Rated current (40 °C) | 5 A |
| Rated voltage | 250 V |
| Rated impulse voltage | 1500 V |
| Pollution degree | 1 |
| Overvoltage category | I |
| Insulating material group | III |
| Insulation resistance | ≥ 10 ¹⁰ Ω |
| EMC compliance | shielding is not possible |
| Degree of protection | IP40 |
| Mechanical operation | > 500 Mating cycles |

Material

| | |
|-----------------------|-----------------------------|
| Contact material | CuZn (brass) |
| Contact plating | Ag (silver) |
| Contact body material | PBT (UL94 V-0) |
| Housing material | Zinc die-cast nickel-plated |

Product description **M16 IP40 male panel mount connector, Contacts: 6 DIN, shielding is not possible, solder, IP40**

Area **M16 IP40 series 680**
Order number **09 0323 80 06**

Assembly instructions / Panel cut-out

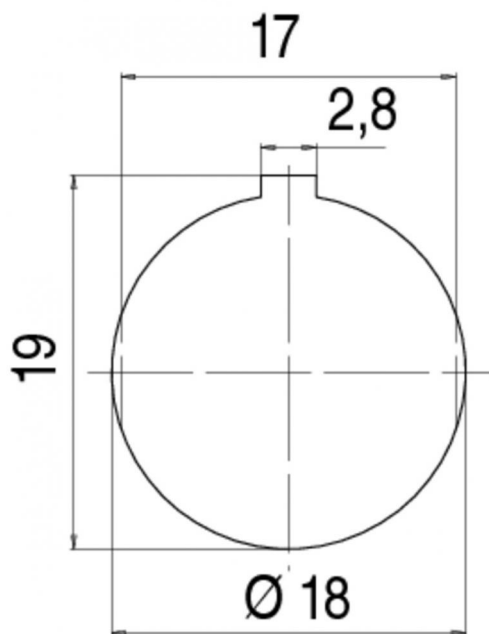

| | |
|---------------------|--|
| Product description | M16 IP40 male panel mount connector, Contacts: 6 DIN, shielding is not possible, solder, IP40 |
| Area | M16 IP40 series 680 |
| Order number | 09 0323 80 06 |

Security notices

The connector must not be connected or separated under load. Non-observance and incorrect use can result in personal injury.

The connectors are designed for use in plant, control system and electrical equipment. The end user is responsible for checking whether the connectors are suitable for use in other applications.

To prevent the connector being opened unintentionally when used in electrical circuits containing hazardous life parts, the thread between the housing and the connector head must be secured using a suitable cyanoacrylate adhesive. This does not apply to connectors used in SELV and PELV circuits according to IEC 61140 (EN 61140, VDE 0140-1).

The connector is not suitable for mains voltages. Please observe the pollution degrees and the overvoltage category. For further information refer to 'Technical support' in the Download Centre.