

03

0317

Circular connectors with threaded joint M16 acc. to IEC 61076-2-106, IP40/IP67/IP68



Chassis plug acc. to IEC 61076-2-106, IP68, with threaded joint, for printed circuit boards, for back side mounting

03 0317

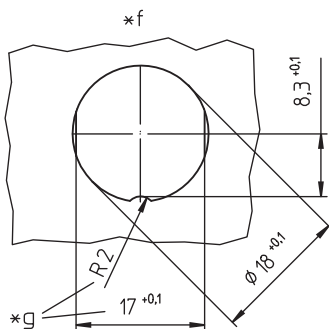
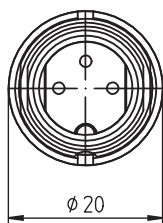
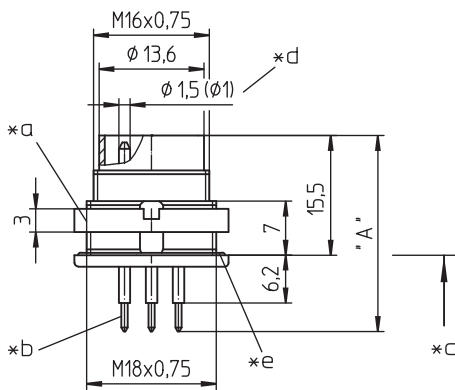
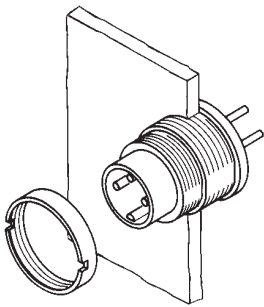

### Environmental conditions

Temperature range -40 °C/+85 °C

### Materials

Insulating body PA GF, V-0 according to UL94  
 Contact pin CuZn, silver-plated and flash gold-plated, tin-plated in solder area (3-8 poles)  
 CuZn, pre-nickel and gold-plated, tin-plated in solder area (12-14 poles)  
 Housing Zn diecast, pre-copper and nickel-plated  
 Ring screw CuZn, nickel-plated  
 Seal NBR

### Mechanical data

Tightening torque connector 1-3 Nm  
 Tightening torque nut 1-3 Nm  
 Protection class IP68<sup>1</sup>

<sup>1</sup> according to IEC DIN EN 60529, only in locked condition with an appropriate counterpart; IPX8 requirements under agreement between manufacturer and user

### Electrical data (at T<sub>amb</sub> 20 °C)

Rated current 5 A (T<sub>amb</sub> 40 °C, 3-8 poles)  
 3 A (T<sub>amb</sub> 40 °C, 12-14 poles)  
 Rated voltage with pollution degree 1:  
 300 V (versions 03, 04, 05-1, 06, 07)  
 100 V (versions 05, 07-1, 08, 08-1)  
 160 V (versions 12, 14)  
 with pollution degree 2:  
 250 V (versions 03, 04)  
 32 V (versions 05, 07-1, 08, 08-1)  
 160 V (versions 05-1, 06, 07, 12, 14)  
 Rated impulse voltage 1500 V (versions 03, 04, 05-1, 06, 07, 12, 14)  
 500 V (versions 05, 07-1, 08, 08-1)  
 Material group II (IEC)/I (UL) (400 ≅ CTI < 600)  
 Overvoltage category I  
 Insulation resistance > 100 MΩ

### Associated products

Counterparts  
 ☞ 0321 ☞ 0322 ☞ 0322-1  
 ☞ 032200 ☞ 0360 ☞ 036000  
 Accessories  
 ☞ 0383 ☞ 038399 ☞ 0384

03

0317

Pin configurations, solder side view

 0385

 038899

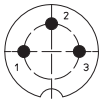

03-a  
0317 03

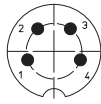

04-a  
0317 04

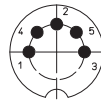

05-b  
0317 05

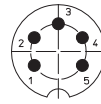

05-a  
0317 05-1

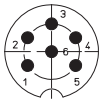

06-a  
0317 06

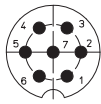

07-a  
0317 07

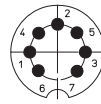

07-b  
0317 07-1

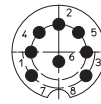

0317 08

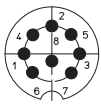

08-a  
0317 08-1

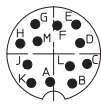

12-a  
0317 12

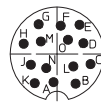

14-a  
0317 14

03 0317

Printed circuit board layout, solder side view

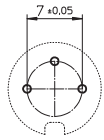

03-a  
0317 03

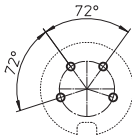

04-a  
0317 04

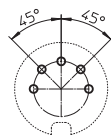

05-b  
0317 05

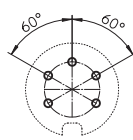

05-a  
0317 05-1

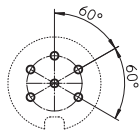

06-a  
0317 06

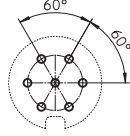

07-a  
0317 07

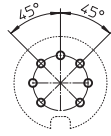

07-b  
0317 07-1

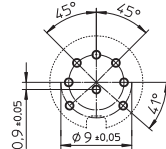

0317 08

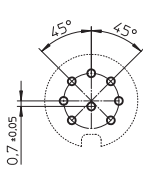

08-a  
0317 08-1

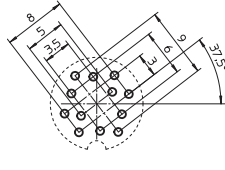

12-a  
0317 12

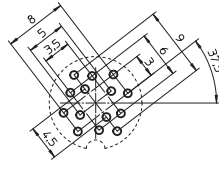

14-a  
0317 14

- \*a nut enclosed separately
- \*b for bore hole of PCB  
Ø 1,0 mm (0317 03–0317 08-1)  
Ø 0,7 mm (0317 12–0317 14)
- \*c mounting direction
- \*d contact pin  
Ø 1.5 mm (0317 03–0317 08-1)  
Ø 1.0 mm (0317 12–0317 14)
- \*e O-ring gasket
- \*f port in mounting plate
- \*g anti-rotation, alternative execution

03

0317

Designation	Pole Number	PU (Pieces)	MDQ (Pieces)	Dimensions A (mm)
0317 03	3	50	100	25.4
0317 04	4	50	100	25.4
0317 05	5	50	100	25.4
0317 05-1	5	50	100	25.4
0317 06	6	50	100	25.4
0317 07	7	50	100	25.4
0317 07-1	7	50	100	25.4
0317 08	8	50	100	25.4
0317 08-1	8	50	100	25.4
0317 12	12	50	100	24.8
0317 14	14	50	100	24.8

**Packaging:**

in a cardboard box