

03

0315

Circular connectors with threaded joint M16 acc. to IEC 61076-2-106, IP40/IP67/IP68



Chassis plug acc. to IEC 61076-2-106, IP 68, with threaded joint and solder terminals, for back side mounting

03 0315

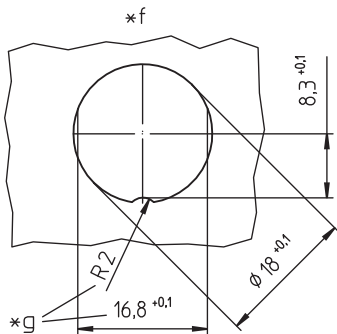
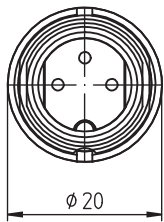
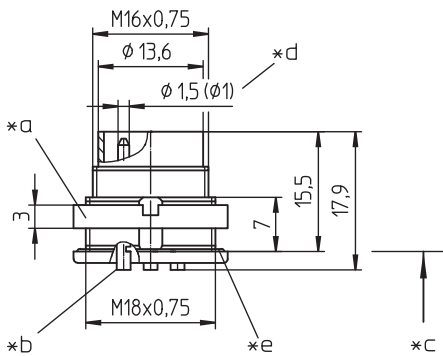
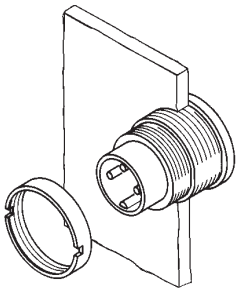

#### Environmental conditions

Temperature range -40 °C/+85 °C

#### Materials

Insulating body	PA GF, V-0 according to UL94
Contact pin	CuZn, silver-plated and flash gold-plated (3-8 poles) CuZn, pre-nickel and gold-plated (12-14 poles)
Housing	Zn diecast, pre-copper and nickel-plated
Ring screw	CuZn, nickel-plated
Seal	NBR

#### Mechanical data

Protection class	IP68 <sup>1</sup>
Further data	depending on pin configuration, see below

<sup>1</sup> according to IEC DIN EN 60529, only in locked condition with an appropriate counterpart; IPX8 requirements under agreement between manufacturer and user

#### Connectable conductors for solder area

Section	$\leq 0,75 \text{ mm}^2$ (AWG 20) (3-8 poles) $\leq 0,25 \text{ mm}^2$ (AWG 24) (12-14 poles)
---------	--

#### Electrical data (at $T_{\text{amb}} 20 \text{ °C}$ )

Rated current	5 A ( $T_{\text{amb}} 40 \text{ °C}$ , 3-8 poles) 3 A ( $T_{\text{amb}} 40 \text{ °C}$ , 12-14 poles)
Rated voltage	with pollution degree 1: 300 V (versions 03, 04, 05-1, 06, 07) 100 V (versions 05, 07-1, 08, 08-1) 160 V (versions 12, 14) with pollution degree 2: 250 V (versions 03, 04) 32 V (versions 05, 07-1, 08, 08-1) 160 V (versions 05-1, 06, 07, 12, 14)
Rated impulse voltage	1500 V (versions 03, 04, 05-1, 06, 07, 12, 14) 500 V (versions 05, 07-1, 08, 08-1)
Material group	II (IEC)/I (UL) (CTI $\geq 550$ )
Overvoltage category	I
Insulation resistance	> 100 M $\Omega$

03

0315

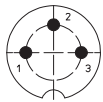

03-a  
0315 03

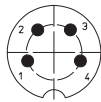

04-a  
0315 04

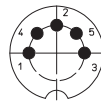

05-b  
0315 05

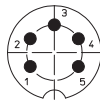

05-a  
0315 05-1

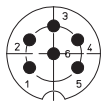

06-a  
0315 06

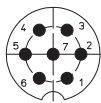

07-a  
0315 07

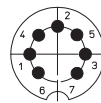

07-b  
0315 07-1

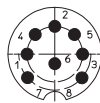

0315 08

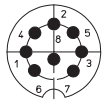

08-a  
0315 08-1

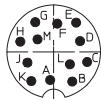

12-a  
0315 12

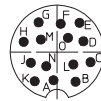

14-a  
0315 14

#### Associated products

##### Counterparts

 0321

 0322

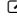
 0322-1

 032200

 0360

 036000

##### Accessories

 0383

 038399

 0384

 0385

 038899

- \*a nut enclosed separately
- \*b cup-shaped solder terminal
- \*c mounting direction
- \*d contact pin  
Ø 1.5 mm (0315 03–0315 08-1)  
Ø 1.0 mm (0315 12–0315 14)
- \*e O-ring gasket
- \*f port in mounting plate
- \*g anti-rotation, alternative execution

03

0315

Designation	Pole Number	PU (Pieces)	MDQ (Pieces)
0315 03	3	50	100
0315 04	4	50	100
0315 05	5	50	100
0315 05-1	5	50	100
0315 06	6	50	100
0315 07	7	50	100
0315 07-1	7	50	100
0315 08	8	50	100
0315 08-1	8	50	100
0315 12	12	50	100
0315 14	14	50	100

**Packaging:**

in a cardboard box